



PISTOL CALIBER SUPPRESSORS

OWNERS MANUAL: HANDLING & SAFETY INSTRUCTIONS



WARNING: READ THIS MANUAL AND THE OPERATOR'S MANUAL FOR THE HOST FIREARM IN THEIR ENTIRETY BEFORE OPERATING THIS SUPPRESSOR. FAILURE TO FOLLOW THE INSTRUCTIONS CONTAINED IN THESE MANUALS MAY RESULT IN DEATH, SERIOUS BODILY INJURY AND OR DAMAGE TO THE SUPPRESSOR AND THE HOST FIREARM.

TABLE OF CONTENTS

1.0 Safety	3
1.1 About Cautions and Warnings.	3
1.2 Safety Procedures for SIG SAUER Rifle Caliber Suppressors	4
1.3 General Firearms Safety Rules and Procedures.	5
2.0 Specifications and Components.	7
2.1 Specifications	7
2.2 Components	7
3.0 Operating	11
3.1 Attaching SIG Pistol Caliber Suppressors	12
3.2 Operating SIG SAUER Pistol Caliber Suppressors	14
4.0 Maintenance.	16
4.1 Disassembly SRD9 / SRD45	16
4.2 Disassembly SRD9-MPX	17
4.3 Cleaning	17
4.4 Reassembly	18
SIG SAUER® Limited Lifetime Warranty	23

1.0 Safety

1.1 About Cautions and Warnings

WARNING

IN THIS MANUAL WARNINGS ARE INSTRUCTIONS OR INFORMATION THAT, IF IGNORED, CAN POTENTIALLY RESULT IN BODILY HARM, DEATH AND OR CATASTROPHIC MALFUNCTION OF THE SUPPRESSOR OR HOST WEAPON. WARNINGS ARE ALWAYS PRINTED IN RED, ALL CAPITALS ON A YELLOW BACKGROUND.

CAUTION

In this manual cautions are instructions or information that, if ignored, can potentially result in damage to the suppressor or host weapon, loss of functionality of the suppressor or host weapon and or lost parts.

1.2 Safety Procedures for SIG SAUER Rifle Caliber Suppressors

WARNING

ALWAYS ENSURE HOST FIREARM IS UNLOADED BY REMOVING THE MAGAZINE, LOCKING THE BOLT OR SLIDE TO THE REAR AND PHYSICALLY AND VISUALLY INSPECTING THE CHAMBER PRIOR TO INSTALLING, TIGHTENING OR REMOVING A SUPPRESSOR. FAILURE TO DO SO MAY RESULT IN DEATH SERIOUS BODILY HARM AND OR DAMAGE TO THE SUPPRESSOR AND HOST WEAPON.

WARNING

DURING ROUTINE OPERATION SUPPRESSORS BECOME HOT ENOUGH TO PRODUCE SEVERE BURNS ON UNPROTECTED SKIN, DAMAGE TO NON HEAT RESISTANT MATERIALS AND MAY IGNITE FLAMMABLE MATERIALS OR LIQUIDS. ALWAYS WEAR HEAT RESISTANT GLOVES OR MITTS WHEN HANDLING SUPPRESSORS AFTER FIRING. DO NOT PLACE A SUPPRESSOR OR HOST WEAPON ON A SURFACE THAT CAN BE DAMAGED OR IGNITED BY HOT METAL AFTER FIRING.

⚠ WARNING

YOUR SIG SUPPRESSOR IS DESIGNED TO REDUCE THE SOUND PRESSURE OF THE CARTRIDGE IT IS INTENDED FOR TO BELOW 140 Db. THIS IS THE OSHA STANDARD FOR "HEARING SAFE" SOUND PRESSURES OF IMPULSE OR IMPACT NOISE. NOISE EXPOSURE STANDARDS FOR A MORE SUSTAINED DURATION BEYOND IMPULSE OR IMPACT LEVELS WILL BE LOWER THAN 140 Db AND THE USE OF ADDITIONAL HEARING PROTECT MAY BE REQUIRED TO MAINTAIN A "HEARING SAFE" LEVEL.

1.3 General Firearms Safety Rules and Procedures

1.3.1 Safety Rules

- a. Treat every weapon as if it were loaded.
- b. Never point a weapon at anything you do not intend to shoot.
- c. Keep your trigger finger out of the trigger guard and off the trigger until you are ready to shoot.
- d. Keep the weapon on safe (if so equipped) until you are ready to shoot.
- e. Be sure of you have identified your intended target and know what lies beyond.

1.3.2 Safety Procedures

- a. Always wear OSHA approved hearing and eye protection when shooting firearms.
- b. When handing a weapon to someone else or prior to accepting a weapon from another person, always physically and visually check the chamber so both people can ensure the weapon is unloaded.
- c. Every SIG SAUER firearm is shipped with a chamber safety flag. The chamber safety flag prevents the chambering of a round when installed and provides a readily visible indication that the weapon's chamber is empty. Regardless of the manufacturer of the host firearm, SIG SAUER recommends using a chamber safety flag when not actually firing the firearm.
- d. Ensure that unauthorized people never have access to a firearm. Never operate or handle a weapon when you are under the influence of alcohol or drugs.
- e. Be aware of the direction that the muzzle of the weapon is pointed at all times while handling or operating the weapon. Never allow the muzzle to be inadvertently pointed at another person.
- f. Always use serviceable, clean ammunition that has been manufactured to the Sporting Arms and Ammunition Manufacturers' Institute (SAAMI) specification of the proper caliber for the weapon. Never oil or otherwise lubricate ammunition. Do not use damaged or dented ammunition.
- g. Always ensure weapons are unloaded prior to storage, maintenance or when otherwise not in use.
- h. Any maintenance or disassembly beyond the user level described in this manual is to be performed by qualified personnel specifically trained on the maintenance of SIG products in accordance with the SIG Sauer technical manual for this suppressor.

2.0 Specifications and Components

2.1 Specifications

Model	SRD9	SRD9-MPX	SRD45
Caliber	9mm Luger	9mm Luger	.45ACP
Length	7.8 in / 198.3 mm	7.1 in / 180.7 mm	8.4 in / 213.7 mm
Diameter	1.38 in / 35.05 mm	1.38 in / 35.05 mm	1.38 in / 35.05 mm
Weight	13.8 oz / 391.5 g	11.9 oz / 338.6 g	14.2 oz / 401.6 g
Mounting Feature	1/2-28 RHT M13.5 x 1.0 LHT	M13.5 x 1.0 LHT	578-28 LHT M16 x 1.0 LHT
Sound Reduction	128 dB (Dry)	125 dB (Dry)	133 dB (Dry)

Note: Environmental conditions may effect sound reduction measurements.

2.2 Components

The internal components of the SIG SAUER pistol caliber suppressors are constructed from stainless steel. The outer tubes are made from Titanium.

2.2.1 SRD9 Components

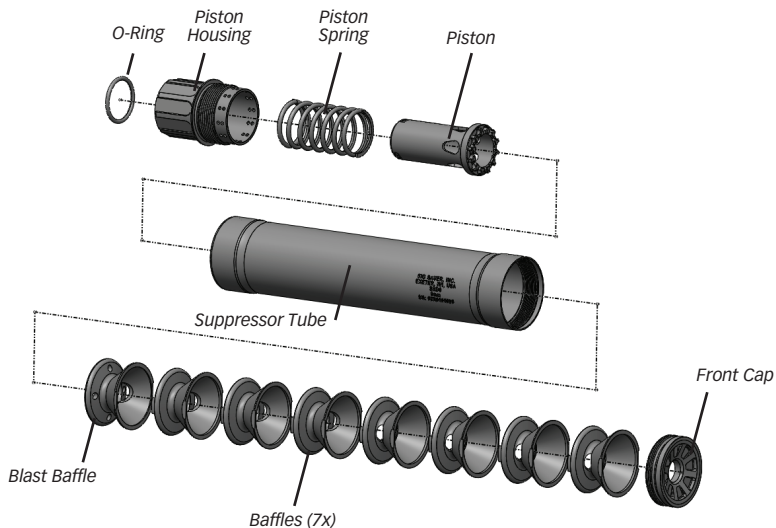

Fig. 2.2a

2.2.2 SRD9-MPX Components

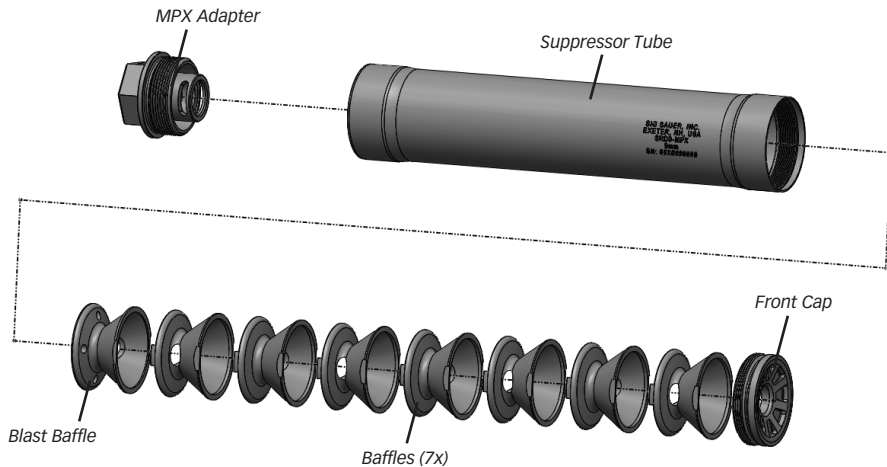

Fig. 2.2b

2.2.3 SRD45 Components

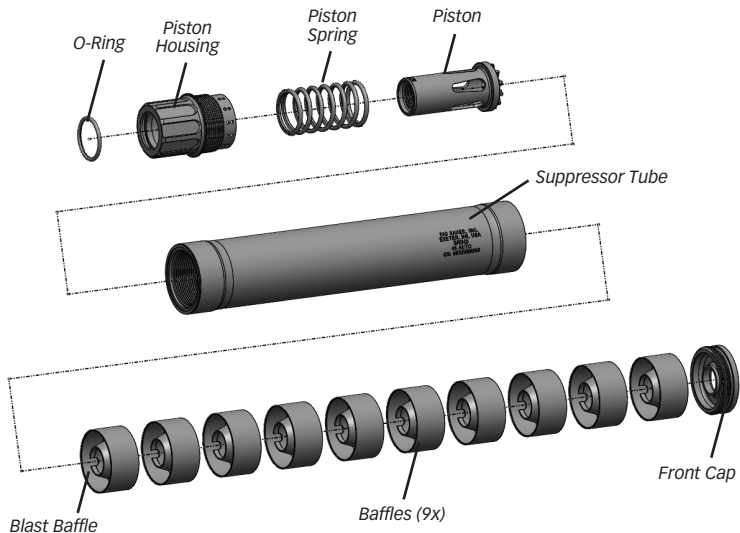

Fig. 2.2c

3.0 Operating

3.1 Attaching SIG Pistol Caliber Suppressors

WARNING

ALWAYS ENSURE HOST FIREARM IS UNLOADED BY REMOVING THE MAGAZINE, LOCKING THE BOLT OR SLIDE TO THE REAR AND PHYSICALLY AND VISUALLY INSPECTING THE CHAMBER PRIOR TO INSTALLING, TIGHTENING OR REMOVING A SUPPRESSOR. FAILURE TO DO SO MAY RESULT IN DEATH, SERIOUS BODILY HARM AND OR DAMAGE TO THE SUPPRESSOR AND HOST WEAPON.

WARNING

DISCHARGING A FIREARM WITH AN IMPROPERLY INSTALLED SUPPRESSOR CAN RESULT IN SERIOUS INJURY AND OR DAMAGE TO THE SUPPRESSOR AND OR HOST WEAPON.

CAUTION

SIG SAUER pistol caliber suppressors have several variations of thread size, pitch and direction (left or right hand threaded). It is the responsibility of the user to ensure that the correct piston or adapter is installed in your suppressor to match the host weapon. Attempting to thread the wrong size or pitch piston or adapter onto the host weapon or attempting to tighten the suppressor in the wrong direction can result in damage to the suppressor and or the host weapon.

3.1 Attaching SIG Pistol Caliber Suppressors (cont.)

THREAD TYPES FOR ATTACHING SIG PISTOL CALIBER SUPPRESSORS	
SRD9	M13.5X1 LEFT HAND THREAD or 1/2-28 RIGHT HAND THREAD
SRD9-MPX	M13.5X1 LEFT HAND ONLY
SRD45	M16X1 LEFT HAND or .578-28 LEFT HAND THREAD

3.1.1 After ensuring the host weapon is unloaded, follow the steps to attach your SIG SAUER suppressor.

- Ensure that the proper piston or adapter is installed to match the threads on the muzzle of the host firearm. If the piston needs to be switched to match the threads on the host firearm see chapter 4, sections 1 and 3 (Maintenance, Disassembly and Reassembly).
- Being careful to avoid cross threading the parts, place the opening of the piston on the muzzle of the host firearm and screw the suppressor on firmly hand tight (see Fig. 3.1).

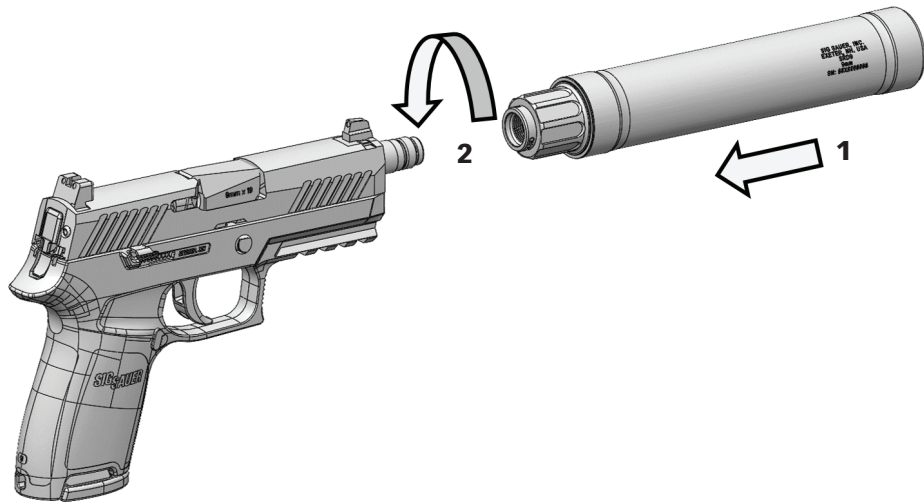

Fig. 3.1

3.2 Operating SIG SAUER Pistol Caliber Suppressors

WARNING

WHEN FIRING SUPPRESSED FIREARMS, FOLLOW ALL NORMAL SAFETY RULES AND PRACTICES APPLYING TO UNSUPPRESSED FIREARMS. FAILURE TO DO SO CAN RESULT IS DEATH, SERIOUS INJURY, AND DAMAGE TO THE SUPPRESSOR AND OR HOST FIREARM.

WARNING

DO NOT FIRE NON-JACKETED, PRE-FRAGMENTED, AND MULTI-PROJECTILE OR SHOT CARTRIDGES THROUGH SIG CENTERFIRE PISTOL OR RIFLE SUPPRESSORS. FIRING ANYTHING BUT JACKETED PROJECTILES MANUFACTURED TO SAAMI SPECIFICATION THRU CENTERFIRE SUPPRESSORS MAY RESULT IN A FRAGMENT HAZARD AND OR DAMAGE TO THE SUPPRESSOR AND OR HOST FIREARM.

WARNING

DO NOT CONTINUE TO FIRE AMMUNITION THRU AN OVERHEATED SUPPRESSOR. THIS CAN RESULT IN FAILURE OF THE SUPPRESSOR ACCOMPANIED BY FRAGMENT AND HOT GAS HAZARDS. SERIOUS INJURY AND OR DAMAGE TO THE SUPPRESSOR AND HOST WEAPON CAN OCCUR.

⚠ CAUTION

Subsonic ammunition projectiles generally requires a faster rifling twist rate to stabilize than comparable supersonic projectiles. Prior to firing subsonic ammunition consult the ammunition manufacturer's recommended twist rate and ensure your host firearm conforms to their recommendation. Firing ammunition through a suppressed weapon with an insufficient twist rate may result in damage to your suppressor

- a. SIG SAUER recommends firing jacketed, subsonic ammunition thru your suppressor. The service life of your suppressor is directly related to the firing schedule it is subjected to. Overheating the suppressor will shorten its service life and in extreme cases may result in immediate damage to your suppressor. Firing supersonic ammunition thru the suppressor will accelerate the rate of heat buildup compared to subsonic ammunition. Discoloration of the suppressor tube is an indication of excessive heat buildup.
- b. Check periodically during use to ensure the suppressor remains securely threaded to the host firearm (refer to section 1.2)

4.0 Maintenance

4.1 Disassembly SRD9 / SRD45

- a. Unscrew the piston housing from the rear of the suppressor.
- b. Remove the piston and piston spring and separate
- c. Using the polymer tool provided, remove the front cap from the suppressor (see Fig 4.1).
- d. Tilt the front end of the suppressor tube down and slide out the baffles.

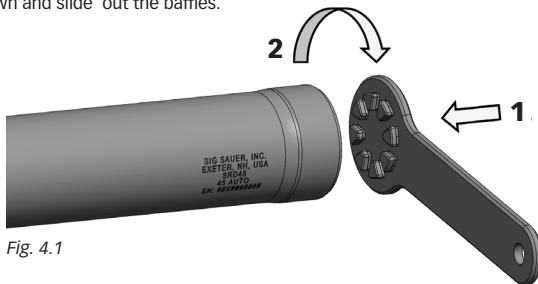

Fig. 4.1

Note: the SRD9 utilizes a blast baffle and (7) seven regular baffles. The SRD45 utilizes (10) ten identical baffles and no blast baffle.

4.2 Disassembly SRD9-MPX

a. The SRD9-MPX disassembly is identical to the SRD9 except that the piston housing is replaced by the MPX Adapter and there is no piston or piston spring.

4.3 Cleaning

Use the following steps to clean your SIG Pistol Caliber Suppressor. The recommended cleaning interval is every 1000 rounds.

CAUTION

Do not use sand paper, emery cloth or similar abrasives on any part when cleaning sig suppressors.

a. SIG SAUER Pistol Caliber Suppressors may be cleaned with solvent approved for firearms use, cleaning brushes with nylon bristles, and Scotch-Brite™ cleaning pads.

b. Scrub components with solvent and either a nylon brush or Scotch-Brite™ cleaning pads to remove the carbon and other firing residue from all surfaces.

4.4 Reassembly

- a. Ensure all components are clean, dry and free from oil or cleaning solvents prior to reassembly. The only exception to this step is the O-ring in the piston housing of SRD9 and SRD45 suppressors. This part should be lightly lubricated with TW-25b™ grease every 100-200 rounds. The SRD9-MPX adapter does not have an O-ring.
- b. Reassembly of SIG Pistol Caliber Suppressors is accomplished in the reverse order of disassembly. Ensure baffles are stacked in the same order and direction they came out of the tube. SRD9 and SRD9-MPX have one blast baffle and seven baffles. Blast baffles are identified by four radial holes while regular baffles have do not have the four radial holes. Both blast baffles and regular baffles have an offset hole next to the center hole (see Fig 4.4a). For the SRD9 the first three regular baffles are oriented with the offset holes aligned with the offset hole of the blast baffle. The next four baffles are all oriented with the offset holes opposite of the offset hole of the blast baffle (see Fig 4.4b). For the SRD9-MPX the first regular baffle is installed with the offset hole opposite of the blast baffle and the rest of the baffles alternating sides (see Fig 4.4c). The SRD45 has no blast baffle. All ten baffles are the same and have no alignment tabs or notches. The SRD45 baffles need to be reinstalled in the same direction they came out of the suppressor tube but have no radial orientation (see Fig 4.4d).

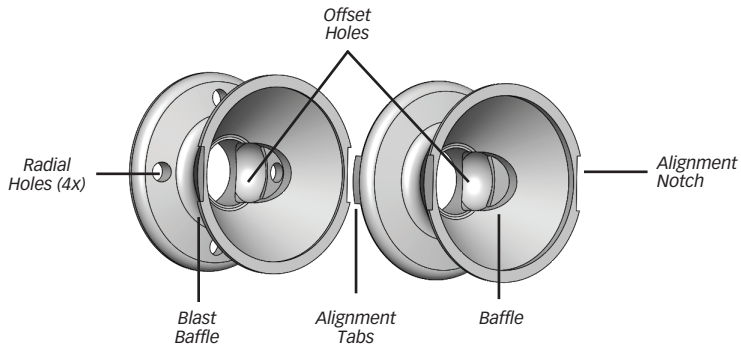

Fig 4.4a

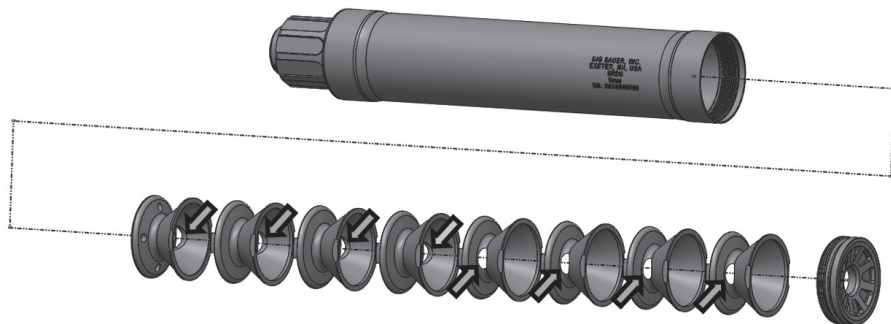

Fig 4.4b

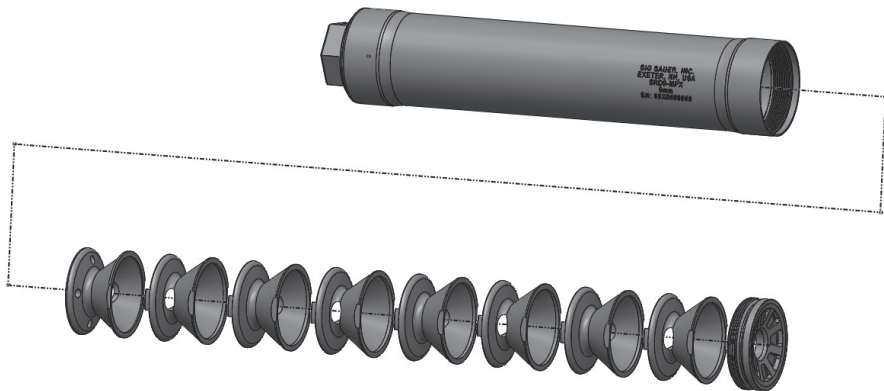

Fig 4.4c

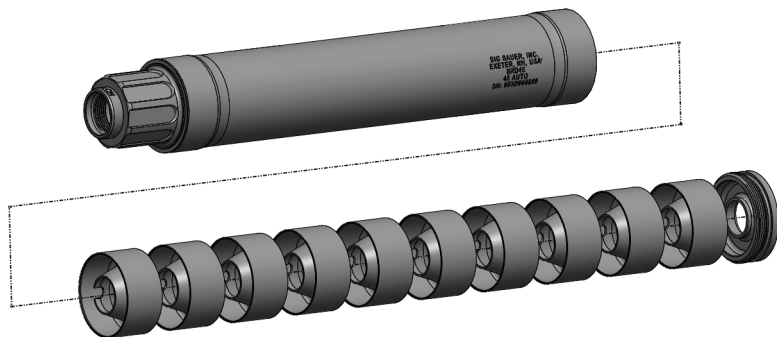

Fig 4.4d

SIG SAUER® Limited Lifetime Warranty

SIG SAUER® warrants that the enclosed suppressor was originally manufactured free of defects in material, workmanship, and mechanical function. For the lifetime of the original purchaser, SIG SAUER agrees to correct any defect in the suppressor for the original purchaser by repair or adjustment, at SIG SAUER's option, with the same or comparable quality components; provided, however, that the suppressor is returned with a copy of the original purchaser's tax stamp (Stamped form 4 from the BATFE) and freight paid to:

**SIG SAUER
18 Industrial Drive
Exeter, NH 03833**

This limited warranty is null and void if the suppressor has been misused, damaged (by accident or otherwise), improperly mounted to the host firearm, fired with hand loaded, reloaded or improper ammunition, fired with an obstruction in the barrel, damaged through failure to provide reasonable and necessary maintenance as described in the manual accompanying the suppressor, or if unauthorized repair or any alteration, including of a cosmetic nature, has been performed to the suppressor. This limited warranty does not apply to normal wear and tear of any parts. Subject to the foregoing, this limited warranty confers the right to have the covered suppressor or its parts repaired or adjusted exclusively upon the original purchaser, which right is not transferable to any other person. No implied warranties of any kind are made herein and this warranty does not apply to any accessory items attached or appurtenant to the firearm. In no event shall SIG SAUER be liable for any incidental or consequential damages arising from or in connection with this limited warranty.



**FOR PRODUCT SERVICE ON THIS MODEL,
PLEASE CALL (603) 610-3000 EXT. 1**

72 Pease Boulevard, Newington, NH 03801 USA