



SIG SAUER

ROMEO®

ROMEOZero™ MICRO OPEN REFLEX SIGHT, AUTO-OFF

OWNERS MANUAL

Please visit sigsauger.com for Owners Manual downloads.

INTRODUCTION:

The ROMEOZero™ is a fast, accurate, ultra-compact micro reflex sight that has been optimized for everyday concealed carry and for pistols with slim slide profiles. The sight features a ruggedized, WeaponsGrade™ textured polymer body and the SpectraCoat™ HD aspherical glass lens system. The ROMEOZero enables rapid target acquisition in an everyday carry package at an iron sight price.

The ROMEOZero™ is covered by the SIG SAUER Electro-Optics Infinite Guarantee and Electronics & Tritium Component Limited 5-Year Warranty.

KEY FEATURES:

- 3 MOA Red Dot Reticle
- SpectraCoat™ HD aspherical glass lens
- WeaponsGrade™ ultralight polymer housing
- 8 user-selectable brightness levels
- User-selectable 16-hour automatic reticle shutoff (AUTO-OFF) or constant-on modes
- Integrated backup rear sight for co-witnessing with your front iron sight
- Pre-zeroed from the factory, optimized for most optics-ready pistols
- Compatibility with SIG Sauer P365 Optics-Ready pistols, as well as many other popular pistols on the market
- Highly efficient point source LED emitter, for up to 20,000 hours of runtime from a common CR1632 coin cell battery
- Low battery indication

CONTENTS:

- ROMEOZero™ Micro Open Reflex Sight
- (2) M3 X 0.5 Screws
- 2mm Allen Wrench (Mounting)
- (2) M4 X 0.7 Screws
- .050" Allen Wrench (Windage/Elevation Adjustment)
- Die Cut Chemical Shield Decal
- CR1632 Battery
- Owner's Manual

PRODUCT IDENTIFICATION:

A: Windage Adjustment Screw
B: Elevation Adjustment Screw

C: Mount Screw Holes
D: Brightness Adjustment Button

E: Battery Slot

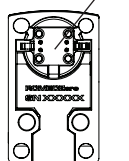
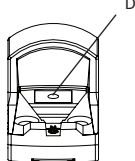
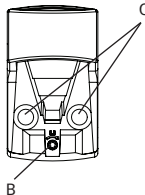
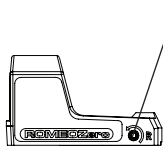

INSTALLATION:

IMPORTANT: Prior to installation, battery change, cleaning or maintenance, ensure that the firearm is unloaded with the safety on and pointed in a safe direction.

⚠ WARNING: Do not remove the plastic seal decal underneath the optic that contains the serial number. Doing so may damage the product.

The ROMEOZero comes with 2 sets of screws (Fig 1). The M3 X 0.5 screws are meant for mounting the ROMEOZero to any Optics-Ready SIG SAUER P365 or P322 pistol. The M4 X 0.7 screws are included for installation on certain non-SIG pistols and accessory mounts that have been cut for other optics. The included screws may or may not be compatible with those other products, and you should consult the product manufacturer for compatibility information. For mounting to GLOCK® MOS pistols and adapter plates, or SPRINGFIELD HELLCAT®, you need SIG SAUER mounting kit SOR0SK002. Additional screws are available through SIG SAUER Customer Service.

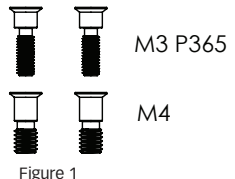

MOUNTING TO AN OPTICS-READY SIG P365 OR P322 PISTOL:

Remove the Sight Plate from your P365 or P322 Optics-Ready pistol (consult the firearm operator's manual). Use a clean cloth to wipe any excess oil or solvent from the optics cut area of the pistol slide. Peel the included die cut chemical shield decal from its backing, and apply it carefully to the pistol slide optics cut area. This shield prevents solvents and hot gas from coming through the hole in the pistol slide and damaging the optic. Ensure that a new CR1632 coin cell battery is installed in the ROMEOZero, with the positive (+) side facing out. Hold the battery in place with a finger or thumb while lowering the ROMEOZero into the optics cut of the pistol slide. If using the steel protective shroud (available separately), place the ROMEOZero (with battery installed) into the shroud before lowering it onto the pistol slide (Fig 2). Ensure that the raised threaded slots in the pistol slide line up with the mount screw holes of the ROMEOZero. Using the included 2mm Allen wrench, insert the M3 X 0.5 screws through the ROMEOZero mount holes and thread them into the raised threaded slots of the pistol slide, until the screw heads make firm contact with the ROMEOZero housing. Turn the screws an additional ¾ of a turn, clockwise. For best results, use an inch-pound torque wrench set to 9 in-lbs. NOTE – You should retorquer the mount screws to 9 in-lbs. each time you remove the sight from the firearm.

⚠ WARNING! Over-torquing the mounting screws may cause issues with the windage and elevation adjustments. Use an inch-pound torque wrench set to 9 in-lbs for best results when mounting the ROMEOZero.

OPERATION:

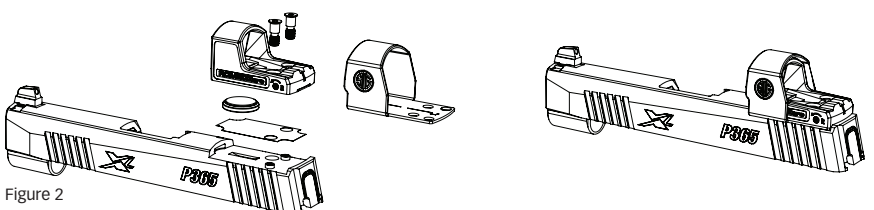

INSTALLING AND CHANGING THE BATTERY: The ROMEOZero must be removed from the firearm to access the battery. The CR1632 coin cell battery is installed from underneath the sight. Insert the battery into the round battery slot with the positive (+) side facing out, toward the pistol slide, and temporarily hold it in place using a thumb or finger until you're ready to mount the sight onto the firearm.

TURNING THE SIGHT ON/OFF, ADJUSTING RETICLE BRIGHTNESS, AND CHANGING MODES: There are a total of 8 brightness levels on the ROMEOZero. The brightness adjustment button is located just behind the lens. To turn the sight on, use the tip of a finger to press and hold the brightness adjustment button for 2 seconds. To turn the sight off, press and hold the brightness adjustment button again for 2 seconds. To adjust the brightness of the dot, press and release the button to raise the dot brightness 1 level. Continue to press and release the button until the desired brightness level is reached. Once the dot reaches the brightest level, it will blink multiple times. Subsequent button presses will lower the dot brightness 1 level at a time until the lowest brightness level is reached. The dot will blink multiple times and subsequent button presses will begin raising the dot brightness again. NOTE – Care should be taken not to touch or scratch the rear surface of the lens while accessing the brightness adjustment button.

MODE CHANGE: This model of ROMEOZero has 2 available modes - AUTO-OFF and CONSTANT-ON. To switch between modes or to check which mode the optic is in, from ON: press and hold the brightness adjustment button for 3 seconds. The reticle will first turn off briefly, then come back on and begin blinking. A slow blink indicates AUTO-OFF mode, and a faster blink indicates CONSTANT-ON mode. A single press of the button while the reticle is blinking will switch between modes. After 10 seconds without a button press, the mode that is being displayed will be locked in and the reticle will stop blinking. This setting will be saved even if the optic is turned off or the battery is removed.

AUTO-OFF: This model of ROMEOZero utilizes an auto-off feature. Once the optic has been on constantly for 16 hours, the reticle will automatically shut off to conserve battery life. The optic must be turned back on manually using the button behind the lens.

CONSTANT-ON: Once the reticle is turned on, it will remain on constantly until the user manually turns the optic off. The optic must be turned back on manually using the button behind the lens. **WARNING:** CONSTANT-ON mode will severely reduce battery life if the optic is left in the ON state, especially at high brightness levels.

LOW BATTERY WARNING: Upon turning the optic ON from the OFF state, if the battery has approximately 24 hours or less of life left, the reticle will indicate this by slowly fluctuating from dim to bright back to dim repeatedly for approximately 7 seconds. The battery should be replaced with a fresh CR1632 battery as soon as possible.

WINDAGE AND ELEVATION ADJUSTMENT:

NOTE – The illuminated dot of the ROMEOZero has been adjusted to mechanical center at the factory. Therefore, the optic will be very close to zeroed when installed, and should only require minor adjustment to bring point of aim and point of impact together.

ADJUSTING ELEVATION: To raise your point of impact, use the included .050” Allen wrench to turn the elevation screw clockwise. To lower your point of impact, turn the adjustment screw counter-clockwise.

ADJUSTING WINDAGE: To move your point of impact left, use the included .050” Allen wrench to turn the windage screw clockwise. To move your point of impact right, turn the adjustment screw counter-clockwise.

⚠ WARNING! Do not adjust the windage or elevation adjustments while the optic is removed from the pistol or mount surface. Doing so may cause damage to the optic. Never force the adjustment screws beyond their limits of travel.

CLEANING & MAINTENANCE:

After repeated fire, the lens may become clouded with gunpowder residue. For best results, it is recommended that the outer surface of the lens (the side closest to the muzzle) be cleaned, along with the firearm, after each use. To clean the lens, follow these steps:

- 1. Keep firearm pointed in a safe direction
- 2. Ensure firearm is unloaded
- 3. Dampen the end of a cotton swab with isopropyl alcohol
- 4. Apply dampened swab to lens and polish in a small circular pattern, beginning in the center and moving out to the edges.

If the ROMEOZero is mounted on a pistol that gets carried inside or underneath clothing on a regular basis, it is possible to collect clothing fibers or lint in the emitter area, causing a temporary loss or change in appearance of the red dot. With the firearm unloaded with the safety on and pointed in a safe direction, use compressed air to blow out the emitter area on the ROMEOZero, located on top of the sight, between the mount screw holes.

The ROMEOZero™ should never be submerged or flushed with cleaning solvents.

TROUBLESHOOTING:

POINT OF IMPACT CHANGES BETWEEN GROUPS, WHILE SHOOTING FROM A SET DISTANCE:

- Check that the mounting screws are torqued to 9 in-lbs.
- Check for variations in your ammunition
- Check/clean your firearm

SIGHT WILL NOT TURN ON:

- Install a fresh CR1632 coin cell battery. Press and hold the brightness adjustment button for at least 2 seconds. It is also possible that the sight is on but set at a low brightness setting. Move to a dark room to see if the illuminated dot is turned down to a low setting, and use the brightness adjustment button to raise the dot brightness.

RED DOT SUDDENLY CHANGES SHAPE OR BECOMES BLURRY:

- Use compressed air to blow out the emitter area, located on top of the sight, between the two mount screw holes

ROMEOZero SPECIFICATIONS	
Sight Window	.72 in x .61 in / 18.3 mm x 16.4 mm
Battery	CR1632
Overall Windage Adjustment	50 MOA
Overall Elevation Adjustment	50 MOA
Brightness Settings	8 Daytime Settings
Battery Life	Up to 20,000 hours
Weight	0.4 oz / 14 grams



⚠ WARNING: CANCER AND REPRODUCTIVE HARM – www.P65Warnings.ca.gov

⚠ WARNING

- **INGESTION HAZARD:** This product contains a button cell or coin battery.
- **DEATH** or serious injury can occur if ingested.
- A swallowed button cell or coin battery can cause **Internal Chemical Burns** in as little as **2 hours**.
- **KEEP** new and used batteries **OUT OF REACH OF CHILDREN**.
- **Seek immediate medical attention** if a battery is suspected to be swallowed or inserted inside any part of the body.

SIG SAUER® ELECTRO-OPTICS INFINITE GUARANTEE® / LIMITED LIFETIME WARRANTY

SIG SAUER has manufactured the most rugged, dependable, high-performance firearms for more than two centuries. Our heritage of design, engineering, and precision-manufactured quality predates the existence of any other optics company worldwide. We understand the importance of quality in the line of fire, at the shooting range or on your next hunt. SIG SAUER Electro-Optics had to earn the right to wear that badge and the Infinite Guarantee has your back, forever. Period.

We will repair or replace your SIG SAUER product in the event it becomes damaged or defective, at no charge to you. If we cannot repair your product, we will replace it with a product in perfect working order of equal or better physical condition.

SIG SAUER INFINITE GUARANTEE®

- Unlimited Lifetime Guarantee
- Fully Transferable
- No Warranty Card Required
- No Receipt Required
- No Time Limit Applies
- No Charge

Please note that our Infinite Guarantee excludes coverage for intentional damage, misuse, cosmetic damage that does not affect the performance of the optic, loss, theft, or unauthorized repair or modification. Excludes electronic and Tritium components.

Customers seeking warranty coverage must first obtain a Return Merchandise Authorization (RMA) by contacting SIG SAUER Customer Service, and return the product unloaded and freight prepaid.

ANY WARRANTIES IMPLIED BY LAW, INCLUDING ANY IMPLIED WARRANTIES OF MERCHANTABILITY OR FITNESS FOR A PARTICULAR PURPOSE, ARE EXPRESSLY DISCLAIMED. REPAIR, ALTERATION, OR REPLACEMENT AS PROVIDED HEREIN IS YOUR EXCLUSIVE REMEDY FOR ANY DEFECTIVE PRODUCT. IN NO EVENT SHALL SIG SAUER OR ANY COMPANY AFFILIATED WITH SIG SAUER BE LIABLE FOR ANY SPECIAL, INCIDENTAL, OR CONSEQUENTIAL DAMAGES OF ANY KIND ARISING OUT OF THE PURCHASE OR USE OF THIS PRODUCT, WHETHER BASED UPON CONTRACT, TORT, STATUTE, OR OTHERWISE. Some states do not allow the exclusion or limitation of implied warranties, or the exclusion or limitation of incidental or consequential damages, so some or all of the above limitations or exclusions may not apply to you. This warranty gives you specific legal rights, and you may also have other rights which vary from State to State.

THIS WARRANTY APPLIES TO COMMERCIAL CUSTOMERS ONLY, AND DOES NOT APPLY TO GOVERNMENT, MILITARY, LAW ENFORCEMENT, OR NON-US CUSTOMERS. NON-US COMMERCIAL CUSTOMERS MUST PURCHASE PRODUCT THROUGH AN AUTHORIZED SIG SAUER DEALER WITHIN THEIR COUNTRY OF RESIDENCE FOR THIS WARRANTY TO APPLY.

SIG SAUER ELECTRONIC COMPONENT LIMITED 5-YEAR WARRANTY

SIG SAUER warrants that the electronic and tritium components of the enclosed product were originally manufactured free of defects in workmanship, material, and mechanical function. For a period of five (5) years from the date of manufacture, SIG SAUER agrees to correct any defect in these components by repair, adjustment, or replacement, at SIG SAUER's option, with the same or comparable quality components (or by replacing the product at SIG SAUER's option); provided however that a Return Merchandise Authorization (RMA) is first obtained by contacting SIG SAUER Customer Service, and that the product is returned unloaded and freight prepaid.

This limited warranty is null and void if the product has been misused, damaged (by accident or otherwise), damaged through failure to provide reasonable and necessary maintenance as described in the user's manual, or if unauthorized repair or any alteration, including of a cosmetic nature, has been performed on the product. This limited warranty does not apply to normal cosmetic wear and tear of any parts.

ANY WARRANTIES IMPLIED BY LAW, INCLUDING ANY IMPLIED WARRANTIES OF MERCHANTABILITY OR FITNESS FOR A PARTICULAR PURPOSE, ARE EXPRESSLY DISCLAIMED. REPAIR, ALTERATION, OR REPLACEMENT AS PROVIDED HEREIN IS YOUR EXCLUSIVE REMEDY FOR ANY DEFECTIVE PRODUCT. IN NO EVENT SHALL SIG SAUER OR ANY COMPANY AFFILIATED WITH SIG SAUER BE LIABLE FOR ANY SPECIAL, INCIDENTAL, OR CONSEQUENTIAL DAMAGES OF ANY KIND ARISING OUT OF THE PURCHASE OR USE OF THIS PRODUCT, WHETHER BASED UPON CONTRACT, TORT, STATUTE, OR OTHERWISE. Some states do not allow the exclusion or limitation of implied warranties, or the exclusion or limitation of incidental or consequential damages, so some or all of the above limitations or exclusions may not apply to you. This warranty gives you specific legal rights, and you may also have other rights which vary from State to State.

THIS WARRANTY APPLIES TO COMMERCIAL CUSTOMERS ONLY, AND DOES NOT APPLY TO GOVERNMENT, MILITARY, LAW ENFORCEMENT, OR NON-US CUSTOMERS. NON-US COMMERCIAL CUSTOMERS MUST PURCHASE PRODUCT THROUGH AN AUTHORIZED SIG SAUER DEALER WITHIN THEIR COUNTRY OF RESIDENCE FOR THIS WARRANTY TO APPLY.

FOR PRODUCT SERVICE ON THIS MODEL, PLEASE CALL 603-610-3000
12100 SW Tualatin Rd, Tualatin, OR 97062

FOLD LINES DO NOT PRINT - FINISHED SIZE 2.5" X 4"

