



COOLFIRE

TRAINER

USER MANUAL

Barrels, CO₂ Fill Options
& Lasers for

SIG SAUER PISTOLS

Table of Contents

1	Introduction	
	Safety Notices.....	3
	Included Items & Items Available Separately	4
	Warranty	5
2	Barrels	
	Installation & Operation	7
3	CO₂ Fill Options	
	Installation & Operation	11
4	Lasers & Capacity Extenders	
	Laser Information	13
	Installation Instructions	14
	Laser Adjustment	16
5	Maintenance	
	CO ₂ Storage.....	18
	O-Ring Replacement	19
	Fill Nose Gasket Replacement	20
	Striker Inspection & Wear	22
6	Troubleshooting	
	Charging/Weak Recoil	24
	Low Shot Count / Weak Recoil	26
	CO ₂ Leaking from the Barrel	27
	Inconsistent Laser	28

Safety Notices

- **Always** use safe gun handling practices.
- **Never** point the CoolFire Trainer Barrel or laser at anyone.
- **Never** use the CoolFire Trainer Barrel or laser with anything other than CO₂.

COOLFIRE TRAINER IS ENGINEERED TO USE CO₂ ONLY.

Before returning your handgun to normal operating condition, **ALWAYS** ensure CO₂ has been purged from the barrel. **While wearing eye protection**, purge by inserting the 0.050 inch = 1.5 mm Allen Wrench into the Fill Tip.



We recommend safety glasses for all participants.

European Union (EU) Information

This product is manufactured in compliance with European Union (EU) directives and carries the CE mark. The following information is provided to comply with EU documentation requirements. Note: Products with CE marks perform their required functions safely and adhere to relevant standards as specified by EU directives provided they are used according to their intended purpose and that the applicable instructions are adhered to. The protection provided by equipment may be impaired if this equipment is used in a manner not specified in this manual. Only replacement parts supplied by CoolFire Trainer or its agents should be used for this equipment. A listing of international CoolFire Trainer partners is available on our Web site: <http://www.CoolFireTrainer.com>.

SELV Circuits

All electrical circuits connected to the communications port receptacle and the firing pin sensor receptacle are rated as Safety Extra Low Voltage (SELV).

Environmental Specifications

Operating temperature: 0 °C to 40 °C; 32 °F to 104 °F.

Operating humidity: 90% (non-condensing).

Storage temperature: -10 °C to 60 °C; 14 °F to 140 °F.

Air Composition: No corrosive gases permitted.



FCC Compliance

This device complies with Part 15 of the FCC rules. Operation is subject to the following conditions: (1) this device may not cause harmful interference, and (2) this device must accept (tolerate) any interference received, including interference that may cause undesired operation.

Items Included with a Basic Barrel Purchase?



- CoolFire Trainer Barrel of your choice



- Recoil Spring Assembly / Recoil Spring



- 0.050inch = 1.5 mm Allen Wrench



- Gasket Grease



- Tap Rack Training Aids (9mm/.40 or .45)



- Striker Tips (various colors)

Additional Items Available for Purchase Separately



- CO₂ Fill Device



- Lasers and Muzzle Devices



- Gaskets



- O-Rings



- Reflective Targets



- CO₂ Tanks

Note - Images are not to scale.

Warranty

CoolFire Trainer manufactured products have a one-year, limited warranty beginning on the date of delivery.

Barrels

CoolFire Trainer Barrel Installation & Operation

- 1. Verify the chamber is clear in your handgun.
- 2. Remove any ammunition and ensure the magazine is empty. Store any ammunition or removed parts to prevent loss or damage.
- 3. Follow the firearm manufacturer's instructions on removing the slide, barrel, and recoil spring assembly. (Fig. 1)



Fig. 1

4. Wedge adjustment for hammer-fired SIG Sauer Pistols only, including P220, P226, P228, P229, etc. Skip this step if you have a striker-fired pistol.

Due to inherent frame variability on some of these handguns, CoolFire Trainer Barrels for these models include an **Adjustable Wedge** that allows the Barrel to be fitted to the frame to minimize slack.

The CoolFire Trainer Barrel must be fitted to the frame before use. Use the supplied Allen Wrench to adjust the Wedge in the Barrel Block. (Fig. 2 and 3)

To verify proper fit, lock the CoolFire Trainer Barrel into the pistol. (Fig. 4) There should be minimal vertical movement of the muzzle, and minimal front and back movement of the block, as indicated by the horizontal arrows.

You should only need to use your fingertips when rotating the takedown latch into the lock position. (Fig. 5)

After adjustment, rack the slide slowly to verify fit. Repeat until satisfactory.



Fig. 2



Fig. 3

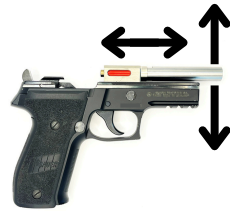

Fig. 4



Fig. 5

...Continued: CoolFire Trainer Barrel Installation & Operation

5. Insert the CoolFire Trainer Barrel into your slide. (Fig. 6)

WARNING: DO NOT INSTALL THE RECOIL SPRING ASSEMBLY BACKWARD. IT MAY DAMAGE THE COOLFIRE TRAINER BARREL AND/OR FIREARM.



Fig. 6

6. Additional steps for installing the CoolFire Trainer Barrel Extension into compensated XMacro Comp model:

a) Leaving the Barrel Extension to the side, Insert the Barrel into the slide. (Fig. 7)



Fig. 7

b) For optimal service life of the O-ring seal, apply a little bit of the provided air tool Grease. (Fig. 8)



Fig. 8

WARNING: DO NOT USE GUN OIL - IT DEGRADES RUBBER.

c) When the Barrel is installed in the slide, screw in the Barrel Extension with your fingers only. (Fig. 9)



Fig. 9

d) Use a wrench only if needed to remove the Barrel Extension after use. (Fig. 10)



Fig. 10

8. For SIG Sauer P320 variants only, including X5, Full Size, Carry Size, or Compact Size. Skip this step if you have a different pistol.

To install the CoolFire Trainer Barrel into SIG Sauer P320 variants, the takedown lever must be vertical. (Fig. 11)



Fig. 11

...Continued: CoolFire Trainer Barrel Installation & Operation

9. Insert the CoolFire Trainer Barrel into your slide. (Fig. 12)

WARNING: DO NOT INSTALL THE RECOIL SPRING ASSEMBLY BACKWARD. IT MAY DAMAGE THE COOLFIRE TRAINER BARREL AND/OR FIREARM.

10. Install the CoolFire Trainer Recoil Spring on the factory guide rod, or use the supplied Recoil Spring Assembly ensuring the flat end touches the Barrel. (Fig. 13)

RECOMMENDED: DO NOT USE THE STOCK RECOIL SPRING WITH THE COOLFIRE TRAINER BARREL AS IT MAY NOT FUNCTION PROPERLY!

11. Reinstall the slide onto your pistol. (Fig. 14) If the slide will not lock into the frame with the CoolFire Trainer Barrel installed, push on the tip of the CoolFire Trainer Barrel. (Fig. 15)

12. If using your magazine during training, you can install the Tap Rack Training Aids into your magazine as shown. (Fig. 16)

13. Insert the magazine and cycle the slide to ensure it does not lock back



Fig. 12



Fig. 13



Fig. 14



Fig. 15

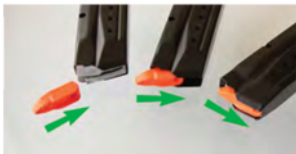

Fig. 16

CO₂ Fill Options

Installation & Operation

1. Apply a small amount of grease into the hole of the Fill Nose of your Fill Device. Do this before each use to ensure proper lubrication of the system. (Fig 1) If you hear a gas leak, refer to the troubleshooting part of this manual.



Fig. 1

NOTE: Before installing CO₂ Fill Devices with a knob, turn the knob fully counterclockwise. To open CO₂ Fill Devices with a knob, turn it fully clockwise. Turn fully counterclockwise when not in use to close it.

2. Thread your CO₂ Fill Device onto the appropriate CO₂ Tank. (Fig. 2)

- Item 1: **90g CO₂ Fill Device**
- Item 2: **Paintball CO₂ Fill Device**
- Item 3: **Soda Maker CO₂ Fill Device**
- Item 4: **Paintball CO₂ Charging Station**



Fig. 2

NOTE: Due to the hardness of some Soda Maker CO₂ Fill Device Seals/Gaskets, it may be necessary to tighten them with a wrench when attaching them to a CO₂ tank.

3. Hold the CO₂ tank vertically (+/-45 degrees), align the muzzle Fill Tip of the Barrel with the Fill Nose on the CO₂ Fill Device. (Fig. 3) Press the muzzle Fill Tip into the Fill Nose for 1-2 seconds. A small “pop” sound upon release indicates a successful charge. Repeat as necessary as the CO₂ content is consumed by shooting with your converted pistol.



Fig. 3

NOTE: The tank must be held upside down (+/- 45 degrees) with the CO₂ Fill Device at the bottom to ensure proper charging of liquid CO₂ into the CoolFire Trainer Barrel.

4. If you are using the Muzzle Laser, thread it into the muzzle of the CoolFire Trainer Barrel until snug and you're ready to shoot. (Fig. 4)



Fig. 4

Lasers

Laser Information

Manufacturer:

CoolFire Trainer
 9525 E. 55th St.
 Tulsa, OK 74145

This laser complies with US FDA performance standards for laser products, except for deviations pursuant to Laser Notice No. 56, dated May 8, 2019.

CLASS 1 LASER PRODUCT CLASSIFIED EN/IEC 60825-1 2014

	Visible Red	Infrared
Laser Model	LM1	LM2
Wavelength	630-650 nm	780-850 nm
Pulse Group Length	3 miliseconds	6 miliseconds

CAUTION: Use of controls or adjustments of performance or procedures other than those specified herein may result in hazardous radiation exposure.

DO NOT OPEN OR MODIFY THE LASER EXCEPT FOR BATTERY EXCHANGE.

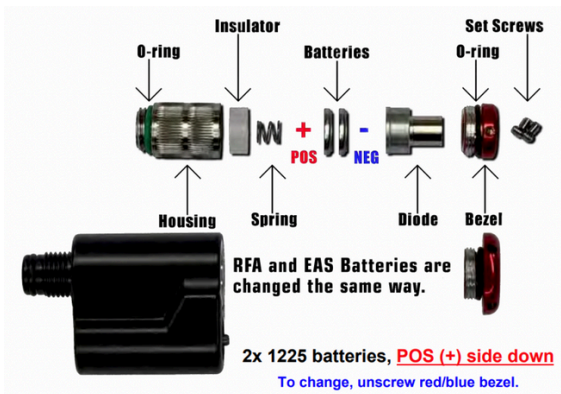

Fig. 1

The Laser must be returned to the manufacturer for any service or repair.

WARRANTY: The CoolFire Trainer Laser has a one-year, limited warranty on parts and labor beginning on the date of delivery.

Installation and Removal Instructions: Rapid Fill Adapters & Extend-a-Shot Lasers

We offer several muzzle devices:

- **Muzzle Laser** (Fig. 1)
- **Rapid Fill Adapter** (Fig 2), which looks like a mock compensator
- **Extend-a-Shot** (Fig. 3), which looks like a mock suppressor



Fig. 1

How to install a Muzzle Laser: Install the barrel into the slide, then simply screw the laser on the thread of the Barrel. (Fig. 1)



Fig. 2



Fig. 3

How to install the Rapid Fill Adapter or the Extend-a-Shot: The **Rapid Fill Adapter** (Fig. 2) and the **Extend-a-Shot** (Fig. 3) are additional “fuel tanks” that increase CO₂ capacity of your barrel per fill. Also, CO₂ filling is more convenient through the exposed fill port.



Fig. 4



Fig. 5

1. Ensure that all CO₂ is purged from the barrel. **WARNING - WEAR EYE PROTECTION AND POINT THE BARREL AWAY FROM YOUR FACE TO PREVENT EYE DISCOMFORT OR POTENTIAL INJURY DUE TO THE UPCOMING CO₂ STREAM.**

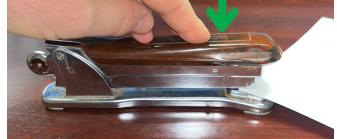

Fig. 6

Insert the short end of the 0.50 inch = 1.5 mm Allen Wrench, and firmly press against a hard horizontal surface. Use about the same force as when stapling multiple sheets of paper together (Fig. 6).



Fig. 7

A hissing sound indicates escaping CO₂. No sound indicates an unpressurized Barrel.

2. When purged, use the provided tool to unscrew the Fill Tip (Fig. 7). Store the Fill Tip to prevent loss. (Fig. 8)



Fig. 87

Installation and Removal Instructions: Rapid Fill Adapters & Extend-a-Shot Lasers (continued)

4. Apply a small amount of Grease (supplied) to the O-ring. (Fig. 9)

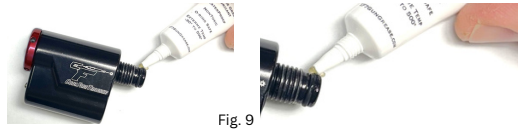

5. Use various combinations of the supplied Washers so the Rapid Fill Adapter's thread backs out at the 12 o'clock position (Fig. 10)

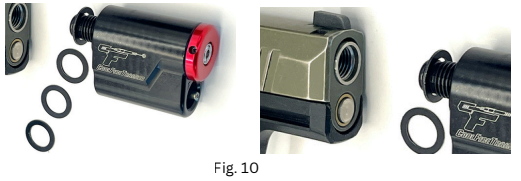

6. Thread the Rapid Fill Adapter or Extend-a-Shot into the end of your barrel. **Do not overtighten.** (Fig. 11)

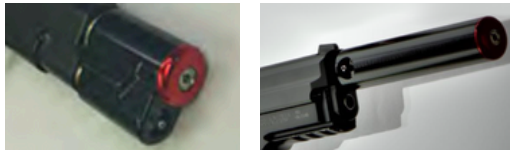

7. To fill the System, press the Fill Tip into the Fill Nose of your Fill Device that's attached to your CO₂ tank for about 2 seconds. (Fig. 12)

REMOVAL

8. **While wearing eye protection and with the Fill Port pointed away from your face**, purge the CO₂ from the System by firmly pressing the 0.050 inch = 1.5 mm Allen Wrench into the Fill Port. (Fig. 13). Then unscrew the device from the Barrel.

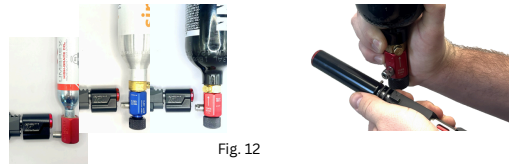

9. Unscrew and store the Rapid Fill Adapter or Extend-A-Shot.

10. Apply a small amount of grease to the O-ring on the Fill Tip removed in step 4.(Fig. 114)

WARNING: DO NOT USE GUN OIL ON RUBBER SEALS, BECAUSE IT DEGRADES RUBBER.

11. Reinstall by using the supplied Tool. (Fig. 15) **WARNING: DO NOT OVERTIGHTEN! WARNING: DO NOT REMOVE LASERS FROM YOUR RAPID FILL ADAPTER OR EXTEND-A-SHOT WITHOUT PURGING ITS CO₂.**



Laser Adjustment

WARNING: TO PREVENT DAMAGING YOUR LASER OR BARREL, DO NOT OVERTIGHTEN THE LASER SCREWS.



Fig. 1

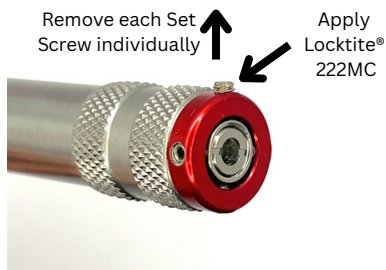

Fig. 2

You will need:

- 0.050 in = 1.25 mm Allen Wrench.
- Medium strength thread locking compound (we use Loctite® 222MC).
- Optionally also a Reflective Target.

1. Using the provided 0.050 in = 1.25 mm Allen Wrench, completely unscrew one Set Screw from the Laser Bezel. (Figs. 1 & 2) Dip the Set Screw into the thread lock compound. Screw the Set Screw back into the Bezel. Repeat for all 4 Set Screws.

2. For precise zeroing, do not charge the CoolFire Trainer Barrel with CO₂ - rack the slide, and aim at your Reflective Target.

3. Carefully pull the trigger and observe the impact point of your Laser. Adjust by screwing the Set Screws back and forth until satisfied. (Fig.1)

WARNING: TO PREVENT DAMAGING YOUR LASER OR BARREL, DO NOT OVERTIGHTEN THE LASER SCREWS.

RECOMMENDED: Allow the thread lock compound to cure following the manufacturer's instructions (24 hours for Loctite® 222MC) before training with the CoolFire Trainer Laser on your Barrel.

Maintenance

CO₂ Storage

To store your CO₂ tanks and CO₂ Fill Devices (1 day or more), we recommend: (Fig.1)

- **Paintball and Soda Maker CO₂ Fill Devices** - Leave these Fill Devices on the CO₂ tank and open the valve by partially unscrewing the Black Knob.
- **Paintball CO₂ Charging Stations** - Remove it from the paintball CO₂ tank completely.
- **90 Gram Fill Device** - Consume the CO₂ by continuing your shooting training, or store as is.

WARNING - DO NOT ATTEMPT TO UNSCREW A 90 GRAM DISPOSABLE CO₂ CARTRIDGE WITH SIGNIFICANT CO₂ CONTENT REMAINING FROM THE FILL DEVICE, BECAUSE THE REMAINING CO₂ WILL LEAK OUT, RAPIDLY COOLING THE CARTRIDGE AND THUS RISKING A FREEZE BURN TO ANY EXPOSED SKIN TOUCHING THE CARTRIDGE. DAMAGE TO THE RUBBER SEAL MAY ALSO OCCUR.

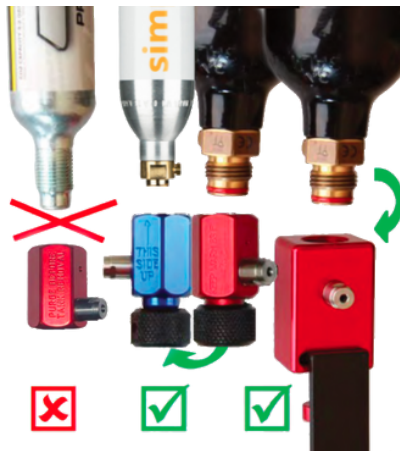

Fig. 1

O-Ring Replacement on a Paintball CO₂ Tank

Spare O-rings (colors may vary) are provided in the Maintenance Care Kit. Also, if you are using a bench-mountable paintball Charging Station, it will have a spare O-ring and two Black Gaskets on the back wall. (Fig. 1)



Fig. 1

1. Using a dental pick or a blade, carefully remove and discard the old O-Ring from the paintball CO₂ tank.



Fig. 2

WARNING - IF YOU ARE USING A DENTAL PICK OR A BLADE (Fig. 2), TAKE CARE TO PREVENT INJURY TO YOUR FINGERS!

2. Remove the O-ring from Fill Device using a plastic card, or from a Care Kit. (Fig. 3)

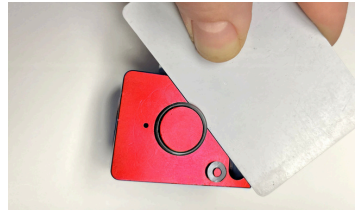

Fig. 3

3. Install the O-ring on the CO₂ tank. (Fig 4.)



Fig. 4

4. Apply a small amount of Grease. (Fig. 5)



Fig. 5

Fill Nose Gasket Replacement On Any Type of Fill Device

Each CO₂ Fill Device has a gasket that will eventually need replacing if there is a leak, indicated by a slow hissing sound from the Fill Nose area.

- If you have a **Sodamaker Fill Device** or a **Paintball Fill Device**, deactivate it by turning the black knob, then remove the tank from the Fill Device.
- If you have the bench-mountable paintball **Charging Station**, simply remove the tank from the Fill Device.
- If you have a **90 Gram Fill Device**, note that a 90g CO₂ Tank cannot be resealed - you can either use it up or, **while wearing eye protection**, purge the remaining CO₂ by inserting the Allen Wrench into the Fill Nose.



WARNING: ALWAYS WEAR EYE PROTECTION AND TEMPERATURE-INSULATING GLOVES WHEN PURGING CO₂ TANKS TO AVOID ANY RISK OF A FREEZE BURN, EYE INJURY, OR IMPACT INJURY.

1. To replace the gasket on your CO₂ Fill Device, you will need:

- New 7mm Black Gasket from your Maintenance Care Kit or from the bench-mountable Charging Station, which you can remove using a plastic card (Fig. 1)
- 9mm open-end wrench
- A wood screw
- The supplied Grease

2. Using a 9mm wrench, remove the Fill Nose. (Fig. 2)

3. Remove the parts inside the Fill Nose. (Fig. 3)

4. Insert wood screw, lodge into inner Gasket, and pull free. (Fig. 4 & 5)

5. Put the new Gasket into the Fill Nose. (Fig. 6)



Fig. 1



Fig. 2

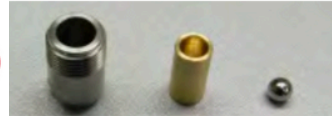

Fig. 3



Fig. 4



Fig. 5



Fig. 6

Fill Nose Gasket Replacement

6. Insert the Steel Ball into Brass Spacer. (Fig. 7)



Fig. 7

6. Use Brass Spacer to press the Gasket into the Fill Nose. (Figs. 8 & 9)



Fig. 8

7. Reinstall the Fill Nose onto the CO₂ Fill Device. (Fig. 10)



Fig. 9

WARNING: DO NOT OVERTIGHTEN THE FILL NOSE.

8. Lubricate the inner Fill Nose with the supplied Grease - the amount of Grease is about the same size as a grain of rice. (Fig. 11)



Fig. 10

WARNING: DO NOT USE THE PROVIDED GREASE ON THE ENTIRE COOLFIRE TRAINER BARREL - IT WILL BECOME STICKY AS IT COOLS AND WILL IMPEDE SLIDE MOVEMENT.



Fig. 11

Striker Inspection & Wear

The polymer **Striker Tip** (Fig. 14), is a consumable designed to serve as the intended point that will experience wear and tear, and therefore protect your firing pin. After several hundred cycles, the repeated impact of your pistol's firing pin will destroy the polymer Striker Tip. Replacing it is quick and easy if you follow the steps below.

Pay attention to the performance and visual appearance to determine if the Striker Tip needs replacing. Look out for an absent, heavily dented or chipped Striker Tip, or inconsistent recoil performance - they all indicate that the Striker Tip needs to be replaced.

NOTE - IF YOU CONTINUE SHOOTING AFTER THE POLYMER STRIKER TIP IS NO LONGER PRESENT, YOU MAY QUICKLY DEFORM THE STRIKER THREADS, WHICH WILL NEED TO BE REPLACED. CONTACT US FOR HELP.

WARNING - COOLFIRE TRAINER IS NOT RESPONSIBLE FOR DAMAGE TO THE STRIKER CAUSED BY SHOOTING WITHOUT A STRIKER TIP.



Fig. 14



Fig. 15

Replacing the Striker Tip

WARNING: ENSURE THAT YOUR COOLFIRE TRAINER BARREL IS NOT PRESSURIZED BEFORE ATTEMPTING ANY MAINTENANCE.

1. While wearing eye protection, purge CO₂ from your CoolFire Trainer Barrel as shown on page 14 (Fig. 4), and page 15. (Fig. 11)



2. Remove this barrel from your handgun.

3. Grasp the old Striker Tip with pliers. (Fig. 15)

4. Unscrew or wiggle the Striker Tip until free, and discard. (Fig. 16)

5. Align the Striker over the new Striker Tip placed on a hard, flat surface. (Fig. 17)

6. With pliers, press or screw Striker into THE Striker Tip until seated completely. (Fig. 18)



Fig. 16



Fig. 17



Fig. 18

Troubleshooting

Charging/Weak Recoil

If you are not getting at least as many shots as your pistol's standard magazine capacity, you're not getting a full CO₂ charge. Here's why and what to do about it:

- Ensure that you are **holding the CO₂ tank with the Fill Device upside down +/- 45 degrees**. (Fig. 1) This is to ensure that liquid CO₂ fills the CoolFire Barrel, so you'll get as many shots per fill as possible.
- To charge the CoolFire Barrel, push the Fill Tip into the Fill Device for **1 to 2 seconds**. You'll hear a slight "pop" when you separate the Fill Tip from the CO₂ Fill Device.
- CO₂ pressure and temperature will impact the performance of the CoolFire Trainer Barrel.
 - **If the Barrel is too cold** (due to rapid shooting), the Piston will slow down.
 - **If the CO₂ Tank gets cold**, less CO₂ may be charged into the CoolFire Trainer Barrel, resulting in fewer shots. If you purchased your paintball CO₂ tank from us, it will have an adhesive temperature strip. (Fig. 2)
 - Therefore, allow the Barrel and/or the CO₂ Tank to warm up slightly to room temperature (**72 °F = 22 °C**). Gently **warming the CO₂ up to 85 °F = 30 °C** may be even better.



Fig. 1



Fig. 2

Charging/Weak Recoil (continued)

- Your **CO₂ tank is empty or nearing empty** - See the table below. When your CO₂ tank is completely depleted, it will still have some CO₂ vapor inside, but this will not be enough to fill your CoolFire Trainer for satisfactory training. Simply switch to a new CO₂ tank and keep training!



CO2 Tank Type & Size		Bundle	Condition & Weight	
			Empty	Full
Paintball	12 oz	Tank only	540 g	915 g
		Tank & Fill Device with a knob	610 g	985 g
		Tank & Charging Station block	680 g	1,050 g
	20 oz	Tank only	855 g	1,420 g
		Tank & Fill Device with a knob	924 g	1,490 g
		Tank & Charging Station block	990 g	1,560 g
Sodamaker	14 oz	Tank only	805 g	1,260 g
		Tank & Fill Device with a knob	875 g	1,330 g
Cartridge	90 gram	Tank only	420 g	510g
		Tank with a Fill Device	485 g	575 g

Troubleshooting Performance

Low Shot Count / Weak Recoil

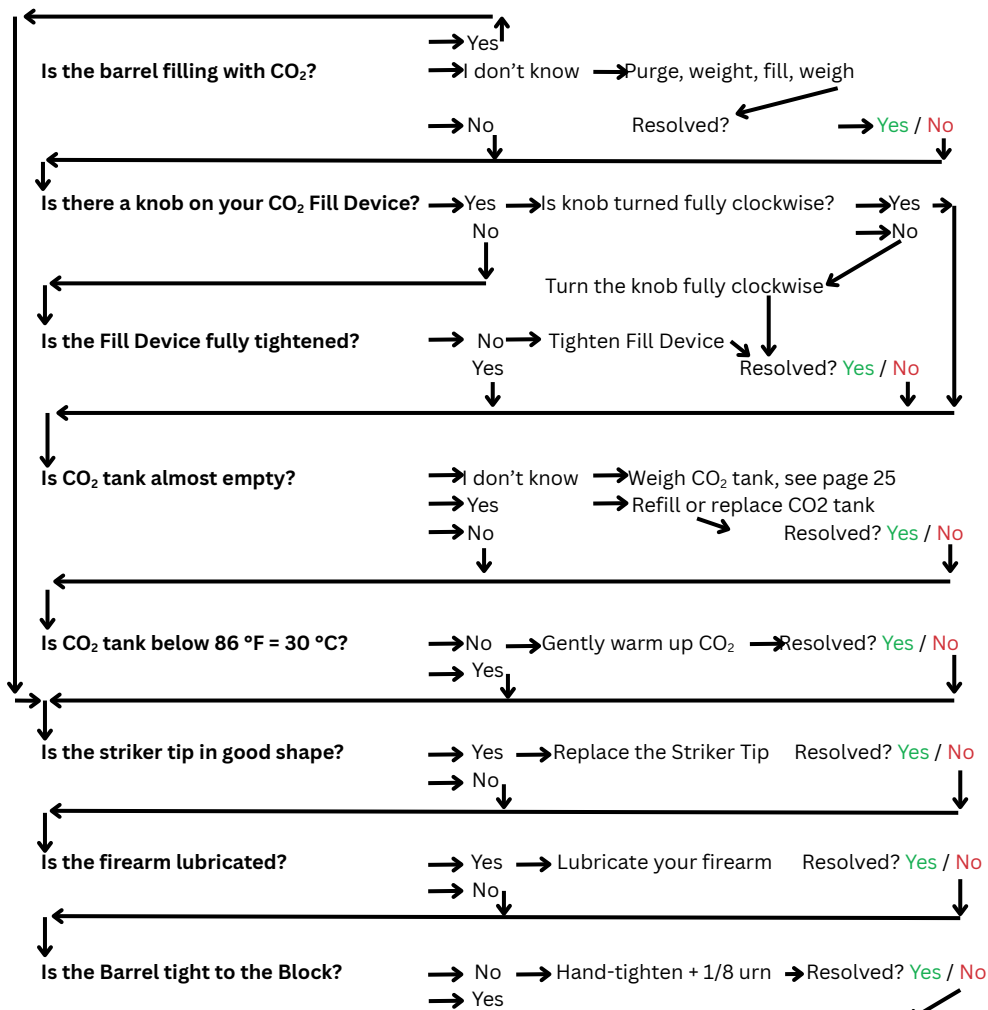

For help, email support@coolfiretrainer.com

***** WARNING - WEAR EYE PROTECTION AND POINT THE BARREL AWAY FROM YOUR FACE WHEN PURGING CO₂ TO PREVENT EYE DISCOMFORT OR POTENTIAL INJURY DUE TO THE UPCOMING CO₂ STREAM.**



Lubrication - Use the provided Grease only for optimal service life of rubber seals. **WARNING: DO NOT LUBRICATE WITH GUN OIL, BECAUSE IT DEGRADES RUBBER!** Damage to the seals and/or O-ring may result in leakage.

Troubleshooting Leaks

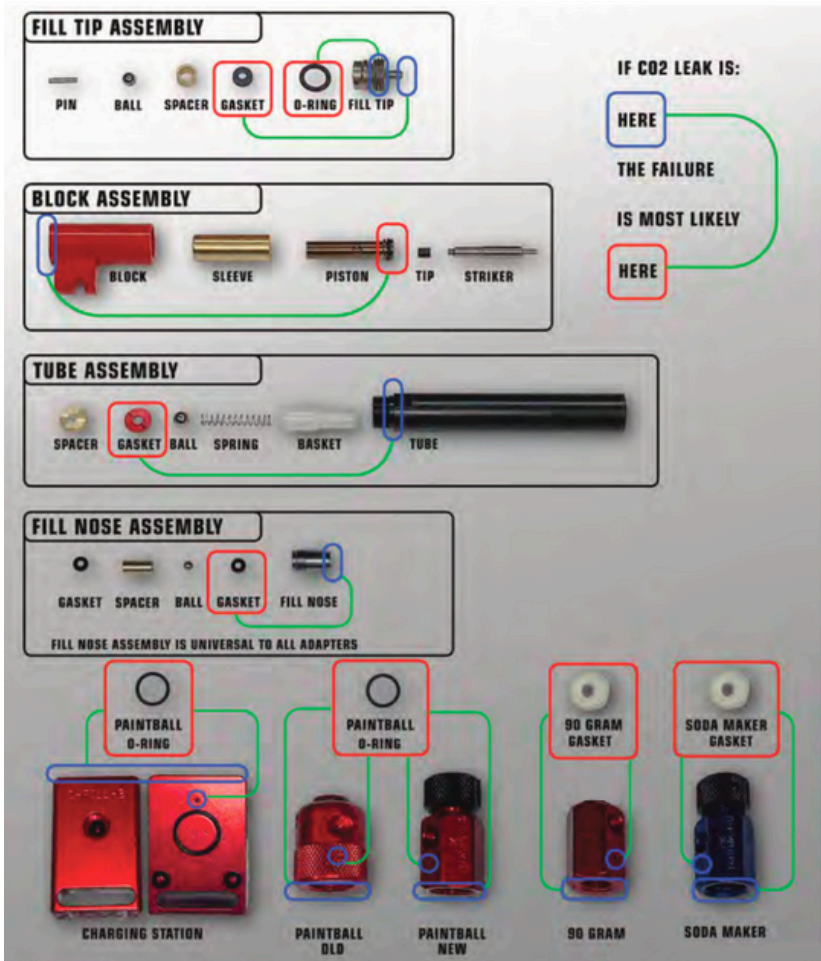

- If there is a **leak from where the Barrel meets the Block** - The Barrel may have become unthreaded from the Block. Hand-tighten the Barrel to the Block. If the Barrel becomes loose frequently, apply a drop of Loctite® Thread Locker Blue 242® to the Barrel thread. Do not completely remove the Barrel. Simply unscrew it to expose the top couple of threads and apply the drop of Loctite®.
- If tightening the Barrel does not resolve the issue, repair may be required. In this case, please contact technical support.

For help, email support@coolfiretrainer.com

Inconsistent Laser

If the Laser is discharging inconsistently, there are several possible causes to consider:

1) The Laser is not fully seated in the barrel. (Fig. 1) Ensure the Laser is fully seated against the Barrel by hand-tightening.

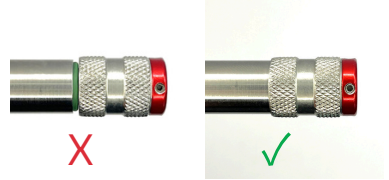

Fig. 1

2) Laser adjustment screws have loosened. (Fig. 2) Using your 0.050 in/1.25 mm Allen Wrench, tighten the Set Screws to snug only. Check the Laser's point of impact, and adjust the Set Screws as required to zero the Laser with your sights.

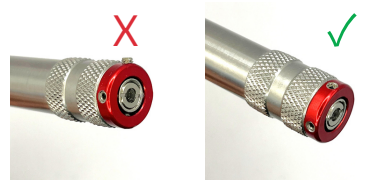

Fig. 2

3) The Batteries may not be making adequate contact. (Fig. 3) Ensure the Laser Bezel is tight against the Laser Housing. Hand-tighten only. DO NOT overtighten!

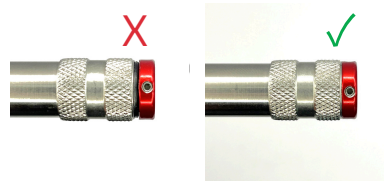

Fig. 3

WARNING: TO PREVENT DAMAGE TO YOUR LASER, DO NOT OVERTIGHTEN!

For help, email support@coolfiretrainer.com

Inconsistent Laser (continued)

4) The Batteries are drained - Change the batteries by unscrewing the bezel.

Insert the 0.50 inch = 1.5 mm Allen Wrench into the Set Screw cavity and use the Wrench for leverage to unscrew the Bezel with the Laser Diode from the Laser Module Body. (Fig. 1) and 2)

Shake out the old batteries and discard. (Fig. 3)

Ensure the Spring that supports the batteries is still present. If the Spring fell out, find it and reinstall it.(Fig 4)

Place 2 new 1225 batteries into the cavity with the checkered side up towards the Laser (Fig. 5)

Screw the Bezel with the Laser Diode back into the Laser Module Body. (Fig.

Test for function in dryfire with your Barrel, or by tapping the Laser gently with a metal object (e.g. a metal spoon).

WARNING: TO PREVENT DAMAGE TO YOUR LASER, DO NOT OVER-TIGHTEN!

5) The Laser has become damaged and inoperable. (Fig. 6) Contact technical support for additional troubleshooting tips at support@coolfiretrainer.com.

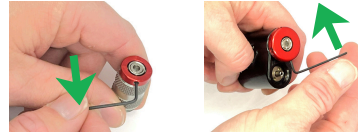

Fig. 1

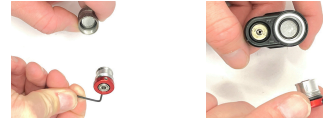

Fig. 2



Fig. 3

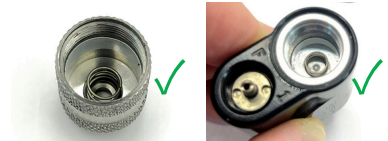

Fig. 4

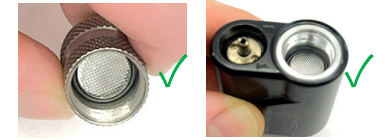

Fig. 5

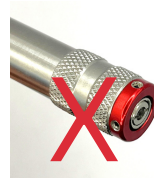

Fig. 6

For help, email support@coolfiretrainer.com



COOLFIRE ***TRAINER***

www.CoolFireTrainer.com

support@CoolFireTrainer.com