



FOXTROT365™

P365® PISTOL WEAPON LIGHT

OPERATOR'S MANUAL



Please visit sigsauer.com for Operator's Manual downloads.

INTRODUCTION:

The FOXTROT365™ Pistol Weapon Light combines an intuitive white light solution in a sleek package for self defense, conceal carry and home defense. The FOXTROT365™ is compatible with SIG P365® pistols.

The FOXTROT365™ is covered by the SIG SAUER Electro-Optics Infinite Guarantee and Electronics & Tritium Component Limited 5-Year Warranty.

KEY FEATURES:

- Compact & lightweight 100 lumen Pistol Weapon Light
- Instant activation with grip module tact switch
- Precision engineered to fit SIG P365®

CONTENTS:

- FOXTROT365™ Pistol Weapon Light
- .05" Allen Wrench
- (2) Assembly Screws
- (2) Cotton Swabs
- (2) CR 1/3N Batteries
- Operator's Manual

PARTS IDENTIFICATION:

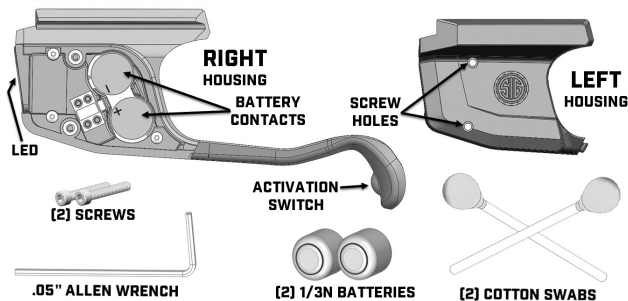

⚠ WARNING

- **INGESTION HAZARD:** This product contains a button cell or coin battery.
- **DEATH** or serious injury can occur if ingested.
- A swallowed button cell or coin battery can cause **Internal Chemical Burns** in as little as **2 hours**.
- **KEEP** new and used batteries **OUT OF REACH OF CHILDREN**.
- **Seek immediate medical attention** if a battery is suspected to be swallowed or inserted inside any part of the body.



IMPORTANT:

Prior to installation, battery change, cleaning or maintenance, follow the SIG P365® operator's manual to ensure the firearm is unloaded and pointed in a safe direction.

INSTALLATION:

1. Uninstall (2) screws, remove left housing and set aside (Fig 1).
2. Center rear portion of right housing on pistol trigger guard as shown (Fig 2).

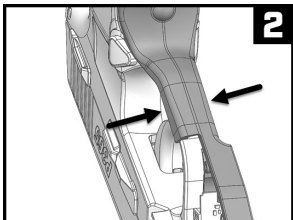
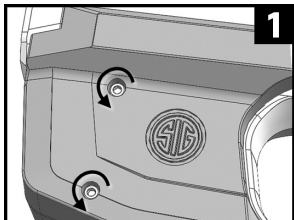

3. Pull up and snap right housing firmly into proprietary grip module rail (Fig 3).
4. Insert (2) 1/3N Batteries into right housing. Top battery should show positive end (+) facing outwards, while bottom battery shows negative end (-) (Fig 4).

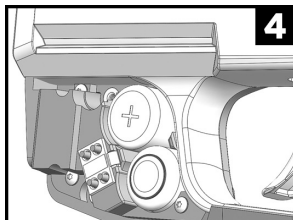
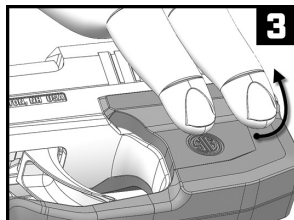

5. Insert rear portion (A) of left housing into right housing at 30° angle (Fig 5). Mate left housing (B) to right housing.

6. Install (2) mounting screws into left housing with .05" allen wrench. Squeeze both sides together tightly. Next, tighten each mounting screw until secure (Fig 6). Do not over-tighten as this may damage housing.

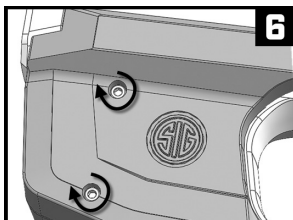
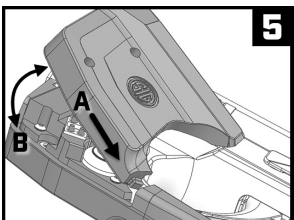

OPERATION:

1. To turn light on, depress activation switch as grip is tightened on the pistol (Fig 7). Reduce grip pressure to turn light off.

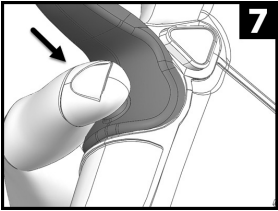

BATTERY REPLACEMENT:

- 1. Follow Step 1 of the INSTALLATION section. Leave right housing mounted to trigger guard.
- 2. Pull expended 1/3N Lithium batteries from right housing.
- 3. Follow Steps 4-6 of the INSTALLATION section.

CLEANING & MAINTENANCE:

After repeated fire, the lens may become clouded with gunpowder residue. For best results, it is recommended that this area be cleaned, along with the firearm, after each use. To clean the lens, follow these steps:

- 1. Keep firearm pointed in a safe direction
- 2. Ensure firearm is unloaded
- 3. Confirm light is off
- 4. Dampen the end of a cotton swab with isopropyl alcohol
- 5. Apply dampened swab to lens and polish in a small circular pattern. Be sure to clean around lens edge

Firearm should be cleaned and lubricated exactly as directed in your SIG SAUER P365® owner’s manual. Excess lubrication can interfere with the proper function of both firearm and FOXTROT365™ Pistol Weapon Light. The FOXTROT365™ Pistol Weapon Light should never be submerged or flushed with cleaning solvents.

FOXTROT365 SPECIFICATIONS	
Dimensions	3.8" L x 1.0" W x 1.9" H
Weight	1.3 oz with (2) 1/3N installed
Lumen Rating	100
Battery	(2) CR 1/3N Lithium
Activation Switch Type	Momentary On/Off
Water Resistance	IPX4



WARNING: CANCER AND REPRODUCTIVE HARM—www.P65warnings.ca.gov

NOTICE: Export restrictions may apply – this product may be controlled either by the ITAR or EAR.



SIG SAUER ELECTRO-OPTICS INFINITE GUARANTEE®/ LIMITED LIFETIME WARRANTY

SIG SAUER® has manufactured the most rugged, dependable, high-performance firearms for more than two centuries. Our heritage of design, engineering, and precision-manufactured quality predates the existence of any other optics company worldwide. We understand the importance of quality in the line of fire, at the shooting range or on your next hunt. SIG SAUER Electro-Optics had to earn the right to wear that badge and the Infinite Guarantee has your back, forever. Period.

We will repair or replace your SIG SAUER product in the event it becomes damaged or defective, at no charge to you. If we cannot repair your product, we will replace it with a product in perfect working order of equal or better physical condition.

SIG SAUER® Infinite Guarantee®

- Unlimited Lifetime Guarantee
- Fully Transferable
- No Warranty Card Required
- No Receipt Required
- No Time Limit Applies
- No Charge

Please note that our Infinite Guarantee excludes coverage for intentional damage, misuse, cosmetic damage that does not affect the performance of the optic, loss, theft, or unauthorized repair or modification. Excludes electronic and Tritium components.

Customers seeking warranty coverage must first obtain a Return Merchandise Authorization (RMA) by contacting SIG SAUER Customer Service, and return the product unloaded and freight prepaid. ANY WARRANTIES IMPLIED BY LAW, INCLUDING ANY IMPLIED WARRANTIES OF MERCHANTABILITY OR FITNESS FOR A PARTICULAR PURPOSE, ARE EXPRESSLY DISCLAIMED. REPAIR, ALTERATION, OR REPLACEMENT AS PROVIDED HEREIN IS YOUR EXCLUSIVE REMEDY FOR ANY DEFECTIVE PRODUCT. IN NO EVENT SHALL SIG SAUER OR ANY COMPANY AFFILIATED WITH SIG SAUER BE LIABLE FOR ANY SPECIAL, INCIDENTAL, OR CONSEQUENTIAL DAMAGES OF ANY KIND ARISING OUT OF THE PURCHASE OR USE OF THIS PRODUCT, WHETHER BASED UPON CONTRACT, TORT, STATUTE, OR OTHERWISE. Some states do not allow the exclusion or limitation of implied warranties, or the exclusion or limitation of incidental or consequential damages, so some or all of the above limitations or exclusions may not apply to you. This warranty gives you specific legal rights, and you may also have other rights which vary from State to State. THIS WARRANTY APPLIES TO COMMERCIAL CUSTOMERS ONLY, AND DOES NOT APPLY TO GOVERNMENT, MILITARY, LAW ENFORCEMENT, OR NON-US CUSTOMERS. NON-US COMMERCIAL CUSTOMERS MUST PURCHASE PRODUCT THROUGH AN AUTHORIZED SIG SAUER DEALER WITHIN THEIR COUNTRY OF RESIDENCE FOR THIS WARRANTY TO APPLY.



SIG SAUER® ELECTRONIC COMPONENT LIMITED 5-YEAR WARRANTY

SIG SAUER warrants that the electronic and tritium components of the enclosed product were originally manufactured free of defects in workmanship, material, and mechanical function. For a period of five (5) years from the date of manufacture, SIG SAUER agrees to correct any defect in these components by repair, adjustment, or replacement, at SIG SAUER's option, with the same or comparable quality components (or by replacing the product at SIG SAUER's option); provided however

that a Return Merchandise Authorization (RMA) is first obtained by contacting SIG SAUER Customer Service, and that the product is returned unloaded and freight prepaid. This limited warranty is null and void if the product has been misused, damaged (by accident or otherwise), damaged through failure to provide reasonable and necessary maintenance as described in the user's manual, or if unauthorized repair or any alteration, including of a cosmetic nature, has been performed on the product. This limited warranty does not apply to normal cosmetic wear and tear of any parts.

ANY WARRANTIES IMPLIED BY LAW, INCLUDING ANY IMPLIED WARRANTIES OF MERCHANTABILITY OR FITNESS FOR A PARTICULAR PURPOSE, ARE EXPRESSLY DISCLAIMED. REPAIR, ALTERATION, OR REPLACEMENT AS PROVIDED HEREIN IS YOUR EXCLUSIVE REMEDY FOR ANY DEFECTIVE PRODUCT. IN NO EVENT SHALL SIG SAUER OR ANY COMPANY AFFILIATED WITH SIG SAUER BE LIABLE FOR ANY SPECIAL, INCIDENTAL, OR CONSEQUENTIAL DAMAGES OF ANY KIND ARISING OUT OF THE PURCHASE OR USE OF THIS PRODUCT, WHETHER BASED UPON CONTRACT, TORT, STATUTE, OR OTHERWISE. Some states do not allow the exclusion or limitation of implied warranties, or the exclusion or limitation of incidental or consequential damages, so some or all of the above limitations or exclusions may not apply to you. This warranty gives you specific legal rights, and you may also have other rights which vary from State to State. THIS WARRANTY APPLIES TO COMMERCIAL CUSTOMERS ONLY, AND DOES NOT APPLY TO GOVERNMENT, MILITARY, LAW ENFORCEMENT, OR NON-US CUSTOMERS. NON-US COMMERCIAL CUSTOMERS MUST PURCHASE PRODUCT THROUGH AN AUTHORIZED SIG SAUER DEALER WITHIN THEIR COUNTRY OF RESIDENCE FOR THIS WARRANTY TO APPLY.

For Product Service on this model,
Please Call 603-610-3000
12100 SW Tualatin Rd,
Tualatin, OR 97062 USA

