



LIMA365™

P365® LASER SIGHT

OPERATOR'S MANUAL



Please visit sigsauer.com for Operator's Manual downloads.

INTRODUCTION:

The LIMA365™ Laser Sight provides intuitive and accurate target acquisition resulting in the ideal sighting solution for self defense, conceal carry and home defense. The LIMA365™ is compatible on SIG P365 pistols.

The LIMA365 is covered by the SIG SAUER® Electro-Optics Infinite Guarantee and Electronics & Tritium Component Limited 5-Year Warranty.

KEY FEATURES:

- Compact & lightweight laser sight
- Instant activation with grip module tact switch
- Precision engineered to fit SIG P365
- Low battery indicator

CONTENTS:

- LIMA365™ Laser Sight
- .05" Allen Wrench
- (2) Assembly Screws
- CR 1/3N Battery
- (2) Cotton Swabs
- Class 3R Warning Labels
- Owners Manual

PARTS IDENTIFICATION:

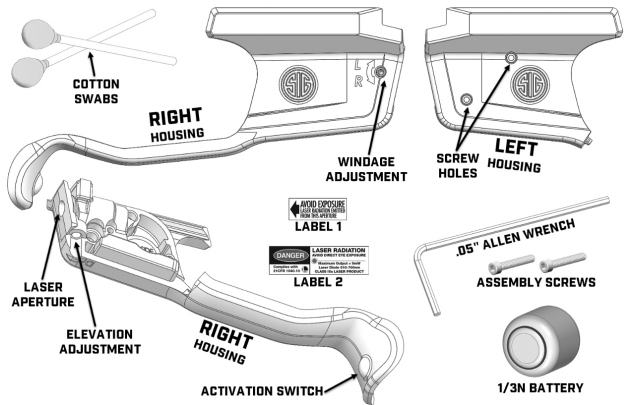

LIMA365 SPECIFICATIONS	
Dimensions	3.8" L x 1.0" W x 1.9" H
Weight	0.8 oz
Laser Wavelength	Red 650 nm; Green 515 nm
Laser Class	IEC Class 3R Visible Laser
Laser Output Power	< 5mW
Battery	CR 1/3N Lithium
Runtime (Steady)	Red > 4 hours; Green > 2 hour
Activation Switch Type	Momentary On/Off

IMPORTANT:

Prior to installation, battery change, cleaning or maintenance, follow the SIG P365 operator's manual to ensure the firearm is unloaded and pointed in a safe direction.

INSTALLATION:

1. Center rear portion of right housing on pistol trigger guard as shown (Fig 1).
2. Pull up and snap right housing firmly into proprietary grip module rail (Fig 2).

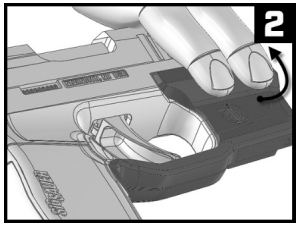
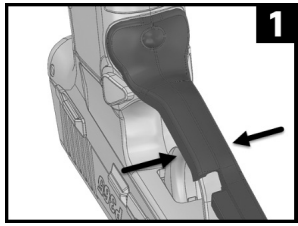

3. Insert 1/3N Battery into right housing, positive-end (+) facing outwards (Fig 3).
4. Insert rear portion (A) of left housing into right housing at 30° angle (Fig 4). Mate left housing (B) to right housing.

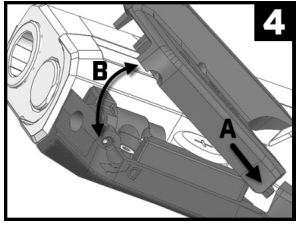
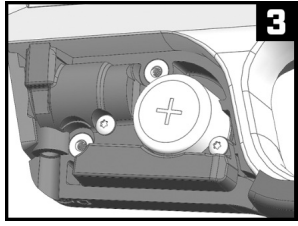

5. Install (2) mounting screws into left housing with .05" allen wrench (Fig 5). Squeeze both sides together tightly. Next, tighten each mounting screw until secure. Do not over-tighten as this may damage laser housing.

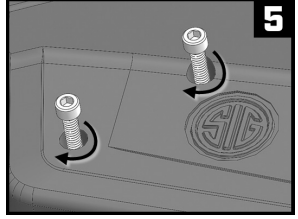

OPERATION:

1. To turn laser on, depress activation switch as you tighten your grip on the pistol (Fig 6). Reduce grip pressure to turn laser off.

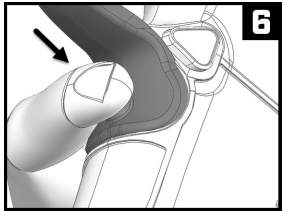

ALIGNING THE LASER:

1. Verify initial alignment by comparing the laser aiming point to iron sights at 10-yard target distance. The laser aiming point should be located slightly above the front iron sight.
2. To make adjustments, insert .05" adjustment tool into either the windage port (Fig 7) or the elevation adjustment port (Fig 8) and slowly rotate tool while comparing laser aiming point to iron sight alignment. A half-turn will result in approximately 7 inches at 5 yards. Important: Do not rotate alignment tool more than one full rotation in either direction from factory position. This may result in damage to the laser, not covered under warranty.
3. Windage Adjustment: With firearm unloaded, chamber clear and muzzle pointing downrange insert adjustment tool into windage port. A clockwise rotation will shift laser aiming point left. A counterclockwise rotation will shift laser aiming point right (Fig 7).
4. Elevation Adjustment: With firearm unloaded, chamber clear and muzzle pointing downrange insert adjustment tool into elevation port. A clockwise rotation will shift laser aiming point up. A counterclockwise rotation will shift laser aiming point down (Fig 8).

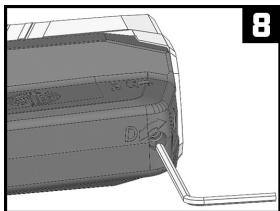
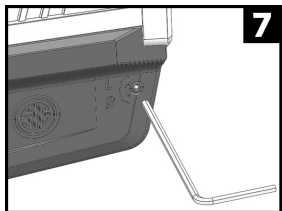

5. Verify laser alignment by shooting target and making additional adjustments as required. Tip: Move laser to center of shot group (Fig 9).

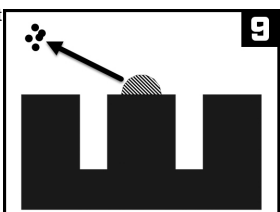

NOTE: Laser may experience slight alignment shift after firing the first time. Recheck alignment after first use and readjust as necessary.

BATTERY REPLACEMENT:

1. Remove mounting screws and uninstall left housing from right housing. Leave right housing mounted to trigger guard.
2. Pull expended 1/3N Lithium battery from right housing.
3. Insert fresh 1/3N Battery into right housing, positive-end (+) facing outwards (Fig 3).
4. Reinstall left housing according to steps 4-6 from INSTALLATION section.
5. Verify laser alignment by engaging target and adjusting as required.

CLEANING & MAINTENANCE:

After repeated fire, the lens may become clouded with gunpowder residue. For best results, it is recommended that this area be cleaned, along with the firearm, after each use. To clean the lens, follow these steps:

1. Keep firearm pointed in a safe directly
2. Ensure firearm is unloaded
3. Confirm laser is off
4. Dampen the end of a cotton swab with isopropyl alcohol
5. Apply dampened swab to lens and polish in a small circular pattern. Be sure to clean around lens edge

Firearm should be cleaned and lubricated exactly as directed in your SIG SAUER P365 owners manual. Excess lubrication can interfere with the proper function of both firearm and LIMA365™ laser sight. The LIMA365™ laser sight should never be submerged or flushed with cleaning solvents.



- **Pointing a laser beam at some objects such as watercraft, aircraft, moving vehicles and construction equipment may be illegal. Check local/federal laws and follow them accordingly.**
- **Laser radiation is emitted from the front aperture of this device when the activation switch is depressed.**
- **Avoid direct eye exposure to laser beam.**

NOTICE: The FDA requires warning labels to be affixed to firearm. Attach Label 1 pointing towards laser aperture. Attach Label 2 to exterior of firearm.

FCC Requirements: The user's manual or instruction manual for an intentional or unintentional radiator shall caution the user that changes or modifications not expressly approved by the party responsible for compliance could void the user's authority to operate the equipment.

Note: This equipment has been tested and found to comply with the limits for a Class B digital device, pursuant to part 15 of the FCC Rules. These limits are designed to provide reasonable protection against harmful interference in a residential installation. This equipment generates, uses and can radiate radio frequency energy and, if not installed and used in accordance with the instructions, may cause harmful interference to radio communications. However, there is no guarantee that interference will not occur in a particular installation. If this equipment does cause harmful interference to radio or television reception, which can be determined by turning the equipment off and on, the user is encouraged to try to correct the interference by one or more of the following measures:

- Reorient or relocate the receiving antenna.
- Increase the separation between the equipment and receiver.
- Connect the equipment into an outlet on a circuit different from that to which the receiver is connected.
- Consult the dealer or an experienced radio/TV technician for help.



WARNING: CANCER AND REPRODUCTIVE HARM—www.P65warnings.ca.gov



LABEL 1

LABEL 2



SIG SAUER ELECTRO-OPTICS INFINITE GUARANTEE®/LIMITED LIFETIME WARRANTY

SIG SAUER® has manufactured the most rugged, dependable, high-performance firearms for more than two centuries. Our heritage of design, engineering, and precision-manufactured quality predates the existence of any other optics company worldwide. We understand the importance of quality in the line of fire, at the shooting range or on your next hunt. SIG SAUER Electro-Optics had to earn the right to wear that badge and the Infinite Guarantee has your back, forever. Period.

We will repair or replace your SIG SAUER product in the event it becomes damaged or defective, at no charge to you. If we cannot repair your product, we will replace it with a product in perfect working order of equal or better physical condition.

SIG SAUER® Infinite Guarantee®

- Unlimited Lifetime Guarantee
- Fully Transferable
- No Warranty Card Required

- No Receipt Required
- No Time Limit Applies
- No Charge

Please note that our Infinite Guarantee excludes coverage for intentional damage, misuse, cosmetic damage that does not affect the performance of the optic, loss, theft, or unauthorized repair or modification. Excludes electronic and Tritium components.

Customers seeking warranty coverage must first obtain a Return Merchandise Authorization (RMA) by contacting SIG SAUER Customer Service, and return the product unloaded and freight prepaid.

ANY WARRANTIES IMPLIED BY LAW, INCLUDING ANY IMPLIED WARRANTIES OF MERCHANTABILITY OR FITNESS FOR A PARTICULAR PURPOSE, ARE EXPRESSLY DISCLAIMED. REPAIR, ALTERATION, OR REPLACEMENT AS PROVIDED HEREIN IS YOUR EXCLUSIVE REMEDY FOR ANY DEFECTIVE PRODUCT. IN NO EVENT SHALL SIG SAUER OR ANY COMPANY AFFILIATED WITH SIG SAUER BE LIABLE FOR ANY SPECIAL, INCIDENTAL, OR CONSEQUENTIAL DAMAGES OF ANY KIND ARISING OUT OF THE PURCHASE OR USE OF THIS PRODUCT, WHETHER BASED UPON CONTRACT, TORT, STATUTE, OR OTHERWISE. Some states do not allow the exclusion or limitation of implied warranties, or the exclusion or limitation of incidental or consequential damages, so some or all of the above limitations or exclusions may not apply to you. This warranty gives you specific legal rights, and you may also have other rights which vary from State to State.

THIS WARRANTY APPLIES TO COMMERCIAL CUSTOMERS ONLY, AND DOES NOT APPLY TO GOVERNMENT, MILITARY, LAW ENFORCEMENT, OR NON-US CUSTOMERS. NON-US COMMERCIAL CUSTOMERS MUST PURCHASE PRODUCT THROUGH AN AUTHORIZED SIG SAUER DEALER WITHIN THEIR COUNTRY OF RESIDENCE FOR THIS WARRANTY TO APPLY.



SIG SAUER® ELECTRONIC COMPONENT LIMITED 5-YEAR WARRANTY

SIG SAUER warrants that the electronic and tritium components of the enclosed product were originally manufactured free of defects in workmanship, material, and mechanical function. For a period of five (5) years from the date of manufacture, SIG SAUER agrees to correct any defect in these components by repair, adjustment, or replacement, at SIG SAUER's option, with the same or comparable quality components (or by replacing the product at SIG SAUER's option); provided however that a Return Merchandise Authorization (RMA) is first obtained by contacting SIG SAUER Customer Service, and that

the product is returned unloaded and freight prepaid.

This limited warranty is null and void if the product has been misused, damaged (by accident or otherwise), damaged through failure to provide reasonable and necessary maintenance as described in the user's manual, or if unauthorized repair or any alteration, including of a cosmetic nature, has been performed on the product. This limited warranty does not apply to normal cosmetic wear and tear of any parts.

ANY WARRANTIES IMPLIED BY LAW, INCLUDING ANY IMPLIED WARRANTIES OF MERCHANTABILITY OR FITNESS FOR A PARTICULAR PURPOSE, ARE EXPRESSLY DISCLAIMED. REPAIR, ALTERATION, OR REPLACEMENT AS PROVIDED HEREIN IS YOUR EXCLUSIVE REMEDY FOR ANY DEFECTIVE PRODUCT. IN NO EVENT SHALL SIG SAUER OR ANY COMPANY AFFILIATED WITH SIG SAUER BE LIABLE FOR ANY SPECIAL, INCIDENTAL, OR CONSEQUENTIAL DAMAGES OF ANY KIND ARISING OUT OF THE PURCHASE OR USE OF THIS PRODUCT, WHETHER BASED UPON CONTRACT, TORT, STATUTE, OR OTHERWISE. Some states do not allow the exclusion or limitation of implied warranties, or the exclusion or limitation of incidental or consequential damages, so some or all of the above limitations or exclusions may not apply to you. This warranty gives you specific legal rights, and you may also have other rights which vary from State to State.

THIS WARRANTY APPLIES TO COMMERCIAL CUSTOMERS ONLY, AND DOES NOT APPLY TO GOVERNMENT, MILITARY, LAW ENFORCEMENT, OR NON-US CUSTOMERS. NON-US COMMERCIAL CUSTOMERS MUST PURCHASE PRODUCT THROUGH AN AUTHORIZED SIG SAUER DEALER WITHIN THEIR COUNTRY OF RESIDENCE FOR THIS WARRANTY TO APPLY.

FOR PRODUCT SERVICE ON THIS MODEL,

PLEASE CALL 603-610-3000

27100 SW Parkway Ave. Wilsonville, OR 97070 USA

P/N 7401070-01 REV04

SIGSAUER®

sigsauer.com