

SIGSAUER[®]



SIG M400 SDI RIFLES[®]

OPERATOR'S MANUAL: HANDLING & SAFETY INSTRUCTIONS



READ THE INSTRUCTIONS AND WARNINGS IN THIS MANUAL CAREFULLY BEFORE USING THIS FIREARM. DO NOT DISCARD THIS MANUAL.

THIS MANUAL SHOULD ALWAYS ACCOMPANY THIS FIREARM AND BE TRANSFERRED WITH IT UPON CHANGE IN OWNERSHIP, OR WHEN THE FIREARM IS PRESENTED TO ANOTHER PERSON.



WARNINGS

1.0 SAFETY WARNINGS

READ THIS ENTIRE MANUAL THOROUGHLY AND CAREFULLY PRIOR TO USING THIS FIREARM.

The warnings in this operators manual are extremely important. By understanding the dangers inherent in the use of any firearm, and by taking the precautions described in this manual, you can experience a high level of safety in the use of your firearm. Failure to heed any of these warnings may result in serious injury or death to you or others, as well as severe damage to the firearm or other property.

WARNINGS in this manual identify a clear danger to the person performing that procedure. Warnings are identified by a red banner with the word **WARNING** in white, bold, uppercase letters and a **WARNING** icon. Failure to comply with a **WARNING** can result in serious injury or death to you or a bystander.



WARNING

CAUTIONS in this manual identify a risk of damage to the firearm being maintained. **CAUTIONS** are identified by a black banner with the word **CAUTION** in white, bold, uppercase letters.

CAUTION



WARNINGS

SIG SAUER

As a valued SIG SAUER customer, we encourage you to visit sigsauer.com. There you will find links to product information and updates, merchandise promotions, and educational videos that will be of interest to you as an owner of SIG SAUER products.

SIG SAUER firearms are designed to function reliably with proper care and knowledgeable use. You must understand the safe operation and use of your SIG SAUER firearm. Read and follow these instructions carefully. Do not use the firearm unless you fully understand these instructions and the safe operation of your firearm. Failure to heed any of these instructions may result in serious injury or death to you or others, as well as severe damage to the firearm or other property.

Your firearm comes equipped with effective, well-designed safety features. However, never rely completely on any safety mechanism. Safety mechanisms are designed to augment, not replace safe handling practices. Careless and improper handling of any firearm can result in an unintentional discharge.

Only your safe firearm handling habits will ensure the safe use of your firearm. Like all mechanical devices, the safety mechanisms are subject to breakage or malfunction and can be negatively affected by wear, abuse, dirt, corrosion, incorrect assembly, improper adjustment or repair, or lack of maintenance. Moreover, there is no such thing as a safety mechanism that is “childproof” or that can completely prevent accidental discharge from improper usage, carelessness, “horseplay”, or abusive handling.

The best safety is proper and applied training in safe firearm handling. Always handle your firearm as though you expect the safeties not to work.



WARNINGS

1.0 SAFETY WARNINGS – CONTINUED

Do not load a cartridge into the chamber until you are ready to use the firearm. Keep the firearm on SAFE until you are actually ready to use the firearm. Always move the selector fully to its engaged position and visually check it. The selector is not on SAFE unless it is completely on SAFE.

ABUSIVE HANDLING

SIG SAUER firearms incorporate effective mechanical safeties. However, like any mechanical device, exposure to abusive conditions may have a negative effect on these safety mechanisms and cause them to fail to work as designed. Do not subject your SIG SAUER firearm to any type of abusive handling. This includes the firearm being dropped, impact to the firearm, or the firearm being struck by another object. Make sure you always maintain control of your firearm at all times. If your firearm does suffer an abusive event such as previously described, do not attempt to use the firearm. Keep the firearm pointed in a safe direction, unload and clear the firearm of all ammunition immediately, and have it inspected by a certified SIG SAUER armorer or gunsmith prior to using the firearm.

A safe direction is defined as an area in which, if the firearm were to discharge, no property damage would occur and no personal injury would result.

As previously noted, if your SIG SAUER firearm does suffer an abusive event, unload it immediately and have it inspected by a certified SIG SAUER Armorer or gunsmith prior to using the firearm.

Intentional or repetitive abusive handling of any SIG SAUER firearm will void the manufacturer's warranty and could render the firearm unsafe.



WARNINGS

SIG SAUER

REPLACEMENT PARTS

Do not attempt to disassemble your SIG SAUER firearm beyond the point explained in this manual. Disassembly beyond the instructions in this manual is restricted to a certified SIG SAUER armorer or professional gunsmith. Failure to comply with these restrictions will void your warranty.

Warnings and instructions about the use of some SIG SAUER replacement parts, assemblies, and accessories may be described in literature accompanying the specific products. Read and carefully follow those instructions. Such warnings and instructions are provided to assure the safe functioning of the firearm. Failure to heed them may result in improper functioning, damage to the firearm, and serious injury or death to you or others.

ALTERATIONS

This SIG SAUER firearm was designed to function properly in its original condition. Unauthorized alterations can make it unsafe. Do not alter any part or add or substitute any parts or accessories not manufactured by SIG SAUER for this pistol. The addition of any parts or accessories beyond the user level of maintenance described in this manual is not authorized.



WARNINGS

1.0 SAFETY WARNINGS – CONTINUED

ACCESSORIES

It is your responsibility to ensure that all accessories, such as slings and firearm-mounted lights, are compatible with this firearm and that the accessories do not interfere with the safe operation and handling of the firearm.

TRANSPORTING

When transporting your firearm, be sure the firearm is unloaded and cleared of all ammunition. It is your responsibility to familiarize yourself with the laws of any state you will be traveling through with your firearm.

STORAGE

The only safe way to store your firearm is unloaded, cleared of all ammunition, and secure. Safe and secure storage is one of your most important responsibilities. Store your unloaded firearm separate from your ammunition and in places inaccessible to children or unauthorized persons.

CHAMBER SAFETY FLAG

Every SIG SAUER firearm is shipped with a chamber safety flag. The chamber safety flag prevents the chambering of a round when installed and provides a readily visible indication that the firearm's chamber is empty. The chamber safety flag is to be installed in the firearm's chamber at all times when the firearm is not in use. Many public ranges require chamber safety flags be installed when the firing line is cold.



WARNINGS

SIG SAUER

LIABILITY

PISTOLS are classified as FIREARMS and are sold by SIG SAUER with the specific understanding that we shall not be responsible in any manner whatsoever for malfunctioning of the firearm, physical injury, or property damage resulting in whole or in part from:

- Criminal or negligent discharge
- Improper, careless, or abusive handling
- Unauthorized modifications or parts replacement
- Defective, improper, hand-loaded, or reloaded ammunition
- Corrosion
- Neglect
- Other influences beyond our direct and immediate control

This limitation applies regardless of whether liability is asserted on the basis of contract, negligence, or strict liability (including any failure to warn). Under no circumstance shall SIG SAUER, Inc. be liable for incidental or consequential damages such as loss of use of property, commercial loss, and loss of earnings or profits.



WARNINGS

BASIC RULES OF SAFE FIREARMS HANDLING

1. ALWAYS treat every firearm as if it were loaded.
2. ALWAYS be sure the barrel is clear of any obstruction.
3. ALWAYS be sure of your backstop, what lies beyond, and the safety of bystanders before you shoot.
4. ALWAYS use clean, dry, original factory-made ammunition of the proper type and caliber for your firearm.
5. ALWAYS wear ear protection and safety glasses when shooting.
6. ALWAYS carry your firearm so that you can control the direction of the muzzle if you fall or stumble.
7. NEVER shoot at a flat surface or water.
8. DO NOT leave a loaded firearm unattended. Firearms and ammunition should be stored separately, locked if possible, beyond the reach of children, careless adults, or unauthorized users.
9. NEVER allow your firearm to be used by anyone who has not read and understood this operators manual.
10. DO NOT point any firearm, loaded or unloaded, at any undesired or unsafe target.
11. NEVER discharge your firearm near an animal unless the animal is trained to accept the noise. An animal's startled reaction could injure it or cause an accident.
12. NEVER drink alcoholic beverages or use drugs before or during shooting, as your vision and judgment could be seriously impaired, making your firearm handling unsafe.



WARNINGS

SIGSAUER

1.1 EYE AND EAR PROTECTION



Always wear safety glasses that meet the requirements of American National Standards Institute (ANSI) z87.1 and ear plugs and “ earmuff ”-type protectors whenever you are shooting. Always make certain that persons close to you are similarly protected. Unprotected eyes may be injured by powder, gas, carbon residue, lubricant, metallic particles, or similar debris that may emanate occasionally from any firearm in normal use. Without ear protection, repeated exposure to shooting noise may lead to cumulative, permanent hearing loss.

1.2 AMMUNITION

Use only high-quality, original, factory-manufactured ammunition. Do not use cartridges that are dirty, wet, corroded, bent, or damaged. Do not oil cartridges. Do not spray aerosol-type lubricants, preservative, or cleaners directly onto cartridges or where excess spray may flow into contact with cartridges. Lubricant or other foreign matter on cartridges can cause potentially dangerous ammunition malfunctions. Use only ammunition of the caliber for which your firearm is chambered. The proper caliber is permanently engraved on your firearm; never attempt to use ammunition of any other caliber.

The use of reloaded, “re-manufactured” hand-loaded, or other nonstandard ammunition voids all warranties. Reloading is a science and improperly loaded ammunition can be extremely dangerous.



WARNINGS

1.2 AMMUNITION – CONTINUED

Severe damage to the firearm and serious injury or death to the shooter or to others may result. Always use ammunition that complies with the industry performance standards established by the Sporting Arms and Ammunition Manufacturers' Institute, Inc. (SAAMI) or ammunition manufactured to U.S. military specifications.

SIG SAUER, Inc. specifically disclaims responsibility for any damage or injury whatsoever occurring in connection with, or as a result of, the use in any SIG SAUER firearm of faulty, nonstandard, "re-manufactured" hand-loaded (reloaded) ammunition, or cartridges other than those for which the firearm was originally chambered.

Firearms may be severely damaged and serious injury or death to the shooter or to others may result from any condition causing excessive pressure inside the chamber or barrel during firing. Excessive pressure can be caused by obstructions in the barrel, propellant powder overloads, the use of incorrect cartridges, or defectively assembled cartridges. In addition, the use of a dirty, corroded, or damaged cartridge can lead to a burst cartridge case and consequent damage to the firearm and personal injury from the sudden escape of high-pressure propellant gas within the firearm's mechanism.

OBSTRUCTED BORE

Immediately stop shooting, keep the pistol pointed in a safe direction whenever:

- You have difficulty in, or feel unusual resistance in, chambering a cartridge;
- A cartridge misfires (does not go off);
- The mechanism fails to extract a fired cartridge case;
- Unburned grains of propellant powder are discovered spilled in the mechanism;



WARNINGS

SIG SAUER

- A shot sounds weak or abnormal. It is possible that a bullet is lodged part way down the barrel.
- Firing a subsequent bullet into the obstructed barrel can damage the firearm and cause serious injury to the shooter or to bystanders.

Bullets can become lodged in the barrel when:

- The cartridge has been improperly loaded without propellant powder, or if the powder fails to ignite (ignition of the cartridge primer alone will push the bullet out of the cartridge case, but usually does not generate sufficient energy to expel the bullet completely from the barrel);
- The bullet is not properly seated in the cartridge case. When such a cartridge is extracted from the chamber without being fired, the bullet may be left behind in the bore at the point where the rifling begins. Subsequent chambering of another cartridge may push the first bullet further into the bore.

If there is any reason to suspect that a bullet is obstructing the barrel, immediately unload and clear the firearm. Field strip the pistol and look through the bore of the barrel. It is not sufficient to merely look in the chamber. A bullet may be lodged some distance down the barrel where it cannot easily be seen.

If a bullet is in the bore, do not attempt to shoot it out by using another cartridge or by blowing it out with a blank or a cartridge from which the bullet has been removed. Such techniques can generate excessive pressure, damage the firearm, and cause serious personal injury or death.

If the bullet can be removed by tapping it with a cleaning rod, clean any unburned powder grains from the bore, chamber, and mechanism, before resuming shooting. If the bullet cannot be dislodged by tapping it with a cleaning rod, take the firearm to a gunsmith or certified SIG SAUER Armorer.



WARNINGS

1.2 AMMUNITION – CONTINUED

Dirt, corrosion, or other foreign matter on a cartridge can impede chambering and may cause the cartridge case to burst upon firing. A damaged or deformed cartridge may also impede chambering or cause the cartridge case to burst upon firing.

Do not lubricate cartridges, and be sure to wipe the chamber clean of any oil or preservative before shooting. Oil interferes with the friction between cartridge case and chamber wall that is necessary for safe functioning, and subjects the firearm to stress similar to that imposed by excessive pressure.

Use lubricants sparingly on the moving parts of your firearm. Avoid excessive spraying of any aerosol gun care product, especially where it might get on ammunition. All lubricants and aerosol spray lubricants in particular can penetrate cartridge primers and cause misfires. Some highly penetrative lubricants can also migrate inside cartridge cases and cause deterioration of the propellant powder; on firing, the powder might not ignite. If only the primer ignites, there is danger that the bullet may become lodged in the barrel.

Death, serious injury, and damage to the firearm can result from the use of wrong ammunition, bore obstructions, powder overloads, or incorrect cartridge components. Always wear shooting glasses and hearing protectors.



WARNINGS

SIG SAUER



WARNING: CANCER AND REPRODUCTIVE HARM—www.P65warnings.ca.gov



DISCHARGING FIREARMS IN POORLY VENTILATED AREAS, CLEANING FIREARMS, OR HANDLING AMMUNITION MAY RESULT IN EXPOSURE TO LEAD AND OTHER SUBSTANCES KNOWN TO THE STATE OF CALIFORNIA TO CAUSE BIRTH DEFECTS, REPRODUCTIVE HARM, AND OTHER SERIOUS PHYSICAL INJURY. MAINTAIN ADEQUATE VENTILATION AT ALL TIMES. WASH HANDS THOROUGHLY AFTER EXPOSURE. SHOOTING OR CLEANING FIREARMS MAY EXPOSE YOU TO LEAD



WARNINGS

1.3 STATE-BY-STATE WARNINGS

Certain states require, by law, that their own specified warning notices, in larger than-normal type be conspicuously included by the manufacturer, distributor, or retail dealer with firearms sold in that state. SIG SAUER sells its products in compliance with applicable laws and regulations. Because our products may be sold in these states, we include the following:



CALIFORNIA: WARNING

Firearms must be handled responsibly and securely stored to prevent access by children and other unauthorized users. California has strict laws pertaining to firearms, and you may be fined or imprisoned if you fail to comply with them. Visit the Web site of the California Attorney General at <https://oag.ca.gov/firearms> for information on firearm laws applicable to you and how you can comply. Prevent child access by always keeping guns locked away and unloaded when not in use. If you keep a loaded firearm where a child obtains and improperly uses it, you may be fined or sent to prison."

If you or someone you know is contemplating suicide, please call the National Suicide Prevention Lifeline at 1-800-273 TALK (8255).



ADVERTENCIA

Las armas de fuego deben manipularse de manera responsable y segura para evitar el acceso de niños y otros usuarios no autorizados. California tiene leyes estrictas relacionadas con armas de fuego, y usted puede ser multado o encarcelado si no las cumple. Visite el sitio web del fiscal general de california en <https://oag.ca.gov/firearms> para obtener información sobre las leyes de armas de fuego que son aplicables y cómo puede cumplirlas. Evite el acceso de niños manteniendo siempre las armas bloqueadas y descargadas cuando no estén en uso. Si mantiene un arma de fuego cargada donde un niño la puede obtener y la usa indebidamente, se le puede multar o enviar a prisión.

Si usted o alguien que conoce está contemplando el suicidio, llame a la Línea Nacional de Prevención del Suicidio al 1-800-273 TALK (8255).



WARNINGS

SIG SAUER

CONNECTICUT:

"UNLAWFUL STORAGE OF A LOADED FIREARM MAY RESULT IN IMPRISONMENT OR FINE."

FLORIDA:

"IT IS UNLAWFUL, AND PUNISHABLE BY IMPRISONMENT AND FINE, FOR ANY ADULT TO STORE OR LEAVE A FIREARM IN ANY PLACE WITHIN THE REACH OR EASY ACCESS OF A MINOR UNDER 18 YEARS OF AGE OR TO KNOWINGLY SELL OR OTHERWISE TRANSFER OWNERSHIP OR POSSESSION OF A FIREARM TO A MINOR OR A PERSON OF UNSOUND MIND."

MAINE:

"ENDANGERING THE WELFARE OF A CHILD IS A CRIME. IF YOU LEAVE A FIREARM AND AMMUNITION WITHIN EASY ACCESS OF A CHILD, YOU MAY BE SUBJECT TO FINE, IMPRISONMENT OR BOTH. KEEP FIREARMS AND AMMUNITION SEPARATE. KEEP FIREARMS AND AMMUNITION LOCKED UP. USE TRIGGER LOCKS."

MARYLAND:

"WARNING: CHILDREN CAN OPERATE FIREARMS WHICH MAY CAUSE DEATH OR SERIOUS INJURY. IT IS A CRIME TO STORE OR LEAVE A LOADED FIREARM IN ANY LOCATION WHERE AN INDIVIDUAL KNEW OR SHOULD HAVE KNOWN THAT AN UNSUPERVISED MINOR WOULD GAIN ACCESS TO THE FIREARM. STORE YOUR FIREARM RESPONSIBLY!"



WARNINGS

MASSACHUSETTS:

“WARNING FROM THE MASSACHUSETTS ATTORNEY

GENERAL: This handgun is not equipped with a device that fully blocks use by unauthorized users. More than 200,000 firearms like this one are stolen from their owners every year in the United States. In addition, there are more than a thousand suicides each year by younger children and teenagers who get access to firearms. Hundreds more die from accidental discharge. It is likely that many more children sustain serious wounds, or inflict such wounds accidentally on others. In order to limit the chance of such misuse, it is imperative that you keep this weapon locked in a secure place and take other steps necessary to limit the possibility of theft or accident. Failure to take reasonable preventative steps may result in innocent lives being lost, and in some circumstances may result in your liability for these deaths.”



WARNINGS

SIG SAUER

MASSACHUSETTS: - Continued

“IT IS UNLAWFUL TO STORE OR KEEP A FIREARM, PISTOL, SHOTGUN OR MACHINE GUN IN ANY PLACE UNLESS THAT WEAPON IS EQUIPPED WITH A TAMPER RESISTANT SAFETY DEVICE OR IS STORED OR KEPT IN A SECURELY LOCKED CONTAINER.”

NEW JERSEY:

“IT IS A CRIMINAL OFFENSE TO LEAVE A LOADED FIREARM WITHIN EASY ACCESS OF A MINOR.”

NEW YORK CITY, NY:

“THE USE OF A LOCKING DEVICE OR SAFETY LOCK IS ONLY ONE ASPECT OF RESPONSIBLE FIREARMS STORAGE. FOR INCREASED SAFETY, FIREARMS SHOULD BE STORED UNLOADED AND LOCKED IN A LOCATION THAT IS BOTH SEPARATE FROM THEIR AMMUNITION AND INACCESSIBLE TO CHILDREN AND OTHER UNAUTHORIZED PERSONS.”



WARNINGS

NORTH CAROLINA:

Any person who resides in the same premises as a minor, owns or possesses a firearm, and stores or leaves the firearm (i) in a condition that the firearm can be discharged and (ii) in a manner that the person knew or should have known that an unsupervised minor would be able to gain access to the firearm, is guilty of a Class 1 misdemeanor if a minor gains access to the firearm without the lawful permission of the minor's parents or a person having charge of the minor and the minor:

- (1) Possesses it in violation of G.S. 14-269.2(b)
- (2) Exhibits it in a public place in a careless, angry, or threatening manner;
- (3) Causes personal injury or death with it not in self defense; or
- (4) Uses it in the commission of a crime.

TEXAS:

"IT IS UNLAWFUL TO STORE, TRANSPORT, OR ABANDON AN UNSECURED FIREARM IN A PLACE WHERE CHILDREN ARE LIKELY TO BE AND CAN OBTAIN ACCESS TO THE FIREARM."

WISCONSIN:

"IF YOU LEAVE A LOADED FIREARM WITHIN THE REACH OR EASY ACCESS OF A CHILD YOU MAY BE FINED OR IMPRISONED OR BOTH IF THE CHILD IMPROPERLY DISCHARGES, POSSESSES, OR EXHIBITS THE FIREARM."

Please check with your licensed retailer, state police, or local police for additional warnings, which may be required by local law or regulation. Such regulations change constantly, and local authorities are in the best position to advise you on such legal matters.



WARNINGS

SIG SAUER

1.4 LOCKING DEVICES



All firearms are originally shipped with a key-operated locking device, except for Custom Works firearms that are shipped with a lockable case.

Although it can help provide secure storage for your unloaded firearm, any locking device can fail.

All firearms are designed to fire if they are loaded and the trigger is pressed.

Therefore, never install the locking device inside the trigger guard or in any way that makes it possible to press the trigger!

Do not leave the keys in the lock.

The ultimate responsibility for secure storage of any firearm must depend upon its owner and his or her individual circumstances.

Firearms should be stored unloaded, in a secure location, separate from their ammunition.

To maximize effectiveness and reduce the chances of malfunction or damage to a firearm, ALWAYS refer to the locking device's manufacturer directions for installation and removal of the device.



WARNINGS

1.5 SAFETY INFORMATION

This operator's manual is designed to assist you in learning how to use and care for your SIG SAUER® firearm properly.

Only when you are certain that you fully understand this manual and can properly carry out its instructions, should you practice loading and firing your firearm with live ammunition. Having a firearm in your possession is a full-time job; you cannot guess and you cannot forget. You must know how to use your firearm safely.

If you have any doubts about your ability to handle or use this firearm safely, you should seek supervised instruction.

The SIG SAUER Academy provides all levels of firearms safety and skill training, from beginner to expert.

For more information contact:



sigsaueracademy.com • (603) 610-3400
Epping, New Hampshire

SAFETY MUST BE THE FIRST AND CONSTANT CONSIDERATION OF EVERY PERSON WHO HANDLES FIREARMS AND AMMUNITION.

For more information about safety, responsible firearms ownership, and shooting sports, contact:
National Rifle Association (NRA) of America
11250 Waples Mill Road, Fairfax, VA 22030-7400 • 1-800-672-3888
nra.com

PAGE INTENTIONALLY LEFT BLANK



Contents

1.0 Safety Warnings	2
1.1 Eye And Ear Protection.	9
1.2 Ammunition.	9
1.3 State-By-State Warnings	14
1.4 Locking Devices	19
1.5 Safety Information	20
2.0 Mechanical Characteristics and Rifle Theory	24
2.1 Rifle Description	24
2.2 Specifications.	24
2.3 Controls and Features	26
2.4 Groups and Assemblies	28
2.5 Cycle of Function.	35
3.0 Operating the SIG M400 SDI.	37
3.1 Preparation before using the firearm.	37
3.2 Selecting Modes of Fire	38
3.3 Clearing the SIG M400 SDI	39
3.4 Loading/Reloading	42
3.5 Firing	45
3.6 Adverse/Special Conditions	46
3.7 Stoppages	48
3.8 SIG M400 SDI Buttstocks	50
4.0 User Level Authorized Preventive Maintenance	53
4.1 Field Strip the SIG M400 SDI	53
5.0 Cleaning and Lubrication.	62
5.1 Cleaning the Bore and Chamber	63

5.2 Cleaning the Bolt Carrier Assembly	65
5.3 Lubrication	66
6.0 Reassembly From Field Strip	70
7.0 Function Check.	80
8.0 DH3 Trigger Adjustment	82
9.0 Troubleshooting	84
9.1 Upper Receiver Assembly Parts Diagram	86
9.2 Lower Receiver Assembly Parts Diagram	88
10.0 Transportation and Storage.	90
11.0 Service and Replacement Parts Policy	92
12.0 Shipping Firearms for Repair	94
SIG SAUER® Limited Lifetime Firearms Warranty	96



2.0 MECHANICAL CHARACTERISTICS AND RIFLE THEORY

2.1 RIFLE DESCRIPTION

2.1.1 GENERAL

The SIG M400 SDI rifle is a direct impingement rifle with a rotary bolt mechanism capable of semi-automatic operation. Semi-Automatic is defined as one round being fired each time the trigger is pressed. SIGM400 SDI rifles are available in three models, the SIG M400 SDI DH3, the SIG M400 SDI Patrol and the SIG M400 SDI Pistol. All three SIG M400 SDI models have a MIL-STD 1913 rail on top of the upper receiver. They are fitted with an aluminum handguard that features a MIL-STD 1913 rail section at the 12 o'clock position and has multiple M-LOK™ attachment points at the 3, 6 and 9 clock positions.

The SIG M400 SDI DH3 features a buttstock adjustable for length of pull, cant and recoil pad height. The barrel has a .223 Wylde chamber and will accept 5.56x45mm NATO and .223 Remington ammunition.

The SIG M400 SDI features a buttstock adjustable for length of pull and features a 5.56x45mm NATO chamber.

2.2 SPECIFICATIONS

All M400 SDI specifications and configurations can be found on-line at sigsauer.com

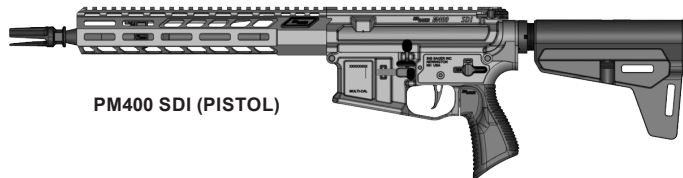

PM400 SDI (PISTOL)

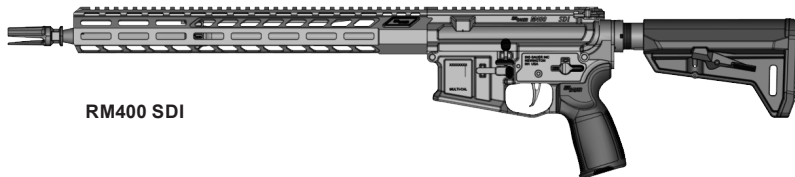

RM400 SDI



RM400 SDI DH3



2.3 CONTROLS AND FEATURES

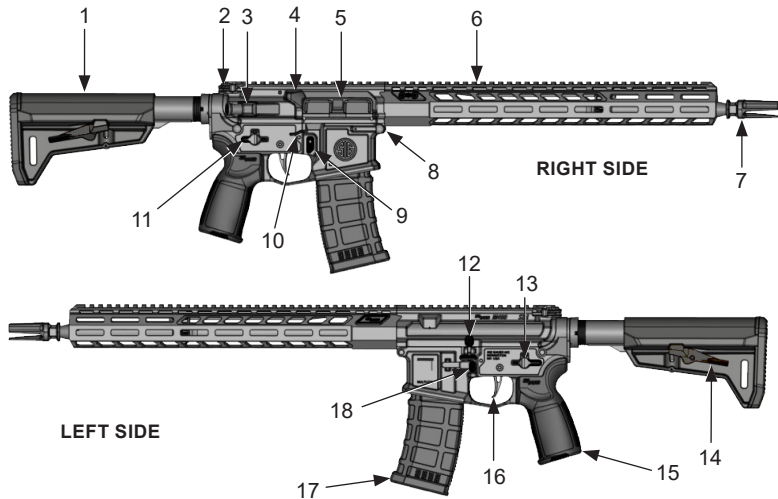

NUMBER	NOMENCLATURE
1	Buttstock
2	Charging Handle
3	Forward Assist
4	Deflector
5	Ejection Port Cover
6	Handguard
7	Flash Hider
8	Pivot Pin
9	Magazine Release Button
10	Bolt Release
11	Ambidextrous Fire Control Selector
12	Bolt Catch
13	Ambidextrous Fire Control Selector
14	Buttstock Lever
15	Grip
16	Trigger
17	Magazine
18	Magazine Release Button



2.4 GROUPS AND ASSEMBLIES

2.4.1 UPPER RECEIVER GROUP

The upper receiver group consists of the following:

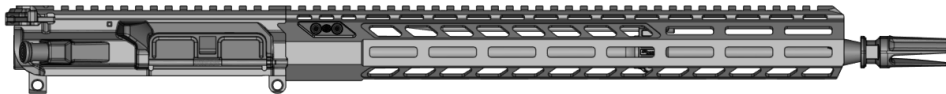

SDI PATROL

A. Ambidextrous Charging Handle Assembly



B. Bolt Carrier Assembly

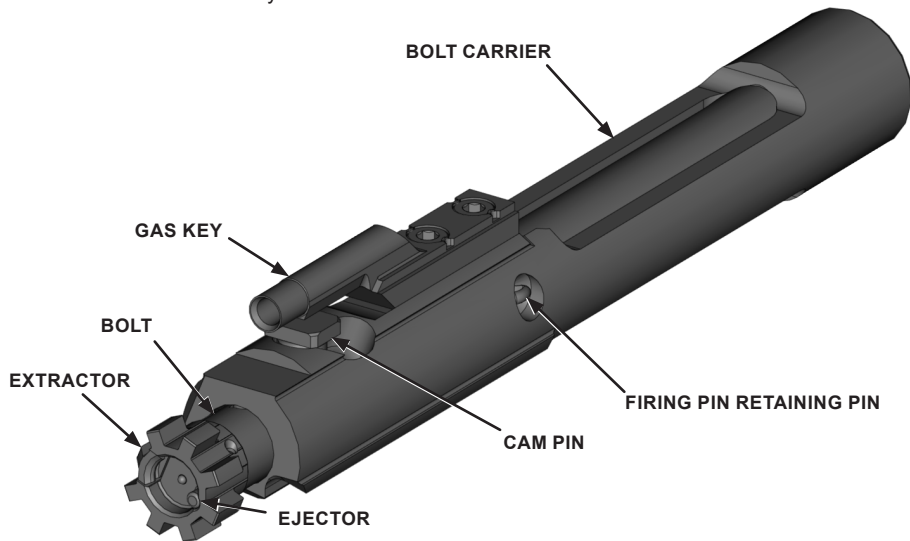



2.4.1 UPPER RECEIVER GROUP – CONTINUED

C. Upper Receiver and Barrel Assembly

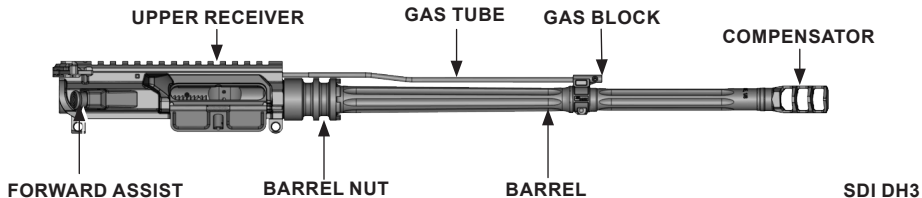
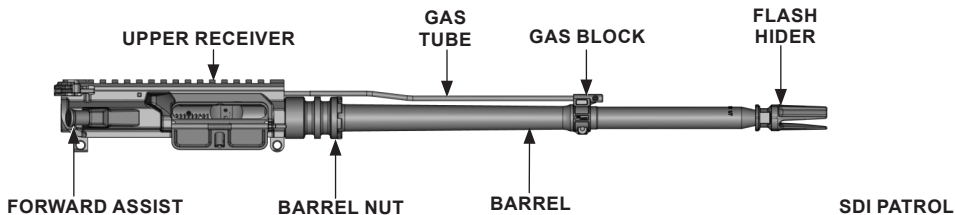

D. Handguard Assembly

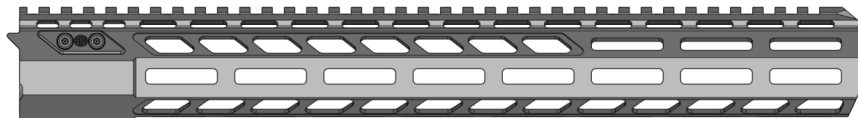

SDI PATROL

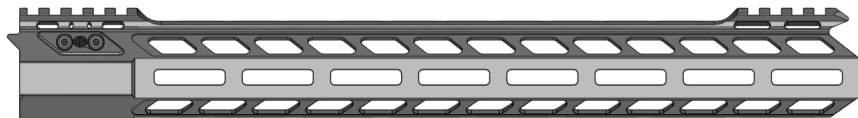

SDI DH3



2.4.2 LOWER RECEIVER GROUP

The Lower Receiver Group consists of the following assemblies: Lower Receiver Assembly with Fire Control Components, Buttstock Assembly, and Grip Assembly.

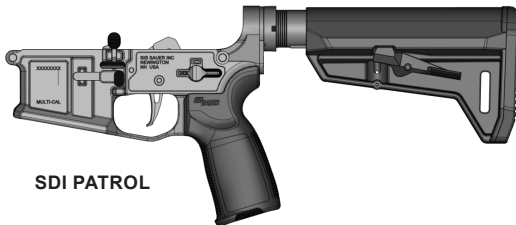

SDI PATROL

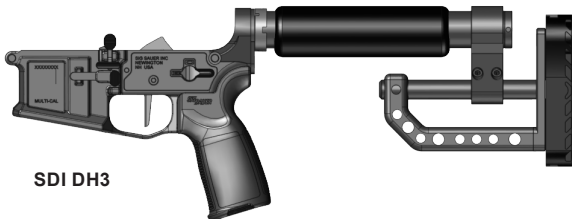

SDI DH3

A. Lower Receiver Assembly

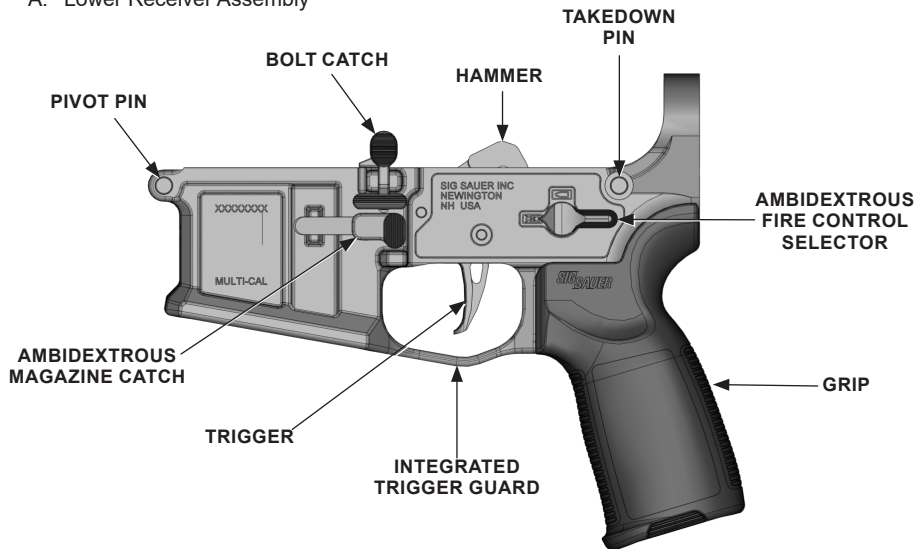



2.4.2 LOWER RECEIVER GROUP – CONTINUED

B. Buttstock Assembly.

SDI PATROL

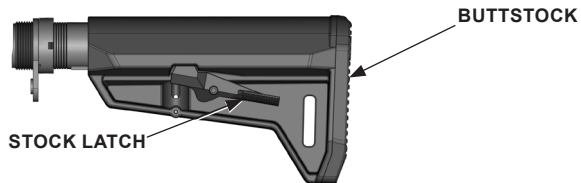

SDI DH3

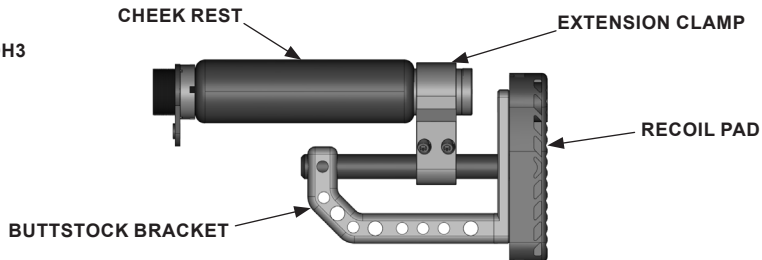

2.5 CYCLE OF FUNCTION

There are eight steps in the cycle of function of the SIG M400 SDI which begin after a loaded magazine is inserted into the firearm.

FEEDING

As the bolt carrier is released from its rearward position, the carrier group moves forward allowing the lower lugs of the bolt to make contact with the rear of the cartridge as it sits in the magazine. The cartridge is stripped from the magazine and begins its forward movement toward the chamber.

CHAMBERING

As the bolt moves forward, the bolt locking lugs move forward into the barrel extension. The ejector is then compressed against the left side of the cartridge head. The last action that occurs is the extractor snapping over the rim of the cartridge case.

LOCKING

The movement of the bolt and the cartridge is stopped by the chamber. The bolt carrier continues to move forward until it is stopped by contact with the rear face of the barrel extension. As the carrier goes through the last portion of movement, the bolt is rotated to the left, through the action of the cam slot in the carrier and the cam pin through the bolt. This engages the bolt lugs with the barrel extension lugs to lock the bolt into the barrel extension.

FIRING

The fire control selector is rotated to the SEMI position. The trigger is pressed and the hammer is released. The hammer spring drives the hammer forward unlocking the firing pin. The firing pin strikes the cartridge primer, causing detonation.



2.5 CYCLE OF FUNCTION – CONTINUED

UNLOCKING

As the bullet passes the gas port in the barrel, a small amount of gas is bled off, traveling up through the gas port and into the gas block. The gas travels through the gas tube to the carrier key of the bolt carrier. This gas then begins the rearward movement of the bolt carrier causing the cam pin to rotate the bolt to the unlocked position.

EXTRACTION

As the bolt carrier assembly moves rearward the spent case is pulled free from the chamber by the extractor. The twisting motion of the bolt aids in the extraction from the chamber.

EJECTION

The extractor continues to grip the rim of the spent case on the right side. The ejector is applying forward pressure to the left side of the case. As the expended case clears the chamber, then the barrel extension, it is flipped out through the ejector port on the right side of the receiver.

COCKING

The rearward movement of the bolt carrier overrides the hammer, forcing it down into the receiver and compressing the hammer spring, cocking the hammer in the firing position.

3.0 OPERATING THE SIG M400 SDI

3.1 PREPARATION BEFORE USING THE FIREARM.

Ensure you have read, understand, and are capable of following all the safety warnings on pages 2-19 of this manual in addition to the safety rules, regulations, procedures or guidelines of your club or local shooting range.

Prior to using the firearm it is strongly suggested to field strip the firearm and clean any fouling that might have occurred during factory testing. Then inspect, lubricate, and reassemble the firearm. Upon reassembly and prior to firing the rifle, conduct the function check. Refer to sections, "4.0 User Level Authorized Preventive Maintenance" on page 53 through "7.0 Function Check" on page 80.

Any maintenance beyond the user level described in this manual is to be performed by a certified SIG SAUER Armorer specifically trained on the maintenance of the SIG M400 in accordance with the SIG SAUER M400 Technical Armorer's Manual.



3.2 SELECTING MODES OF FIRE

The SIG M400 SDI has two fire control modes SAFE and SEMI. Fire control modes are selected by rotating the fire control selector to the desired position. The SAFE position prevents the firearm from firing by blocking the action of the trigger. The SEMI position is for the semi-automatic mode and allows the firing of one round each time the trigger is pressed.

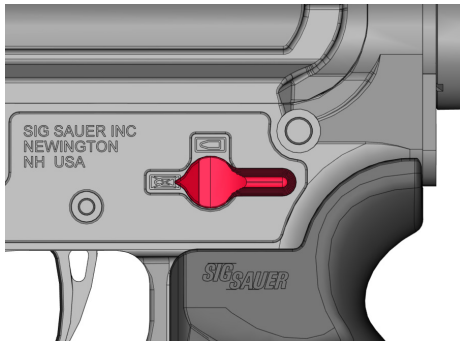

SAFE

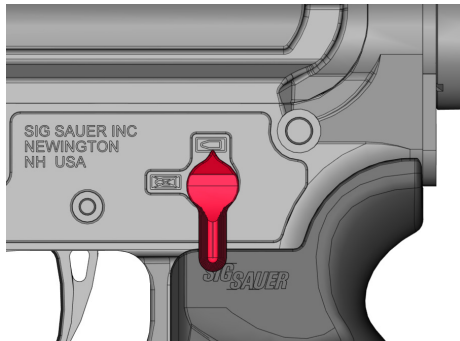

SEMI

3.3 CLEARING THE SIG M400 SDI

1. Ensure the muzzle of the firearm is pointed in a safe direction at all times while clearing the firearm.
2. Remove the magazine from the firearm by pressing the magazine catch and simultaneously pulling the magazine from the receiver.

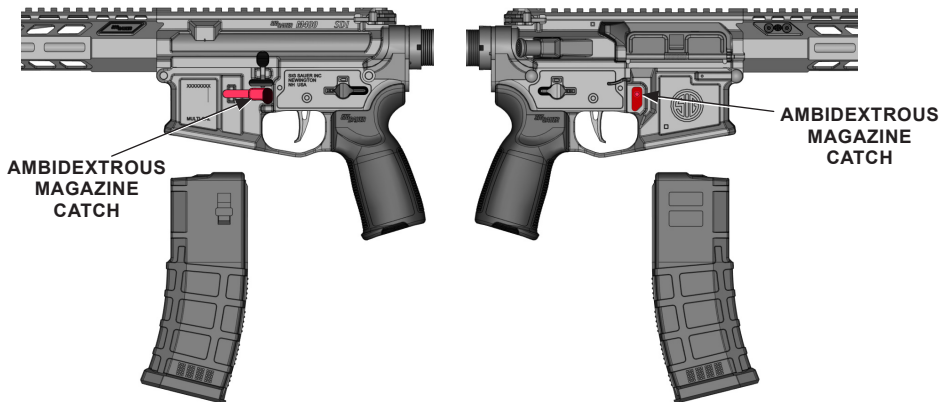



3.3 CLEARING THE SIG M400 SDI – CONTINUED

3. Push up on right bolt catch or inward on bottom of left bolt catch, and hold in place.
4. Pull charging handle completely to rear and release. Bolt carrier assembly will remain locked to rear.
5. Return charging handle to forward locked position.
6. Rotate fire control selector to SAFE.

**CHARGING
HANDLE**

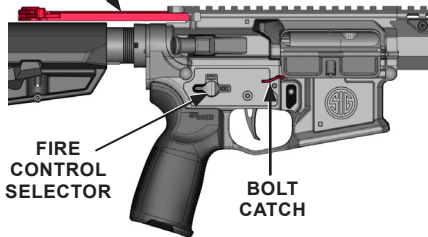

SDI PATROL RIGHT SIDE

**CHARGING
HANDLE**

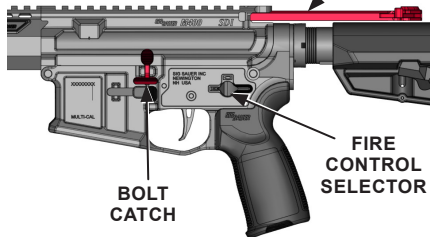

SDI PATROL LEFT SIDE

**WARNING PARTS UNDER SPRING TENSION**

THE BOLT CARRIER ASSEMBLY IS UNDER SPRING TENSION AND WILL SPRING FORWARD IF THE BOLT CATCH IS PRESSED POSSIBLY CAUSING INJURY. DO NOT ALLOW THE BOLT CATCH TO BE PRESSED.

7. Inspect the chamber, bolt face, and magazine well to ensure that there are no live rounds or spent cartridges present.

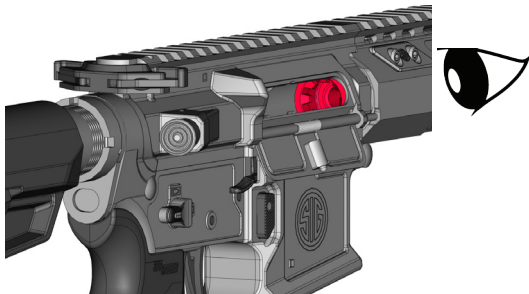

8. If passing the firearm to another person, allow that person to inspect the chamber before handling the firearm. Pass the firearm with the bolt locked to the rear and the fire control selector on SAFE.



3.4 LOADING/RELOADING

3.4.1 LOADING/BOLT LOCKED TO THE REAR

1. Push up on right bolt catch or inward on bottom of left bolt catch, and hold in place.
2. Pull charging handle completely to rear and release. Bolt carrier assembly will remain locked to rear.
3. Return charging handle to forward locked position.
4. Rotate fire control selector to SAFE.
5. Visually and physically inspect the chamber, bolt face, and magazine well to ensure it is clear.
6. Insert a loaded magazine until it engages and is held by magazine catch. Always pull down to ensure magazine is seated properly.
7. Push down on right bolt catch or inward on top of left bolt catch to release bolt carrier assembly forward chambering a live cartridge.
8. If firearm is not to be fired immediately close the ejection port cover.

3.4.2 LOADING/BOLT FORWARD

1. Insert a loaded magazine until it engages and is held by magazine catch. Always pull down to ensure the magazine is seated properly.
2. Grasp the charging handle and pull it completely to rear.
3. Release charging handle, allowing it to move forward under full spring pressure. (DO NOT RIDE IT FORWARD).
4. Rotate fire control selector to SAFE.
5. If firearm is not to be fired immediately close the ejection port cover.

3.4.3 RELOADING (EXPENDED MAGAZINE/BOLT LOCKED TO THE REAR)

1. Rotate fire control selector to SAFE.
2. Press magazine catch from either the left or right side. Magazine should fall free from magazine well.
3. Insert a loaded magazine until it engages and is held by magazine catch. Pull down to ensure magazine is seated properly.
4. Press, down on right bolt catch or inward on top of left bolt catch to release bolt carrier assembly forward chambering a live cartridge.
5. If firearm is not to be fired immediately close the ejection port cover.



3.4.4 RELOADING (MAGAZINE PARTIALLY EXPENDED/BOLT FORWARD, LIVE ROUND CHAMBERED)

1. Rotate fire control selector to SAFE.
2. Grasp magazine and press magazine catch from either left or right side.
3. Remove partially loaded magazine and secure it.
4. Insert a loaded magazine until it engages and is held by magazine catch. Pull down to ensure magazine is seated properly.

3.5 FIRING

SEMI: When fire control selector is rotated to this position, one press of trigger will result in a single round being fired. The trigger must be released to reset.

To fire the SIG M400 SDI:

1. Deploy/Adjust buttstock, if not already done.
2. Insert a loaded magazine into magazine well, charge firearm and rotate fire control selector to SAFE.
3. Face target, placing firearm to your shoulder.
4. Rotate fire control selector from SAFE to SEMI.
5. Pressing trigger releases hammer causing cartridge to be fired.



3.6 ADVERSE/SPECIAL CONDITIONS

Desert (Hot/Dry)

- Apply light lubrication to internal metal-on-metal moving parts only. If available use dry graphite lubricant.
- Increase frequency of inspection and cleaning of firearm due to blowing dust and sand. Use muzzle covers if available.
- Unload and clean ammunition and inside of magazines daily. Do not lubricate magazine.
- Cover firearm when not in use.
- Close the ejection port cover when not in use.

NOTE

Remove O-Ring from extractor assembly when operating in or below -20°F.

Arctic (Extreme Cold/Sub-Freezing)

- When operating in sub-freezing temperatures, use a lubricant designed for use in this climate. Do not use CLP, as it can prevent the firearm from firing. Ensure that all existing lubricants are thoroughly removed prior to applying cold weather lubricant.
- Avoid bringing firearm into heated shelters or buildings to prevent condensation from forming on moving parts which will freeze when the firearm is brought back outdoors.
- If you must bring the firearm indoors, allow it to warm to room temperature and then disassemble and clean thoroughly, ensuring that all moisture is removed from the firearm. Re-lubricate the firearm.

- When operating in snowy environments, conduct frequent inspection of the firearm to ensure that snow has not gotten into operating parts. Work the action to ensure it is not frozen. Use muzzle covers if available.
- If the bolt carrier becomes frozen with snow/moisture, DO NOT discharge the firearm to free the bolt carrier. Warm the firearm using body heat or bring indoors until free movement is restored, and then clean and re-lubricate the firearm.

Jungle (Hot/Humid)

- Increase frequency of inspection and cleaning of the firearm for rust/corrosion.
- Apply thin coat of lubricant on steel parts frequently.
- Inspect hidden surfaces of bolt and carriage assembly, upper receiver, chamber and barrel extension (locking lugs).
- Inspect the lower receiver for corrosion.
- Inspect and lubricate the spring-loaded detents of the firearm.
- Unload magazine, clean ammunition, and inspect the inside of magazines daily for corrosion.
- Wipe ammunition dry before reloading.



3.7 STOPPAGES

If the SIG M400 SDI stops firing apply IMMEDIATE action:

1. Slap up on bottom of magazine.
2. Pull charging handle completely rearward.
3. Observe ejection of case/cartridge and check chamber for any obstruction.
4. Release charging handle to feed a new cartridge.
5. Tap the forward assist to ensure round is chambered and bolt is locked.
6. Press trigger and attempt to fire rifle.

If the SIG M400 SDI still fails to fire upon completion of the above steps apply REMEDIAL action:

1. Check chamber for a stuck case.
2. If a case is present, separate receivers and remove bolt carrier assembly.
3. Attempt to tap out the case with cleaning rod from the muzzle end of the barrel. If firearm still fails to fire, refer to section, "9.0 Troubleshooting" on page 84.

PAGE INTENTIONALLY LEFT BLANK



3.8 SIG M400 SDI BUTTSTOCKS

3.8.1 DH3 BUTTSTOCK

The SIG M400 SDI DH3 buttstock is adjustable for length of pull and angle of buttstock.

1. Use a 3/16 hex key to loosen extension clamp screws. Once loosened, buttstock bracket can be moved to the desired length of pull and cant.

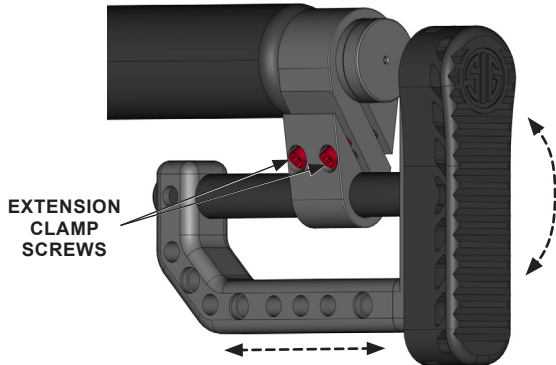

2. Push and hold button to adjust recoil pad vertically.

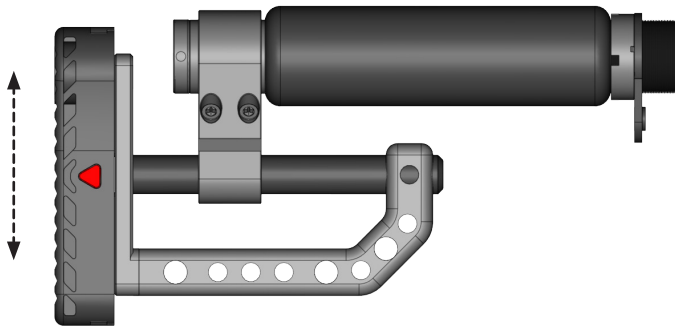



3.8.2 PATROL BUTTSTOCK

The SIG M400 features a 6 position telescoping stock to accommodate different lengths of pull. To adjust stock pull up on stock latch and slide the stock to desired position then release latch. Once the stock is positioned, attempt to push stock back and forth to ensure stock latch is engaged.

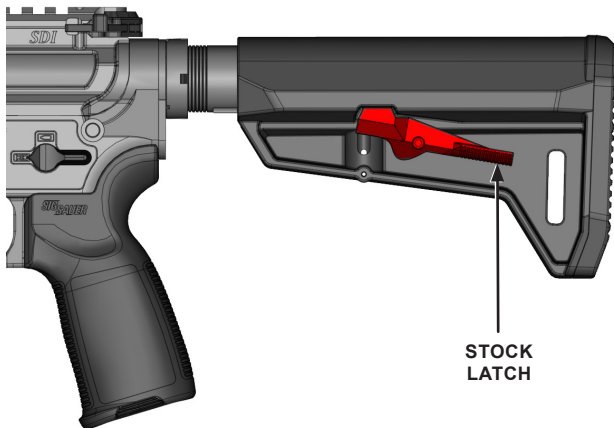

4.0 USER LEVEL AUTHORIZED PREVENTIVE MAINTENANCE

4.1 FIELD STRIP THE SIG M400 SDI

1. Unload and clear the firearm. See section “3.3 Clearing the SIG M400 SDI” on page 39. Ensure fire control selector is on SAFE.
2. Remove sling if attached.
3. Push takedown pin from left to right until stopped by detent.

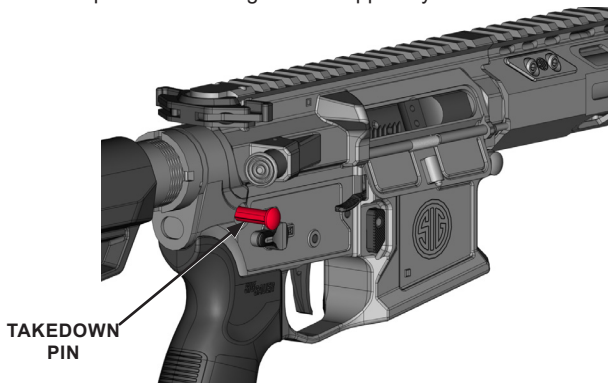



4.1 FIELD STRIP THE SIG M400 SDI – CONTINUED

4. Swing apart receivers.



5. Retract charging handle until it stops. Grasp bolt carrier assembly and pull from upper receiver. It will come out as a complete unit.





4.1 FIELD STRIP THE SIG M400 SDI – CONTINUED

6. Remove charging handle.

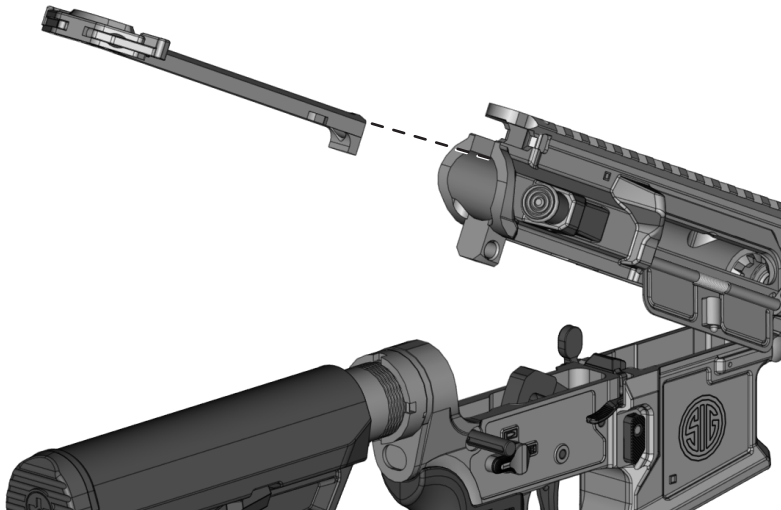

7. Close receivers together and push pivot pin from left to right then separate receivers.

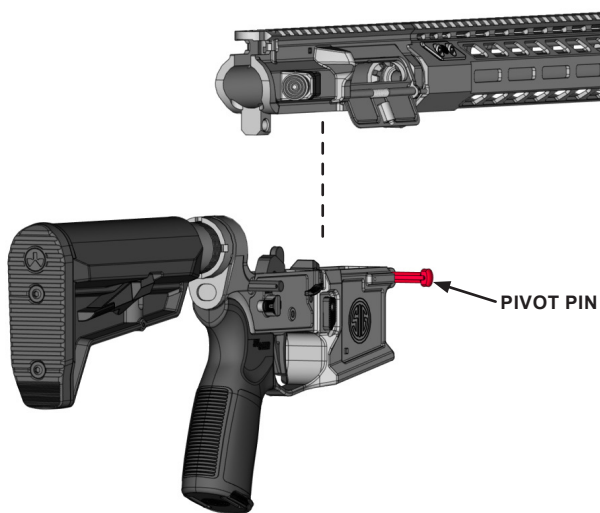



4.1 FIELD STRIP THE SIG M400SDI – CONTINUED

8. Remove firing pin retaining pin from bolt carrier then remove firing pin.

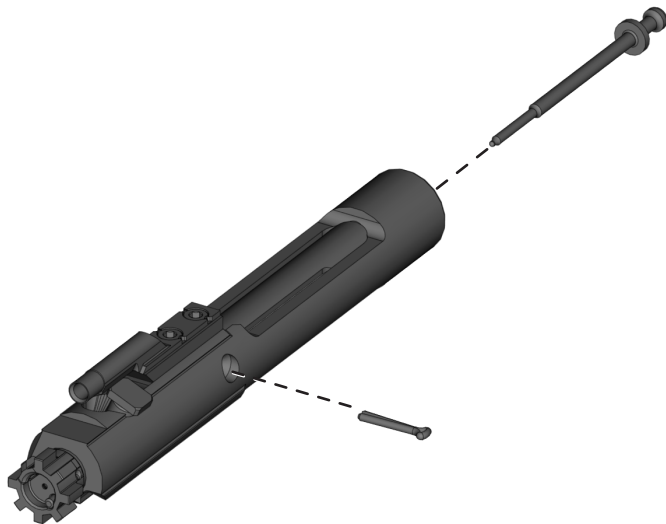

9. Rotate cam pin and remove from bolt carrier.
10. Remove bolt from bolt carrier.

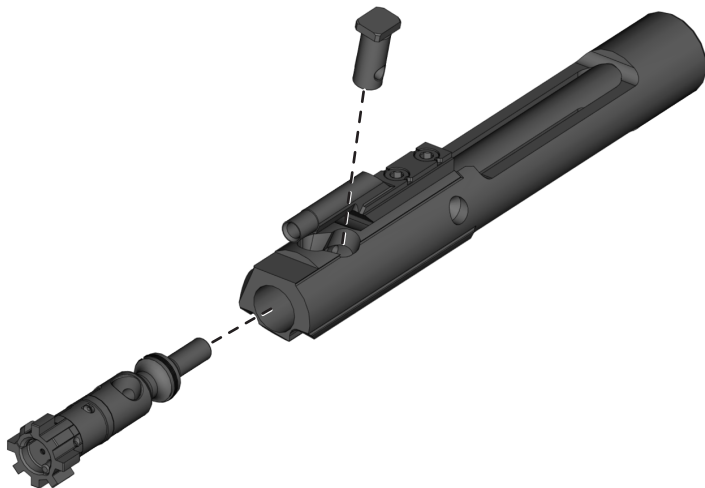



4.1 FIELD STRIP THE SIG M400 SDI – CONTINUED

11. Push the extractor pin out and remove the extractor from the bolt. Do not remove the O-ring (if applicable), extractor spring or the extractor insert unless replacement is necessary.

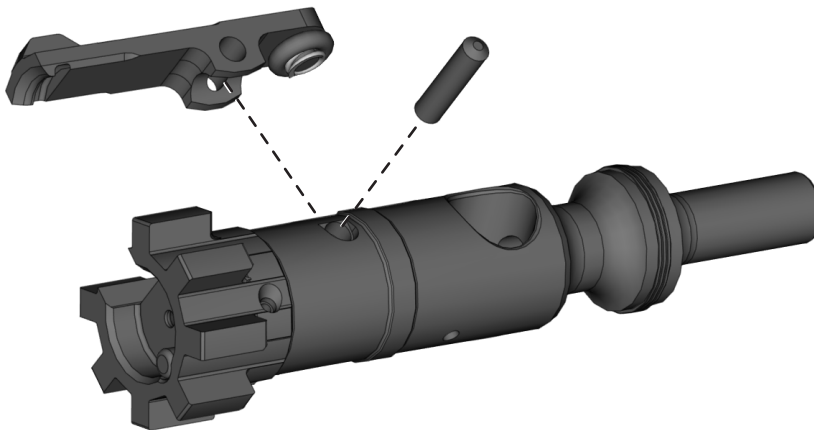

12. Press the buffer retainer and remove the buffer assembly and action spring.

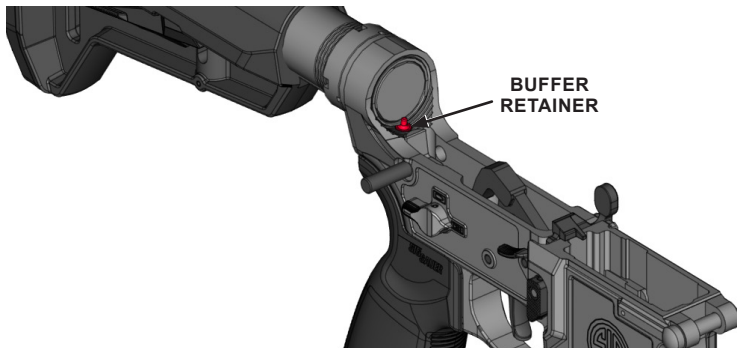

13. Separate the buffer from the action spring.





5.0 CLEANING AND LUBRICATION

- Use only cleaning and lubrication products specifically designed for use on firearms.
- Do not use wire brushes on aluminum surfaces such as the upper/lower receivers, because this can scratch the finish.
- Follow all manufactures instructions and cautions when using cleaning and lubrication products.
- Wherever the term CLP (Cleaner-Lubricant-Protectant) or the words lube or lubrication are used in this manual, it is interpreted to mean that you can use any lubricant designed for use on firearms.
- A rag moistened with CLP can be used to wipe residue from parts.
- Wherever propellant gases directly contact operating system parts, carbon will build up. Carbon cannot be removed with a brush and must be scraped.

5.1 CLEANING THE BORE AND CHAMBER

Military sectional cleaning rods if used improperly can be damaged and cause damage to the barrel of the SIG M400. The following steps should be adhered to which will ensure extended use of the cleaning rod assembly. Attempting to push the cleaning rod assembly through the bore from the chamber end could result in the cleaning rod being bent and the metal jag end damaging the chamber and bore.

1. Assemble the rod sections and the jag end to the proper length.
2. Attach a clean patch to the jag.
3. Drop the female end of the cleaning rod through the bore from the chamber end.
4. Attach the cleaning rod handle to the female rod end.
5. Apply a coat of CLP or rifle bore cleaner to the patch and slowly pull it through the bore toward the muzzle end.
6. Allow the CLP to sit in the barrel to loosen any fouling.
7. Clean all residue from the bolt, bolt carrier, and cam pin with CLP.
8. Attach a new clean patch to the cleaning rod.
9. Coat the patch as before and pull through the bore from the chamber end as you did with the first patch.
10. Remove the cleaning rod handle and attach the bore brush to the cleaning rod end.



5.1 CLEANING THE BORE AND CHAMBER – CONTINUED

11. Pull the brush through the bore several times to loosen any remaining residue.
12. Pull another patch through the bore with CLP or bore cleaner to remove any heavy residue loosened by the bore brush.
13. Pull new patches through the bore until they come out clean. You should not have to attach the cleaning rod handle to do this.
14. Attach the chamber brush to the rod handle end. Slide a rod section through the hole in the handle to form a T-handle.
15. Coat the chamber brush with CLP or bore cleaner.
16. Keep the muzzle elevated so the CLP does not run into your freshly cleaned bore.
17. Make several plunging strokes followed by several 360 degrees rotations in the barrel extension to clean the locking lug area.

5.2 CLEANING THE BOLT CARRIER ASSEMBLY

- A. Clean the bolt carrier of residue.
- B. Clean the cam pin of carbon build up.
- C. Wipe down the firing pin.
- D. Wipe down firing pin retaining pin.
- E. Clean carbon buildup from bolt channel.
- F. Clean bolt body of residue.
- G. Clean hook of extractor.
- H. Clean any carbon from bolt lugs.
- I. Wipe down extractor pin.

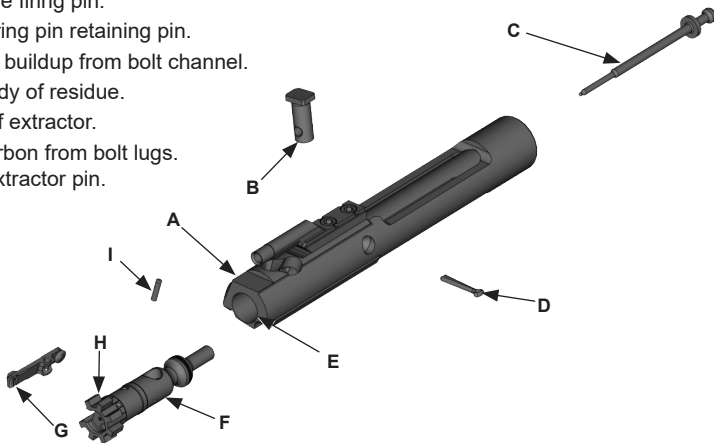



5.3 LUBRICATION

Carriage Assembly

- A. Apply 1 to 2 drops of lubricant to the cam pin, extractor spring and extractor pin.
- B. Apply a thin layer of lubricant to the bearing surfaces of the bolt, rear of bolt lugs and bolt carrier.
- C. Do not lubricate the face of the bolt.

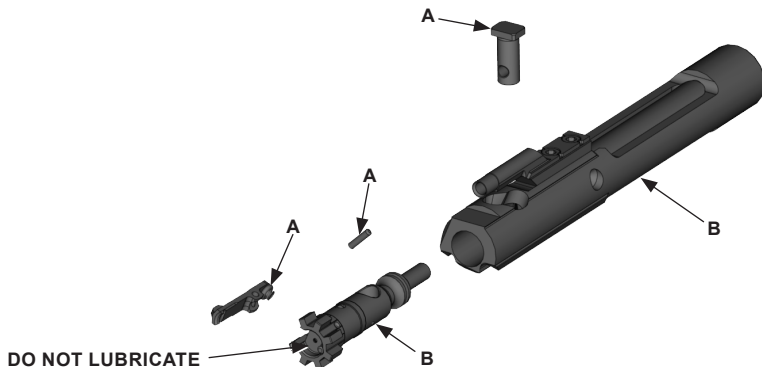

Upper Receiver

- A. Apply a thin film of lubricant to the inside of the upper receiver on the surfaces where the carrier assembly makes contact.
- B. Apply a thin film of lubricant to the sides of the charging handle.
- C. Apply 1 to 2 drops of lubricant to the charging handle latches.

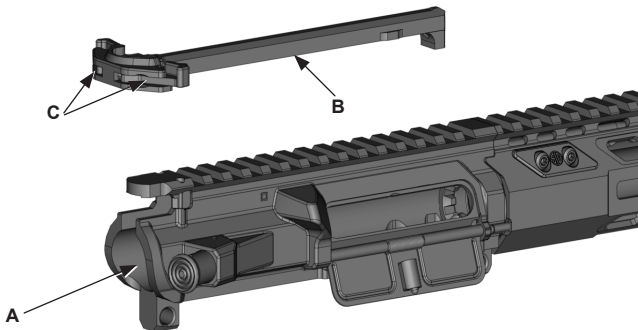



5.3 LUBRICATION – CONTINUED

Lower Receiver

- A. Apply 1 to 2 drops of lubricant to the hammer, trigger, and bolt catch where these parts contact their respective pins.
- B. Apply 1 to 2 drops of lubricant to the fire control selector where it contacts the lower receiver.
- C. Apply 1 to 2 drops of lubricant to the buffer retainer, pivot and takedown pins.
- D. Apply a thin coat of lubricant to the buffer and action spring.

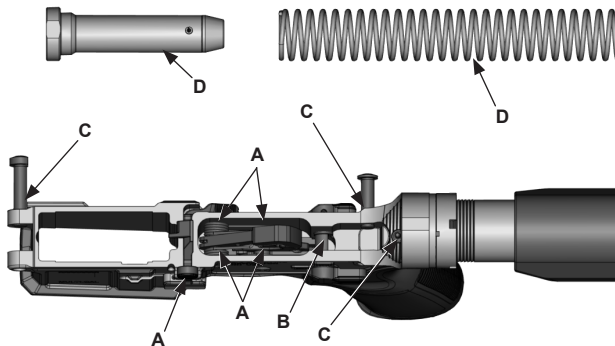

PAGE INTENTIONALLY LEFT BLANK



6.0 REASSEMBLY FROM FIELD STRIP

1. Place extractor back into bolt body. Press rear portion of extractor and insert extractor pin into slot in bolt body, ensure extractor pin is centered in bolt body.

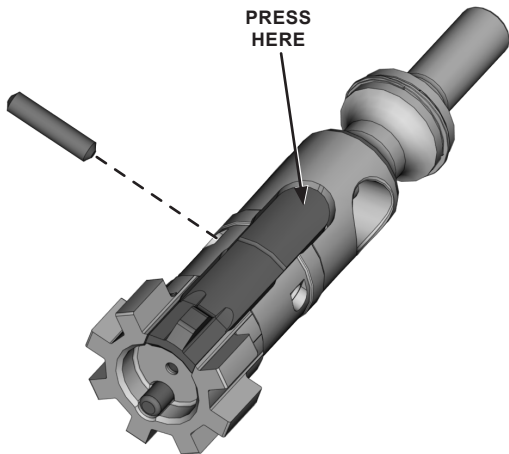

2. Insert the bolt into the bolt carrier with extractor oriented as shown below.

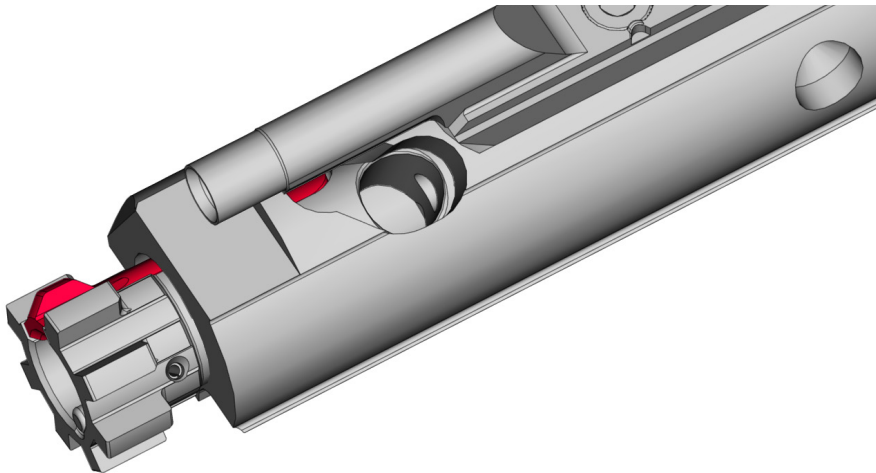



6.0 REASSEMBLY FROM FIELD STRIP – CONTINUED



WARNING PHYSICAL INJURY/DAMAGE



ATTEMPTING TO FIRE RIFLE WITHOUT CAM PIN INSTALLED MAY RESULT IN INJURY OR DEATH TO THE USER AND CATASTROPHIC DAMAGE TO THE FIREARM.

3. Install cam pin through bolt carrier and into bolt body.

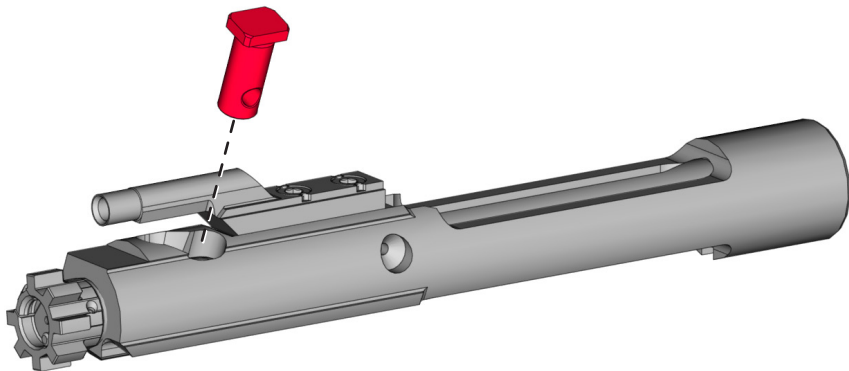

4. Pull the bolt out to unlocked position, and rotate cam pin to align firing pin through holes.

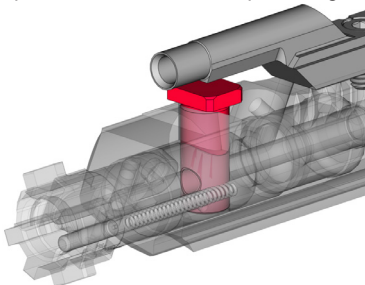

5. Slide the firing pin and spring into the rear of the bolt until it stops.

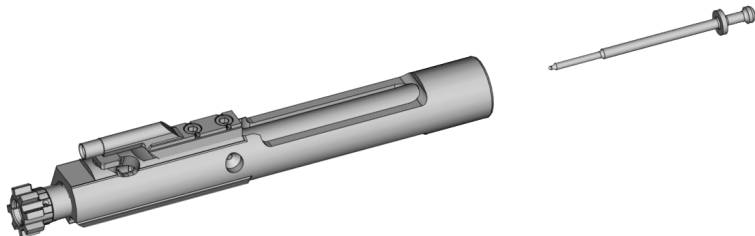



6.0 REASSEMBLY FROM FIELD STRIP – CONTINUED

6. Align slot of firing pin retaining pin vertically then insert into left side of bolt carrier. Ensure retaining pin is positioned behind large flange of firing pin.

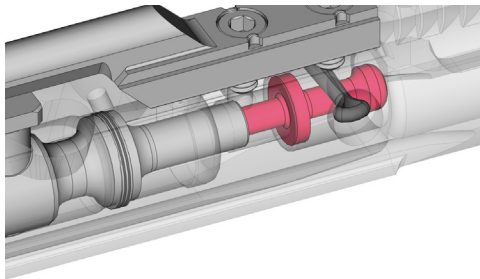
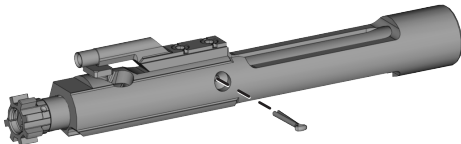

7. Slide action spring over recoil buffer and snap into place with a clockwise twisting motion as you press spring forward.
8. Insert action spring into receiver extension. Hammer should be cocked and rifle on SAFE to ease assembly.
9. Push recoil buffer into receiver extension until it snaps behind buffer retainer.





6.0 REASSEMBLY FROM FIELD STRIP – CONTINUED

10. Attach the upper receiver to the lower receiver using the pivot pin.



11. Place the charging handle assembly into the upper receiver so the charging handle lugs align with the recesses in the upper receiver and push the charging handle forward slightly to keep it from falling out.





6.0 REASSEMBLY FROM FIELD STRIP – CONTINUED

12. Pull the bolt to it's forward most position, insert bolt carrier assembly into the upper receiver and push it completely forward.



13. Close the receivers together and push the takedown pin back in place.





7.0 FUNCTION CHECK



WARNING

UNLOAD/CLEAR



**PRIOR TO STARTING THE FUNCTION CHECK ENSURE THE FIREARM IS UNLOADED/
CLEARED AND ON SAFE WITH THE BOLT FORWARD AND LOCKED. FAILURE TO
COMPLY COULD RESULT IN INJURY OR DEATH.**

1. Ensure that the firearm is unloaded/clear.
2. Insert an empty magazine into magazine well.
3. Pull charging handle completely to the rear until bolt locks back. Push charging handle forward to lock.
4. Rotate fire control selector to SAFE.
5. Press magazine catch. Magazine should fall free of magazine well.
6. Retract and release charging handle. Bolt catch should disengage allowing bolt to go forward.
7. Press trigger to rear. Hammer should not fall.
8. Rotate fire control selector to SEMI.
9. Press and hold trigger to rear. Hammer should fall.
10. Completely retract charging handle, cocking firearm.
11. Slowly release the trigger. You should hear an audible click.
12. Rotate fire control selector to SAFE.

PAGE INTENTIONALLY LEFT BLANK



8.0 DH3 TRIGGER ADJUSTMENT

Tools needed:

- 5/64 hex wrench
- Pull Type Trigger Gauge



WARNING

DO NOT DISASSEMBLE



DO NOT REMOVE THE TWO ROLL PINS THAT LIMIT THE TRAVEL OF THE ADJUSTMENT SCREW. REMOVING THESE SCREWS OR ALTERING THE TRIGGER IN ANY WAY WILL POSE A HAZARDOUS CONDITION THAT COULD RESULT IN DEATH, SERIOUS INJURY, DAMAGE TO PROPERTY, AND VOID THE WARRANTY OF THE FIREARM.

NOTE

The first stage of the DH3 trigger is non-adjustable and factory set at 8 oz. The second stage is adjustable from a minimum of 2 lbs to a maximum of 3.5 lbs, which allows for a total trigger pull weight of 2.5 lbs – 4 lbs. The 2nd stage is set to the lowest adjustment from the manufacturer.

To adjust the second stage (Measure Poundage First)

1. Place the gauge a quarter of an inch from the bottom of the trigger blade.
2. Pull straight back, perpendicular to the face of the trigger.

3. If pull weight is too light, tighten screw a maximum of one turn to reach the maximum pull weight of 4 lbs.
4. If pull weight is too heavy, loosen the screw counterclockwise a minimum of one turn to reach lightest pull weight of 2.5 lbs.
5. Verify pull weight with trigger gauge.

Adjustment Screw

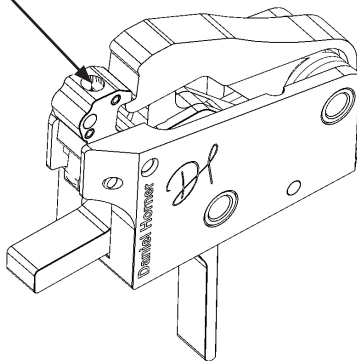



9.0 TROUBLESHOOTING

Stoppage	Test/Inspection	Corrective Action
<i>Fails to fire</i>	Fire control selector on SAFE	Rotate to SEMI
	Improper installation of firing pin	Assembly correctly
	Excessive oil in firing pin recess of bolt	Clean out recess
	Defective ammo	Remove/Discard
<i>Bolt fails to unlock</i>	Dirty bolt	Clean and reinstall
	Burred Bolt Lugs	Contact Customer Service
<i>Failure to feed</i>	Dirty/Corroded ammo	Clean or replace
	Dirty magazine	Clean and replace
	Defective magazine	Replace
	Overloaded magazine	Remove excess rounds
	Magazine not seated	Check mag catch adjustment
	Under function	Contact Customer Service
<i>Double feed</i>	Defective magazine	Replace

Stoppage	Test/Inspection	Corrective Action
<i>Failure to chamber</i>	Dirty/Corroded ammunition	Clean or Replace
	Damaged ammunition	Discard/Replace
	Dirty chamber	Clean
<i>Bolt fails to lock</i>	Dirty bolt lugs	Clean lugs
<i>Failure to extract</i>	Frozen extractor	Remove/clean
	Broken extractor spring	Contact Customer Service
	Restricted movement of bolt carrier	Remove, clean, lube
	Dirty/Corroded ammo	Clean or Replace
	Dirty chamber	Clean
<i>Fails to lock bolt to rear after last round</i>	Faulty magazine	Replace
	Broken bolt catch	Contact Customer Service
<i>Frozen fire control selector</i>	Needs oil	Lubricate
	Dirt/Residue under trigger	Clean



9.1 UPPER RECEIVER ASSEMBLY PARTS DIAGRAM

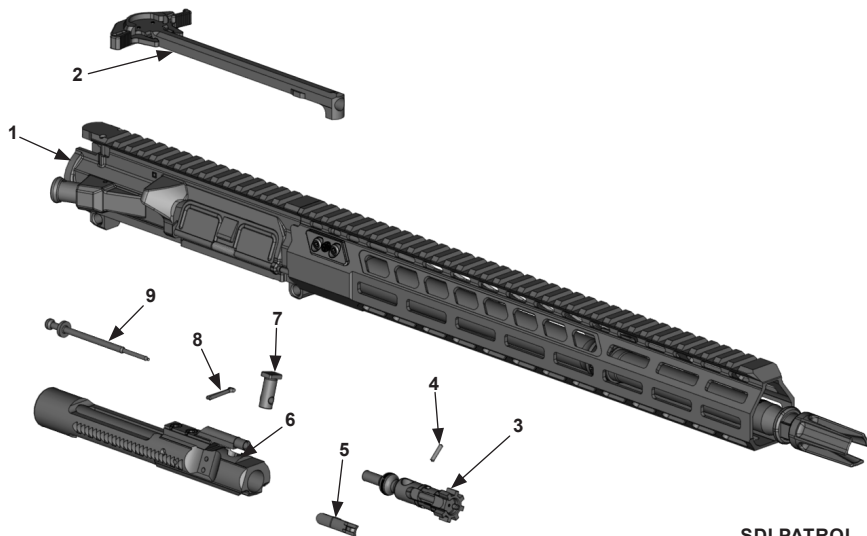

SDI PATROL

Number	Nomenclature
1	Upper Receiver Assembly
2	Ambidextrous Charging Handle
3	Bolt
4	Extractor Pin
5	Extractor and Spring
6	Bolt Carrier
7	Cam Pin
8	Firing Pin Retention Pin
9	Firing pin



9.2 LOWER RECEIVER ASSEMBLY PARTS DIAGRAM

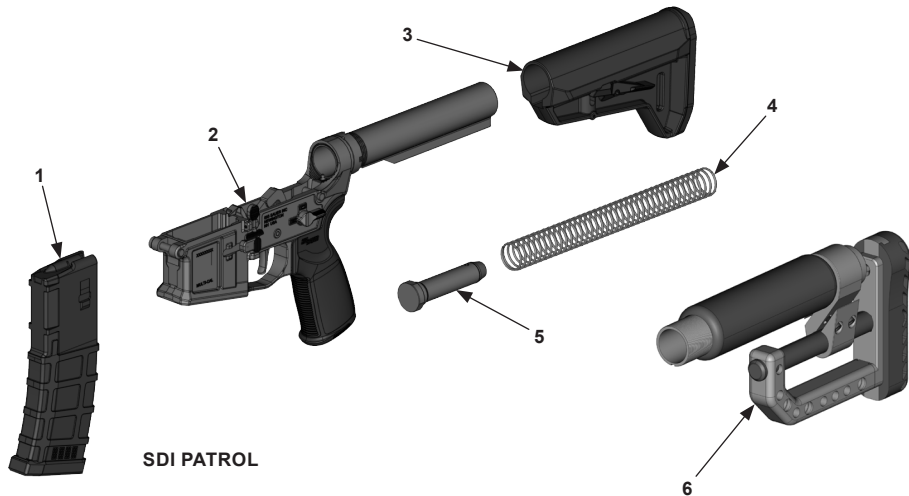

SDI PATROL

SDI DH3

Number	Nomenclature
1	Magazine, 30 rounds, 5.56 NATO
2	Lower Receiver Assembly
3	Collapsible Stock
4	Action Spring
5	Buffer
6	Buttstock, TACMOD, AR-15, DH3



10.0 TRANSPORTATION AND STORAGE



WARNING

NEVER PLACE OR STORE ANY FIREARM IN SUCH A MANNER THAT IT MAY BE DISLODGED. FIREARMS SHOULD ALWAYS BE STORED SECURELY AND UNLOADED, AWAY FROM CHILDREN AND OTHER UNAUTHORIZED USERS. THE USE OF A LOCKING DEVICE OR SAFETY LOCK IS ONLY ONE ASPECT OF RESPONSIBLE FIREARMS STORAGE. FOR INCREASED SAFETY, FIREARMS SHOULD BE STORED UNLOADED AND LOCKED IN A LOCATION THAT IS BOTH SEPARATE FROM THEIR AMMUNITION AND INACCESSIBLE TO CHILDREN AND ANY OTHER UNAUTHORIZED PERSON.

Short-Term Storage (90 days or less)

1. Ensure the chamber and magazine do not contain live ammunition.
2. Clean the bore and chamber
3. Apply a generous coat of CLP to the chamber and bore.
4. Apply a light coat of CLP to all other metal surfaces for corrosion protection.
5. Do not attempt to store an M400 SDI with a warm or hot suppressor.
6. Adjust the buttstock to its shortest length to reduce the chances of damage.

Long-Term Storage (90 days or longer)

1. Ensure the M400 SDI is thoroughly cleaned.
2. Apply a medium coat of CLP to the chamber and bore.
3. Adjust the buttstock to its shortest length to reduce the chances of damage.
4. Apply a light coat of CLP to all other metal surfaces for corrosion protection.
5. Wrap the M400 SDI with a waterproof material (MIL-B-121 or similar).
6. Place the M400 SDI in a corrosion resistant barrier bag (MIL-DTL-117 or similar).

Environmental Storage Recommendations (Armory)

Provide humidity control to limit the relative humidity to no greater than 40% at 80°F (26.7°C). If personnel will be working in these areas, design to 68°F (20.0°C) dry bulb and 40% RH for indoor design heating conditions, and 75°F (23.9°C) dry bulb and 40% RH for indoor design cooling conditions.



11.0 SERVICE AND REPLACEMENT PARTS POLICY

Parts Policy

Our Service Department maintains a full complement of replacement parts. Even though most gunsmiths have the knowledge, training, and the ability to make necessary repairs to your firearm, the skill and workmanship of any particular third-party gunsmith is totally beyond our control.

Should your firearm ever require service, we strongly recommend that you return it to SIG SAUER Inc. A firearm is a precision instrument and some replacement parts will require individual fitting to ensure correct operation. A wrong part, improper fitting, or incorrect mechanical adjustment may result in an unsafe condition or dangerous malfunction, damage to the firearm, or cause possible serious injury to the shooter or others

IF ANY PART IS ORDERED WITHOUT RETURNING THE FIREARM TO SIG SAUER Inc., the customer bears full responsibility for ensuring that the part supplied is correct for their particular firearm and is properly installed and fitted by a qualified gunsmith.

SIG SAUER INC. IS NOT RESPONSIBLE FOR THE FUNCTIONING OF ANY FIREARM IN WHICH REPLACEMENT PARTS ARE INSTALLED BY OTHERS.

Order Parts

In the event you want to order parts for your SIG M400 SDI rifle, contact Customer Service at (603) 610-3000 Ext. 1. Have available the serial number of your firearm and the part diagram number for the part(s) you wish to order. A parts list and diagram of the firearm is provided in section, 9.1 and 9.2 this manual. You may also visit sigsauer.com and use the small parts shopper on-line tool.

**WARNING PHYSICAL INJURY/DAMAGE**

IT IS THE PURCHASER'S RESPONSIBILITY TO BE ABSOLUTELY CERTAIN THAT ANY PARTS ORDERED FROM THE FACTORY ARE CORRECTLY FITTED AND INSTALLED. FIREARMS ARE COMPLICATED MECHANISMS AND IMPROPER FITTING OF PARTS MAY RESULT IN A DANGEROUS MALFUNCTION, DAMAGE TO THE FIREARM, AND SERIOUS INJURY TO THE SHOOTER AND OTHER PERSONS. THE PURCHASER AND INSTALLER OF PARTS MUST ACCEPT FULL RESPONSIBILITY FOR THE CORRECT ADJUSTMENT AND FUNCTIONING OF THE FIREARM AFTER SUCH INSTALLATION.

Service Policy

If you have questions concerning the performance or servicing of your firearm, please write or call:

SIG SAUER Inc.
Attention Customer Service
72 Pease Boulevard, Newington, NH 03801
Phone: (603) 610-3000 Ext. 1
Fax: (603) 766-7002

IF YOU DO NOT UNDERSTAND THE INSTRUCTIONS FOR OPERATING YOUR FIREARM, IT IS YOUR RESPONSIBILITY TO CALL OUR CUSTOMER SERVICE DEPARTMENT AT (603) 610-3000 Ext. 1 BEFORE USING YOUR FIREARM.



12.0 SHIPPING FIREARMS FOR REPAIR



WARNING DO NOT SHIP AMMUNITION



DO NOT SHIP A LOADED FIREARM. IF YOU NEED TO SHIP YOUR FIREARM TO SIG SAUER, DO NOT SHIP AMMUNITION, EITHER IN THE FIREARM OR SEPARATELY IN THE SHIPPING PACKAGE.

In the event you need to return your firearm to the SIG SAUER Service Department, here's what to do:

1. The first step is to contact Customer Service at (603) 610-3000 for Return Merchandise Authorization (RMA) number. This number allows SIG SAUER to track the status of your return from its receipt at SIG SAUER through its return to you. Please do not send your firearm until you obtain an RMA number.
2. Make sure the chamber and magazine(s) are unloaded and that no ammunition is included with your returned firearm.
3. Package the firearm securely to prevent damage. Enclose a letter which includes your name, street address, daytime phone number, model and serial number, and a detailed description of the problem you are experienced or the work you want performed. With the exception of extra magazines, do not include scopes, mounts, or other accessories.

4. An individual's ability to legally ship firearms to the manufacturer for repair or service varies according to state and local law. Some jurisdictions require that firearms be shipped and returned by a Federally Licensed Firearms Dealer. Consult applicable law to determine how your firearm should be returned.
5. Federal law prohibits persons who do not possess a Federal Firearms License from shipping a firearm via the U.S. Postal Service. (Note: any shipment of firearms outside U.S. borders is subject to the export laws of the United States and to the valid laws of the specific country, which you must strictly follow: prior to exporting any firearm you should seek legal counsel.)
6. SIG SAUER is not responsible for any firearm until it is received, nor for damage incurred during shipment.
7. Ship your firearms insured and prepaid (we do not accept collect shipments) to:

SIG SAUER Inc.
Attention: Service Department
18 Industrial Drive Exeter, NH 03833



SIG SAUER® LIMITED LIFETIME FIREARMS WARRANTY

SIG SAUER warrants that the enclosed firearm was originally manufactured free of defects in material, workmanship, and mechanical function. For the lifetime of the original purchaser, SIG SAUER agrees to correct any defect in the firearm for the original purchaser by repair, adjustment, or replacement, at SIG SAUER's option, with the same or comparable quality components (or by replacing the firearm at SIG SAUER's option); provided however that a Return Merchandise Authorization (RMA) is first obtained by contacting SIG SAUER Customer Service, and the firearm is returned unloaded and freight prepaid to:

SIG SAUER
18 Industrial Drive
Exeter, NH 03833.

This limited warranty is null and void if the firearm has been misused, damaged (by accident or otherwise), fired with handloaded, reloaded, or improper ammunition, fired with an obstruction in the barrel, damaged through failure to provide reasonable and necessary maintenance as described in the manual accompanying the firearm, or if unauthorized repair or any alteration, including of a cosmetic nature, has been performed on the firearm. This limited warranty does not apply to normal wear and tear of any parts.

Subject to the foregoing, this limited warranty confers the right to have the covered firearm or its parts repaired, adjusted, or replaced exclusively upon the original purchaser, which right is not transferable to any other person. This warranty does not apply to any accessory items attached or appurtenant to the firearm.

ANY WARRANTIES IMPLIED BY LAW, INCLUDING ANY IMPLIED WARRANTIES OF MERCHANTABILITY OR FITNESS FOR A PARTICULAR PURPOSE, ARE EXPRESSLY DISCLAIMED. REPAIR, ALTERATION, OR REPLACEMENT AS PROVIDED HEREIN IS YOUR EXCLUSIVE REMEDY FOR ANY DEFECTIVE PRODUCT. IN NO EVENT SHALL SIG SAUER OR ANY COMPANY AFFILIATED WITH SIG SAUER BE LIABLE FOR ANY SPECIAL, INCIDENTAL, OR CONSEQUENTIAL DAMAGES OF ANY KIND ARISING OUT OF THE PURCHASE OR USE OF THIS PRODUCT, WHETHER BASED UPON CONTRACT, TORT, STATUTE, OR OTHERWISE.

Some states do not allow the exclusion or limitation of implied warranties, or the exclusion or limitation of incidental or consequential damages, so some or all of the above limitations or exclusions may not apply to you. This warranty gives you specific legal rights, and you may also have other rights which vary from State to State.

THIS WARRANTY APPLIES TO U.S. COMMERCIAL CUSTOMERS ONLY, AND DOES NOT APPLY TO GOVERNMENT, MILITARY, LAW ENFORCEMENT, OR NON-US CUSTOMERS. NON-US CUSTOMERS SHOULD CONTACT THEIR LOCAL DEALER OR DISTRIBUTOR FOR APPLICABLE WARRANTY COVERAGE.



NOTES:

NOTES:



[sigsauer.com](https://www.sigsauer.com)

SIG SAUER, Inc.
72 Pease Boulevard, Newington, NH 03801 USA

All trademarks, service marks, trade names, trade dress, product names and logos appearing in this manual are the property of their respective owners. No trademark or service mark appearing in this manual may be used without written consent of the mark's owner.