



SIG SAUER

ROMEO®

ROMEOZero-ELITE™ for SIG SAUER P322 PISTOL
PREMIUM MICRO REFLEX SIGHT

OPERATORS MANUAL

INTRODUCTION:

The ROMEOZero-ELITE is a fast, accurate micro reflex sight that offers rapid target acquisition and a long list of premium features, at an iron sight price.

The ROMEOZero-ELITE is covered by the SIG SAUER ELECTRO-OPTICS INFINITE GUARANTEE®/LIMITED LIFETIME WARRANTY and ELECTRONIC COMPONENT LIMITED 5-YEAR WARRANTY.

KEY FEATURES:

- ELITE model fits all Industry standard ROMEOZero/ Shield™ RMSc footprints
- A 3 MOA Dot or Circle/Dot reticle which features a 2 MOA red dot surrounded by a 32 MOA circle
- Molded glass aspheric lens with high performance coatings for superior light transmittance and zero distortion
- Carbon Infused ultralight polymer housing
- 8 user-selectable brightness levels
- Auto-Off feature automatically shuts off the optic after 2 hours to conserve battery life
- Anti-reflection grooves on all rear surfaces for glare reduction in bright environments
- Integrated rear backup sight featuring Swiss Super-Luminova® glow-in-the-dark notch for low light situations
- Highly efficient point-source LED emitter, for extreme reticle brightness

CONTENTS:

- ROMEOZero-ELITE Micro Open Reflex Sight
- (2) M3 x .5 x 12 Mounting Screws
- .050" Allen Wrench (Windage/Elevation Adjustment)
- 2mm Allen Wrench (Mounting Screws)
- CR1632 Battery
- Die Cut Chemical Shield Decal

SPECIFICATIONS

Objective Lens Diameter	24mm
Battery	CR1632
Overall Windage Adjustment	50 MOA
Overall Elevation Adjustment	50 MOA
Brightness Settings	8 Daytime Settings
Weight w/o Battery or Shroud	0.5 oz / 14 grams

PRODUCT IDENTIFICATION:

- A. Windage Adjustment Screw
B. Elevation Adjustment Screw
C. Mount Screw Holes
D. Brightness Adjustment Button

- E. Backup Rear Sight with Swiss Super-Luminova Notch
F. Battery Slot

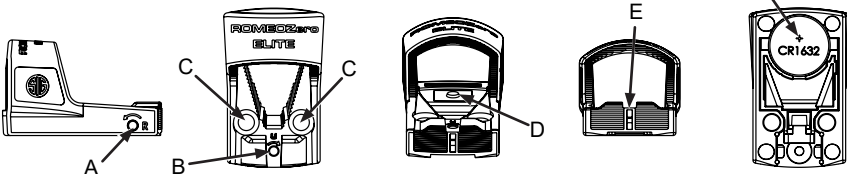

INSTALLATION:

IMPORTANT: Prior to installation, battery change, cleaning or maintenance, ensure that the firearm is unloaded with the safety on and pointed in a safe direction.

CAUTION! DO NOT REMOVE THE PLASTIC SEAL DECAL UNDERNEATH THE OPTIC THAT CONTAINS THE SERIAL NUMBER. DOING SO MAY DAMAGE THE PRODUCT.

The ROMEOZero-ELITE comes with M3 x .5 x 12, Part # 7402476 (Figure 1): These screws are meant to mount the ROMEOZero-ELITE directly to a SIG SAUER P322 pistol slide. These screws can be identified by the short shoulder with no machined grooves.

Before attempting to install the ROMEOZero-ELITE, first thread the mounting screws directly into the mounting holes of the pistol or accessory mount, to ensure the screws thread properly into the mounting holes.

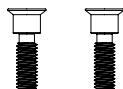
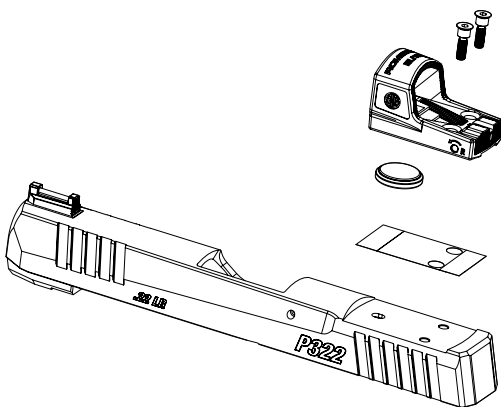

FIGURE 1.

MOUNTING DIRECTLY TO AN OPTICS-READY PISTOL SLIDE:

Remove any cover plate from the optic cut area of the pistol slide (consult the firearm operator's manual). Use a clean dry cloth to wipe any oil or residue from the optic cut area. Use a cotton swab lightly soaked in isopropyl alcohol to wipe any excess oil or solvent out of the threaded optic mounting holes in the pistol slide. If mounting to a P322 slide (Figure 2), first apply the included Die Cut Chemical Shield Decal to the optics cut area. This will keep gas and debris from flowing up through the hole in the pistol slide to the optic. Ensure that a new CR1632 battery is installed in the optic, with the positive (+) side facing out, toward the pistol slide. Hold the battery in place while lowering the optic onto the optic cut of the pistol slide. Line up the mounting holes in the optic with the threaded mounting holes in the pistol slide and begin threading the correct mounting screws through the optic mounting holes and into the pistol slide using a 2mm Allen wrench. While firmly pushing the optic forward on the mounting surface (toward the muzzle), turn the screws clockwise until the tapered screw heads make firm contact with the optic housing. Then turn an additional 3/4 of a turn. For best results, use an inch-pound torque wrench set to 9 in-lbf. NOTE: You should re-torque the mount screws to 9 in-lbf. each time you remove and reinstall the sight, and after every 500 rounds fired.

CAUTION! DO NOT ADJUST THE WINDAGE OR ELEVATION ADJUSTMENTS WHILE THE OPTIC IS REMOVED FROM THE PISTOL OR MOUNT SURFACE. ONLY MAKE WINDAGE AND ELEVATION ADJUSTMENTS AFTER SHOOTING LIVE AMMUNITION AT A TARGET. ATTEMPTING TO CO-WITNESS THE RETICLE TO THE PISTOL IRON SIGHTS WITHOUT FIRST ZEROING THE OPTIC AT THE RANGE CAN PUSH THE ADJUSTMENT SCREWS BEYOND THEIR LIMITS AND DAMAGE THE OPTIC.



OPERATION:

INSTALLING AND CHANGING THE BATTERY:

The optic must be removed from the firearm to access the battery. The CR1632 coin cell battery is installed from underneath the sight. Insert the battery into the round battery slot with the positive (+) side facing out, toward the pistol slide, and temporarily hold it in place using a thumb or finger until you're ready to mount the sight onto the firearm.

TURNING THE SIGHT ON/OFF, ADJUSTING BRIGHTNESS AND CHANGING RETICLES:

TIP: To see the reticle brightness changes while cycling through them, use a small tool such as the adjustment Allen wrench, rather than a finger, to push the brightness adjustment button.

There are a total of 8 brightness levels on the ROMEOZero-ELITE. To turn the sight ON, press and hold the brightness adjustment button (located just behind the lens) for 2 seconds. To turn the sight OFF, press and hold the brightness adjustment button again for 2 seconds. To adjust the reticle brightness, from ON press and release the brightness adjustment button. The reticle will raise 1 brightness level per button press until the top brightness level is reached, indicated by multiple flashes of the reticle. Each subsequent button press will lower the reticle brightness 1 level until the lowest brightness level is reached, indicated by multiple flashes of the reticle. Subsequent button presses will begin raising the reticle brightness level again.

CYCLING THROUGH RETICLES (CIRCLE/DOT MODELS ONLY):

On models equipped with the circle/dot reticle, the user can select between dot only, dot with circle, and circle only. To cycle through the reticles while the sight is ON, press and hold the brightness adjustment button for 3 seconds, and the reticle will begin blinking. Press and release the button while the reticle is blinking to change the reticle, until the desired reticle is displayed. After 5 seconds with no button presses, the reticle being displayed will stop blinking and will be locked in.

AUTO-OFF: This ROMEOZero-ELITE model is equipped with an auto-off feature, which helps extend battery life. After 2 hours of being ON, the optic will automatically turn off. To turn the optic back on, press and hold the brightness adjustment button for 2 seconds. The reticle will return to the last brightness and reticle setting that was in use before it turned off.

REAR BACKUP SIGHT:

The ROMEOZero-ELITE features a molded backup rear sight and a notch filled with Grade A Swiss Super-Luminova pigment. This pigment is activated by any bright light source, and will glow in the dark for hours after light exposure. The brightness of the pigment will decline gradually after being taken away from light, but can be reactivated with a brief exposure to bright light such as from a handheld flashlight. Due to the wide variety of pistol optics-cut slides and front sight heights, the rear sight notch on the ROMEOZero-ELITE may or may not line up correctly with the firearm front sight.

WINDAGE AND ELEVATION ADJUSTMENT:

NOTE – The illuminated reticle of the ROMEOZero-ELITE has been adjusted to mechanical center at the factory. Therefore, the optic will be close to zeroed when installed on an optic-ready pistol, and should only require minor adjustment to bring point of aim and point of impact together.

ADJUSTING ELEVATION:

To raise your point of impact, use the included 0.50" Allen wrench to turn the elevation screw clockwise. To lower your point of impact, turn the adjustment screw counter-clockwise.

ADJUSTING WINDAGE:

To move your point of impact left use the included 0.50" Allen wrench to turn the windage screw clockwise. To move your point of impact right, turn the adjustment screw counterclockwise.

CAUTION! DO NOT ADJUST THE WINDAGE OR ELEVATION ADJUSTMENTS WHILE THE OPTIC IS REMOVED FROM THE PISTOL OR MOUNT SURFACE. DOING SO MAY CAUSE DAMAGE TO THE OPTIC. NEVER FORCE THE ADJUSTMENT SCREWS BEYOND THEIR LIMITS OF TRAVEL.

CLEANING & MAINTENANCE:

After repeated fire, the lens may become clouded with gunpowder residue. For best results, it is recommended that the outer surface of the lens (the side closest to the muzzle) be cleaned, along with the firearm, after each use. To clean the lens, follow these steps:

- 1. Keep firearm pointed in a safe direction
- 2. Ensure firearm is unloaded
- 3. Dampen the end of a cotton swab with isopropyl alcohol
- 4. Apply dampened swab to lens and polish in a small circular pattern, beginning in the center and moving out to the edges.

If the optic is mounted on a pistol that gets carried inside or underneath clothing on a regular basis, it is possible to collect clothing fibers or lint in the emitter area, causing a temporary loss or change in appearance of the red dot. With the firearm unloaded with the safety on and pointed in a safe direction, use compressed air to blow out the emitter area, located on top of the sight, between the mount screw holes.

The optic should never be submerged or flushed with cleaning solvents.

TROUBLESHOOTING

POINT OF IMPACT CHANGES BETWEEN GROUPS, WHILE SHOOTING FROM A SET DISTANCE:

- Check that the mounting screws are torqued to 9 in-lbf.
- Check for variations in your ammunition
- Check/clean your firearm

SIGHT WILL NOT TURN ON:

- Install a fresh CR1632 coin cell battery. Press and hold the brightness adjustment button for at least 2 seconds. It is also possible that the sight is on but set at a low brightness setting. Move to a dark room to see if the illuminated dot is turned down to a low setting, and use the brightness adjustment button to raise the dot brightness.

ILLUMINATED RETICLE SUDDENLY CHANGES SHAPE OR BECOMES BLURRY:

- Use compressed air to blow out the emitter area, located on top of the sight, between the two mount screw holes.



WARNING: CANCER AND REPRODUCTIVE HARM—www.P65warnings.ca.gov



SIG SAUER ELECTRO-OPTICS INFINITE GUARANTEE®/LIMITED LIFETIME WARRANTY



SIG SAUER® has manufactured the most rugged, dependable, high-performance firearms for more than two centuries. Our heritage of design, engineering, and precision-manufactured quality predates the existence of any other optics company worldwide. We understand the importance of quality in the line of fire, at the shooting range or on your next hunt. SIG SAUER Electro-Optics had to earn the right to wear that badge and the Infinite Guarantee has your back, forever. Period.

We will repair or replace your SIG SAUER product in the event it becomes damaged or defective, at no charge to you. If we cannot repair your product, we will replace it with a product in perfect working order of equal or better physical condition.

SIG SAUER® Infinite Guarantee®

- Unlimited Lifetime Guarantee
- Fully Transferable
- No Receipt Required
- No Time Limit Applies
- No Warranty Card Required
- No Charge

Please note that our Infinite Guarantee excludes coverage for intentional damage, misuse, cosmetic damage that does not affect the performance of the optic, loss, theft, or unauthorized repair or modification. Excludes electronic and Tritium components. Customers seeking warranty coverage must first obtain a Return Merchandise Authorization (RMA) by contacting SIG SAUER Customer Service, and return the product unloaded and freight prepaid.

ANY WARRANTIES IMPLIED BY LAW, INCLUDING ANY IMPLIED WARRANTIES OF MERCHANTABILITY OR FITNESS FOR A PARTICULAR PURPOSE, ARE EXPRESSLY DISCLAIMED. REPAIR, ALTERATION, OR REPLACEMENT AS PROVIDED HEREIN IS YOUR EXCLUSIVE REMEDY FOR ANY DEFECTIVE PRODUCT. IN NO EVENT SHALL SIG SAUER OR ANY COMPANY AFFILIATED WITH SIG SAUER BE LIABLE FOR ANY SPECIAL, INCIDENTAL, OR CONSEQUENTIAL DAMAGES OF ANY KIND ARISING OUT OF THE PURCHASE OR USE OF THIS PRODUCT, WHETHER BASED UPON CONTRACT, TORT, STATUTE, OR OTHERWISE. Some states do not allow the exclusion or limitation of implied warranties, or the exclusion or limitation of incidental or consequential damages, so some or all of the above limitations or exclusions may not apply to you. This warranty gives you specific legal rights, and you may also have other rights which vary from State to State. THIS WARRANTY APPLIES TO COMMERCIAL CUSTOMERS ONLY, AND DOES NOT APPLY TO GOVERNMENT, MILITARY, LAW ENFORCEMENT, OR NON-US CUSTOMERS. NON-US COMMERCIAL CUSTOMERS MUST PURCHASE PRODUCT THROUGH AN AUTHORIZED SIG SAUER DEALER WITHIN THEIR COUNTRY OF RESIDENCE FOR THIS WARRANTY TO APPLY.

SIG SAUER® ELECTRONIC COMPONENT LIMITED 5-YEAR WARRANTY



SIG SAUER warrants that the electronic and tritium components of the enclosed product were originally manufactured free of defects in workmanship, material, and mechanical function. For a period of five (5) years from the date of manufacture, SIG SAUER agrees to correct any defect in these components by repair, adjustment, or replacement, at SIG SAUER's option, with the same or comparable quality components (or by replacing the product at SIG SAUER's option); provided however that a Return Merchandise Authorization (RMA) is first obtained by contacting SIG SAUER Customer Service, and that the product is returned unloaded and freight prepaid.

This limited warranty is null and void if the product has been misused, damaged (by accident or otherwise), damaged through failure to provide reasonable and necessary maintenance as described in the user's manual, or if unauthorized repair or any alteration, including of a cosmetic nature, has been performed on the product. This limited warranty does not apply to normal cosmetic wear and tear of any parts.

ANY WARRANTIES IMPLIED BY LAW, INCLUDING ANY IMPLIED WARRANTIES OF MERCHANTABILITY OR FITNESS FOR A PARTICULAR PURPOSE, ARE EXPRESSLY DISCLAIMED. REPAIR, ALTERATION, OR REPLACEMENT AS PROVIDED HEREIN IS YOUR EXCLUSIVE REMEDY FOR ANY DEFECTIVE PRODUCT. IN NO EVENT SHALL SIG SAUER OR ANY COMPANY AFFILIATED WITH SIG SAUER BE LIABLE FOR ANY SPECIAL, INCIDENTAL, OR CONSEQUENTIAL DAMAGES OF ANY KIND ARISING OUT OF THE PURCHASE OR USE OF THIS PRODUCT, WHETHER BASED UPON CONTRACT, TORT, STATUTE, OR OTHERWISE. Some states do not allow the exclusion or limitation of implied warranties, or the exclusion or limitation of incidental or consequential damages, so some or all of the above limitations or exclusions may not apply to you. This warranty gives you specific legal rights, and you may also have other rights which vary from State to State. THIS WARRANTY APPLIES TO COMMERCIAL CUSTOMERS ONLY, AND DOES NOT APPLY TO GOVERNMENT, MILITARY, LAW ENFORCEMENT, OR NON-US CUSTOMERS. NON-US COMMERCIAL CUSTOMERS MUST PURCHASE PRODUCT THROUGH AN AUTHORIZED SIG SAUER DEALER WITHIN THEIR COUNTRY OF RESIDENCE FOR THIS WARRANTY TO APPLY.