

SIGSAUER®



SIG P320® PISTOLS

OPERATOR'S MANUAL: HANDLING & SAFETY INSTRUCTIONS



READ THE INSTRUCTIONS AND WARNINGS IN THIS MANUAL CAREFULLY BEFORE USING THIS FIREARM.
DO NOT DISCARD THIS MANUAL.
THIS MANUAL SHOULD ALWAYS ACCOMPANY THIS FIREARM AND BE TRANSFERRED WITH IT UPON CHANGE
IN OWNERSHIP OR WHEN THE FIREARM IS PRESENTED TO ANOTHER PERSON.





WARNING

BEFORE OPERATING THE FIREARM, REVIEW THE SAFETY WARNINGS MANUAL THAT WAS PROVIDED WITH THE FIREARM. ALTERNATIVELY, REFER TO SIGSAUER.COM FOR THE LATEST SAFETY WARNING INFORMATION.

Scan the QR code below to visit sigsauer.com.





Contents

1.0 Mechanical Characteristics	7
1.1 Description of Firearm	7
1.2 Main Components and Operator Controls (Standard Controls)	8
1.3 Principal Safety Features	10
2.0 Handling	11
2.1 Preparation Instructions	11
2.2 Magazine Disconnect Mechanism	11
2.3 Manual Safety Equipped Pistols	12
2.4 Loaded Chamber Indicator (LCI) Equipped Pistols	13
2.5 Loading the Magazine	14
2.6 Loading the Pistol	16
2.6.1 Reloading During Shooting – Depleted Magazine	20
2.6.2 Reloading During Shooting – Partial magazine	23
2.7 Firing	26
2.8 Unloading and Clearing the Pistol	27
2.8.1 Unloading the Pistol (Magazine Not Empty)	28
2.8.2 Unloading the Pistol (Magazine Empty, Slide Open)	31
3.0 User Level Authorized Maintenance	33
3.1 Pistol Disassembly	33
3.2 Cleaning and Lubricating	38
3.3 Pistol Assembly	43
4.0 Magazine Maintenance	47
4.1 Magazine Disassembly	47
4.2 Cleaning	48
4.3 Magazine Assembly	49
5.0 Function Check	51
6.0 Pistol Adjustments	53
6.1 Torque Specifications	53
6.2 Sight Plate Removal and Installation	55

6.2.1 Sight Plate Removal	55
6.2.2 Sight Plate Installation	58
6.3 Blanking Plate Removal and Installation	61
6.3.1 Blanking Plate Removal	61
6.3.2 Blanking Plate Installation	62
6.4 ROMEO Red Dot Optic Removal and Installation	63
6.4.1 ROMEO Removal	63
6.4.2 ROMEO Installation	64
6.5 Compensator Removal and Installation	66
6.5.1 Compensator Removal	66
6.5.2 Compensator Installation	69
6.6 Magazine Catch/Release Removal and Installation	71
6.6.1 Magazine Catch/Release Removal	71
6.6.2 Magazine Catch/Release Installation	73
6.7 Magazine Funnel Removal and Installation	74
6.7.1 Magazine Funnel Removal	74
6.7.2 Magazine Funnel Installation	75
6.8 Fire Control Unit (FCU) Removal and Installation	76
6.8.1 FCU Removal	76
6.8.2 FCU Installation	79
7.0 Sights	82
7.1 General Information	82
7.2 Windage (Left/Right) Adjustment	83
7.3 Elevation (Up/Down) Adjustment	84
7.4 Sight Adjustment P320 XSERIES Pistol	85
8.0 Storage and Transportation	86
9.0 Troubleshooting Guide	88
9.1 Obstructed Bore	89
9.2 Cook-Off	90
9.3 General troubleshooting	91
9.4 Minimizing Stoppages	93



10.0 Replacement Parts Policy.	94
11.0 Factory Repair of the Firearm.	96
11.1 Returning Firearms for Repair	97
12.0 Standard Slide Parts Diagram	98
12.1 XSERIES Slide Parts Diagram	99
12.2 P320-RXP/XVTAC Slide Parts Diagram	100
12.3 P320 Spectre Compensated Slide Parts Diagram	101
12.4 P320 PRO Slide Parts Diagram.	102
12.5 Standard Frame Parts Diagram.	103
12.6 XSERIES Frame Parts Diagram	104
SIG SAUER Infinite Guarantee™	105

1.0 MECHANICAL CHARACTERISTICS

1.1 DESCRIPTION OF FIREARM

The SIG SAUER P320 pistol is a modern handgun incorporating the latest technical advances in firearm design for military, law enforcement, and sporting use. The P320 is a striker fired, mechanically locked, short-recoil operated pistol with semi-automatic reloading. Firing takes place with each pull of the trigger. The slide remains open after the last cartridge has been fired.

The SIG SAUER P320 is offered in 9mm and .45 Auto and has caliber exchange kits for .40 and .357 SIG. The pistol also features an interchangeable grip module, a reversible magazine catch/release, and ambidexterous controls. An accessory rail is integrated into the grip module, facilitating the easy attachment of industry standard tactical accessories.

Additional information about SIG SAUER products, SIG SAUER Academy and the SIG Experience Center, Special Programs, and additional support can be found by scanning the QR code below to visit sigsauer.com.





1.2 MAIN COMPONENTS AND OPERATOR CONTROLS (STANDARD CONTROLS)

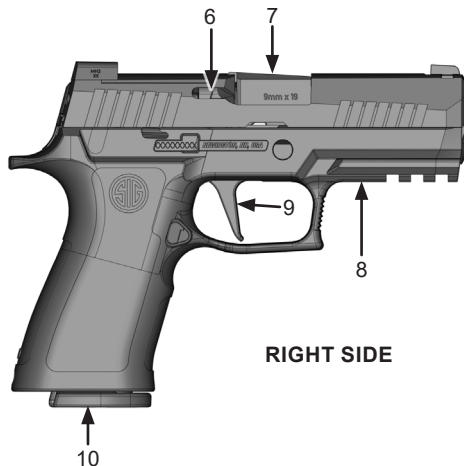
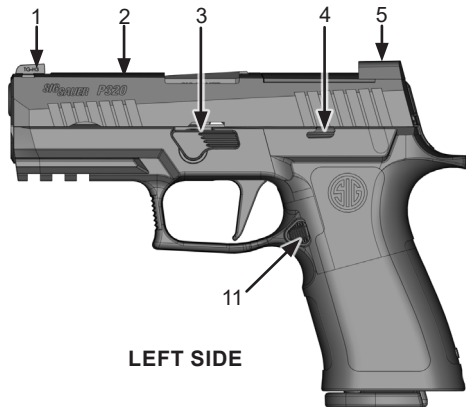

1	Front Sight	A visual aid for proper alignment of the pistol.
2	Slide	Chambers and ejects rounds, cocks the internal hammer, provides a locking mechanism, houses firing and safety components, and manages recoil.
3	Takedown Lever	Allows the slide to be removed from the frame.
4	Slide Catch/ Release Lever	Holds and releases the slide and aids in reloading.
5	Rear Sight	A visual aid for proper alignment of the pistol.
6	Extractor	Pulls spent casings or cartridges out of the chamber of the barrel.
7	Barrel	Guides the projectile from the chamber to the muzzle when the pistol is fired.
8	Grip Module	Houses trigger and safety components and magazine.
9	Trigger	When pressed actuates the internal components to fire the pistol.
10	Magazine	Holds and positions cartridges in place for feeding.
11	Magazine Catch/ Release	Holds and releases the magazine in the grip module.



1.3 PRINCIPAL SAFETY FEATURES

This pistol contains the following safety features:

- The striker safety lock and disconnect safety prevent the firearm from firing unless the trigger is pulled, ensuring safe carrying of the firearm and providing instant readiness without actuating a manual safety.
- The P320 is offered with an optional ambidextrous manual safety, which prevents the trigger from being pulled when engaged.
- Certain models are equipped with a magazine disconnect mechanism which prevent the trigger from being pulled unless a magazine is inserted.

2.0 HANDLING

2.1 PREPARATION INSTRUCTIONS



WARNING



BEFORE PROCEEDING, REFER TO THE GENERAL MAINTENANCE SECTION OF THE SAFETY WARNINGS MANUAL.

Prior to using the firearm, read, understand, and follow all the safety warnings in this manual. Perform an initial cleaning and lubrication of the pistol after unpacking it. Any fouling present will have been from final range firing at the factory prior to shipping. Refer to section 3.2 Cleaning the Pistol for instructions on cleaning the pistol.

2.2 MAGAZINE DISCONNECT MECHANISM

Some models feature a magazine disconnect mechanism which mechanically blocks the movement of the trigger bar, preventing the trigger from being pressed to the rear unless a magazine is inserted.



2.3 MANUAL SAFETY EQUIPPED PISTOLS

The SIG SAUER P320 is offered with an optional ambidextrous manual safety. The manual safety mechanically blocks the movement of the trigger bar, preventing release of the striker.

To engage the manual safety, rotate the manual safety lever upward. The manual safety is ambidextrous. Pressing up on the lever from either side will rotate the opposite lever upward, engaging the manual safety. The slide can be manipulated with the manual safety engaged.

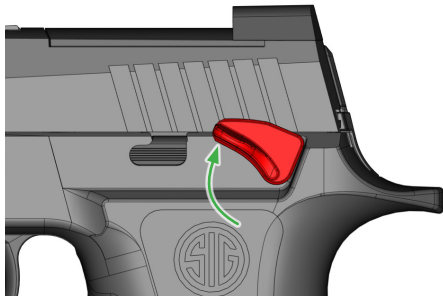

ENGAGE MANUAL SAFETY

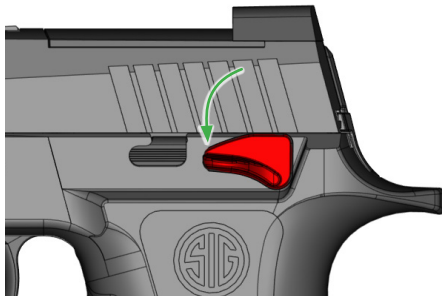

DISENGAGE MANUAL SAFETY

2.4 LOADED CHAMBER INDICATOR (LCI) EQUIPPED PISTOLS

The loaded chamber indicator provides a visual and tactile indication that there is a live round in the chamber. In limited visibility situations, the non-firing hand can be used to determine if the loaded chamber indicator is in the elevated position indicating a live round in the chamber.

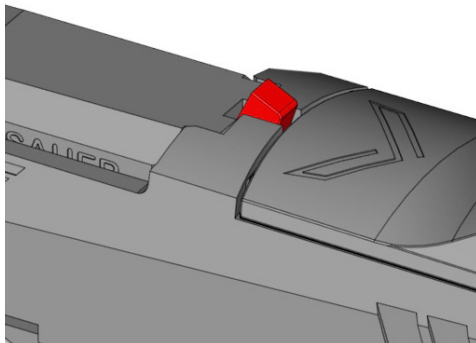

ROUND IN CHAMBER

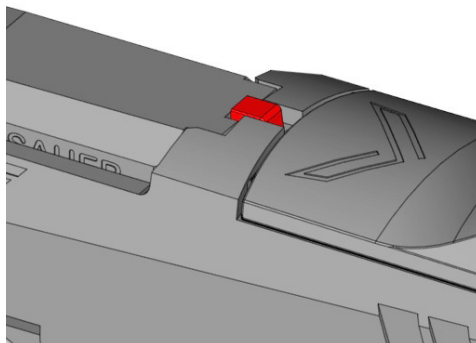

EMPTY CHAMBER



2.5 LOADING THE MAGAZINE

CAUTION

DO NOT ATTEMPT TO INSERT MORE CARTRIDGES THAN THE MAGAZINE'S DESIGNED CAPACITY.

NOTE

Ensure that the magazine is the proper type and caliber for the pistol.

1. Press down on the magazine follower using the cartridge case rim. Ensure that the projectile is facing the front of the magazine.

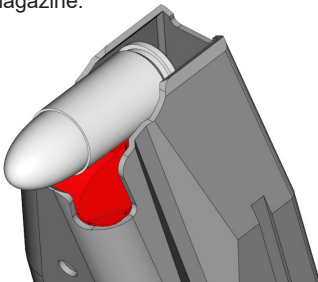

2. Push the cartridge to the rear and under the magazine lips.
3. Repeat until the magazine holds the desired number of cartridges or is full. Do not attempt to insert more cartridges than the magazine's designed capacity.

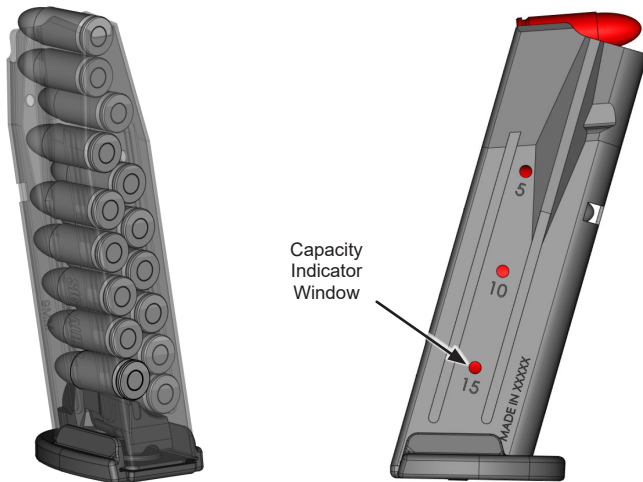



2.6 LOADING THE PISTOL

1. Point pistol in a safe direction. Engage the manual safety if so equipped.
2. Fully retract the slide and lock it to the rear by pushing up on the slide catch/release lever.



3. Visually and physically inspect the chamber to ensure that it is clear.
4. Inspect the breech face and magazine well for any foreign debris or ammunition.

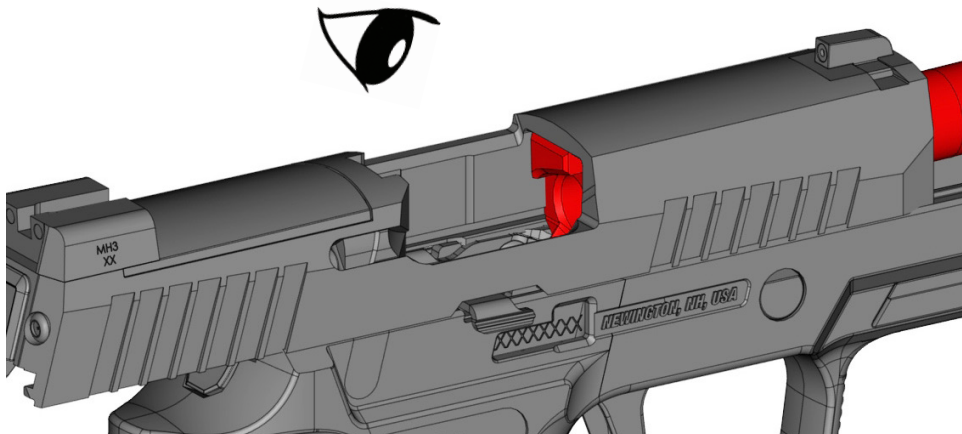



5. Insert a loaded magazine, pushing it up into magazine well until it locks in place. There should be an audible click.

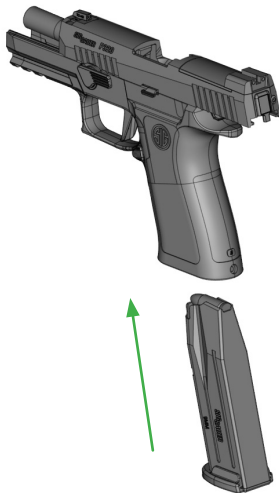

6. Release the slide by either:
- Pressing down on the slide catch/release lever, releasing the slide forward and chambering a cartridge.
 - Pulling back on the slide until the slide catch/release lever drops clear of the slide then releasing it to chamber a cartridge. Do not ride the slide forward. Failure to properly complete this step may induce a stoppage.

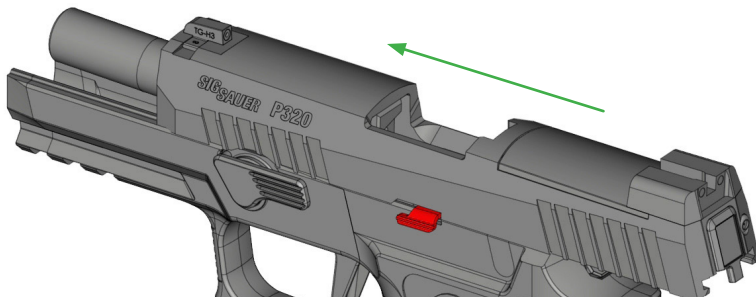

WARNING LOADED PISTOL



THE PISTOL IS NOW LOADED AND READY TO FIRE



2.6.1 RELOADING DURING SHOOTING – DEPLETED MAGAZINE

NOTE

When the last cartridge in the magazine is expended, the slide will be locked back in the open position by the slide catch/release lever.

1. Engage the manual safety if so equipped.
2. Press the magazine catch/release to remove the empty magazine.

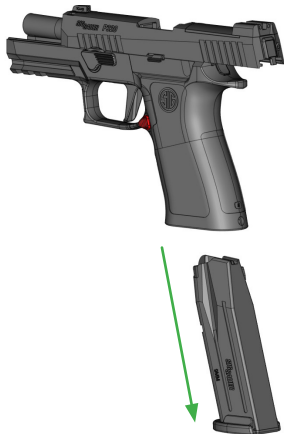

3. Insert a loaded magazine, making sure it is locked into the grip module.

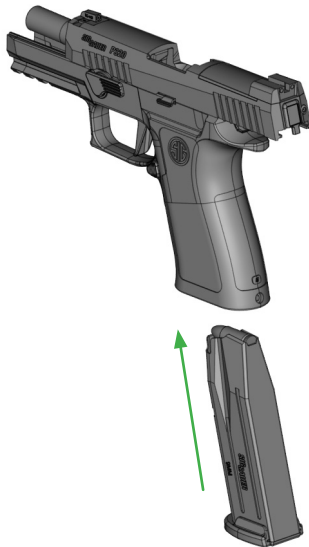



4. Release the slide by either:
- Pressing down on the slide catch/release lever.
 - Pulling back and releasing the slide.

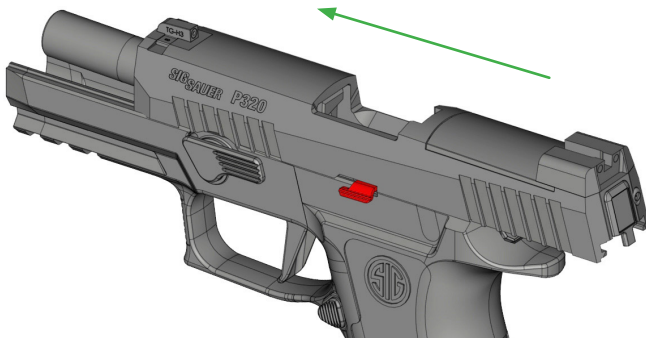

WARNING LOADED PISTOL



THE PISTOL IS NOW LOADED AND READY TO FIRE

2.6.2 RELOADING DURING SHOOTING – PARTIAL MAGAZINE

NOTE

A magazine does not need to be empty to be removed.

1. Keep the muzzle pointed in a safe direction.
2. If equipped, rotate the manual safety lever upward to engage the manual safety.





3. Press the magazine catch/release to remove the loaded magazine.



WARNING

LOADED PISTOL



THE PISTOL IS STILL LOADED AND READY TO FIRE.

4. Insert a loaded magazine by pushing it up and into the magazine well until it locks in place. There should be an audible click.





2.7 FIRING



WARNING LOADED PISTOL



BEFORE PROCEEDING, REFER TO THE HANDLING SECTION OF THE SAFETY WARNINGS MANUAL.



1. Aim the pistol at a safe target
2. If equipped, press down on the manual safety lever to disengage the manual safety.
3. Pull the trigger to fire.
4. Keep the pistol aimed at the target until done shooting.
5. To unload and clear the firearm, proceed to section 2.8 Unloading and Clearing the Pistol.

2.8 UNLOADING AND CLEARING THE PISTOL

When the chamber has a live cartridge in it, it will discharge if the safeties are disengaged and the trigger is pulled. It is absolutely essential to completely unload and clear the pistol when it is not in use.



WARNING UNLOAD/CLEAR



BEFORE PROCEEDING, REFER TO THE MAINTENANCE SECTION OF THE SAFETY WARNINGS MANUAL.

1. Always make sure the muzzle is pointed in a safe direction.
2. Clear the chamber after the magazine has been removed.
3. Check the firearm twice, both visually and physically.



2.8.1 UNLOADING THE PISTOL (MAGAZINE NOT EMPTY)

1. Keep the muzzle pointed in a safe direction and, if equipped, engage the manual safety.
2. Press the magazine catch/release and remove the magazine.

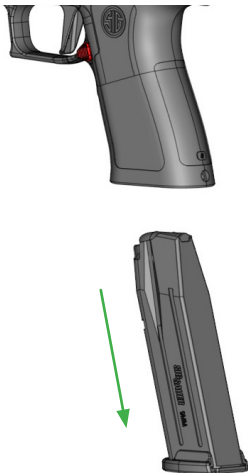

3. Pull the slide completely to the rear while watching for the ejection of a live cartridge. Push up on the slide catch/release lever to lock slide open.

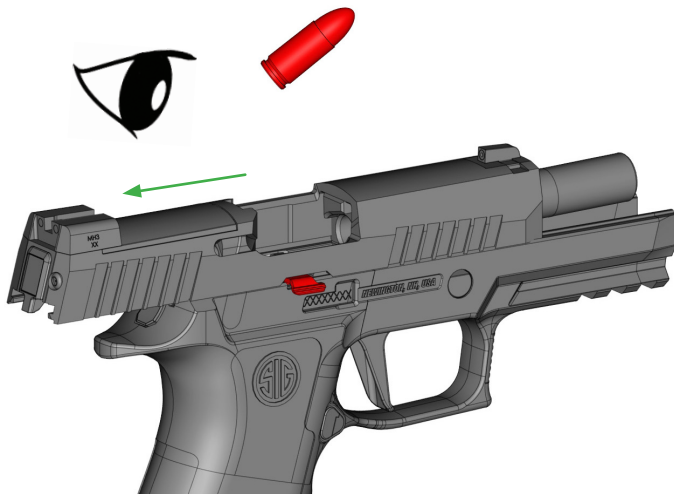



4. Visually and physically check the chamber, magazine well, and breech face to ensure that pistol is completely free of ammunition.

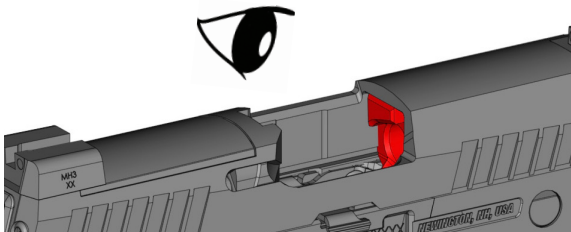

5. Press the slide catch/release lever, causing the slide to close.
6. Unload the magazine.

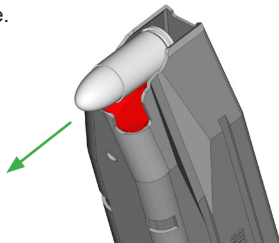

2.8.2 UNLOADING THE PISTOL (MAGAZINE EMPTY, SLIDE OPEN)

1. Keep the muzzle pointed in a safe direction and engage manual safety if so equipped.
2. Press the magazine catch/release and remove the magazine.

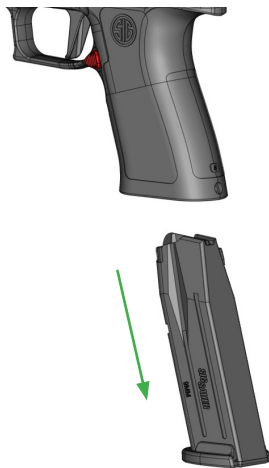



3. Visually and physically check the chamber, magazine well, and breech face to ensure that the pistol is completely free of ammunition.

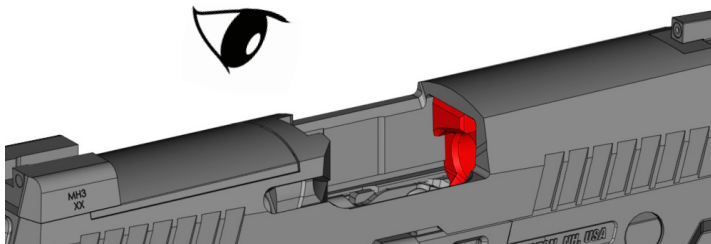

4. Press the slide catch/release lever to close the slide.

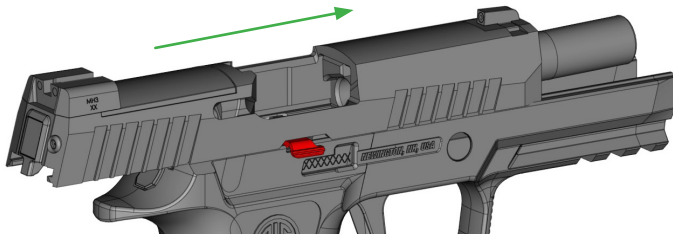

3.0 USER LEVEL AUTHORIZED MAINTENANCE



WARNING UNLOAD/CLEAR



BEFORE PROCEEDING, REFER TO THE MAINTENANCE SECTION OF THE SAFETY WARNINGS MANUAL.

3.1 PISTOL DISASSEMBLY

1. Unload and clear the pistol. See section 2.8 Unloading and Clearing the Pistol.
2. Lock the slide to rear by pulling the slide rearward and pushing up on the slide catch/release lever.

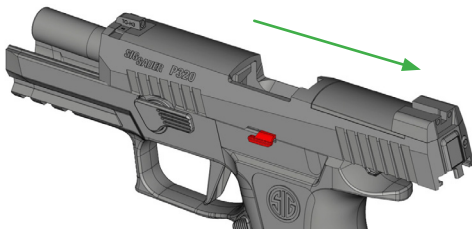



3. Rotate the takedown lever clockwise until it stops.



**WARNING PARTS UNDER SPRING TENSION**

BEFORE PROCEEDING, REFER TO THE MAINTENANCE SECTION OF THE SAFETY WARNINGS MANUAL.

4. Pull the slide to the rear to disengage the slide catch/release lever while maintaining control of the slide assembly.

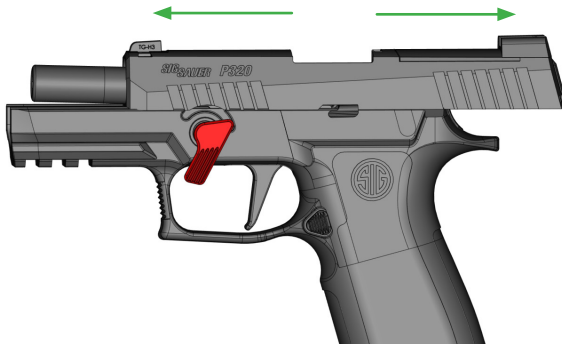



5. Guide the complete slide assembly (slide, barrel, recoil spring, and guide) forward and off of the frame.

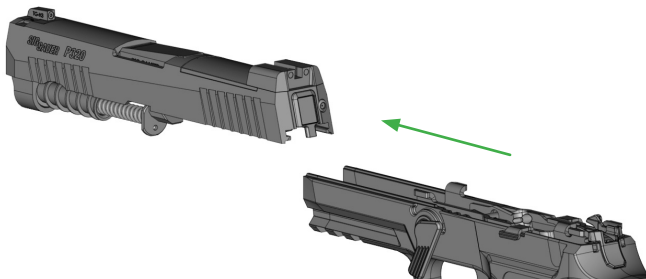

6. Push the recoil spring guide forward slightly and lift it from the rear to remove the recoil spring guide assembly from the slide.

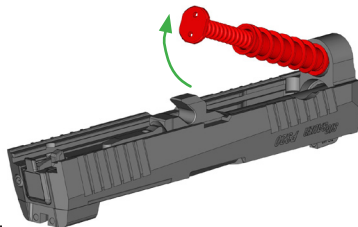

7. Remove the barrel from the slide by pulling it upward slightly and to the rear.

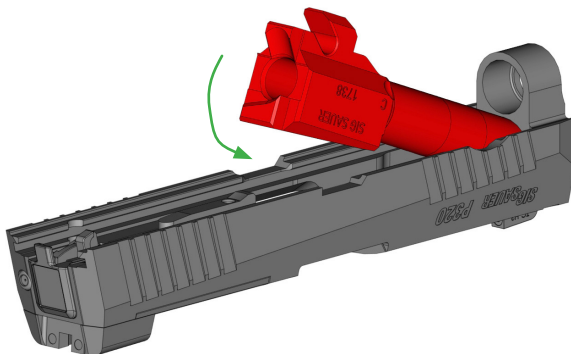

NOTE

This level of disassembly is sufficient to allow a thorough cleaning after firing.



3.2 CLEANING AND LUBRICATING



WARNING CLEANING



BEFORE PROCEEDING, REFER TO THE MAINTENANCE SECTION OF THE SAFETY WARNINGS MANUAL.

CAUTION

NEVER CLEAN THE BARREL FROM THE MUZZLE END. DO NOT USE A STEEL WIRE BRUSH AS IT CAN DAMAGE THE SMOOTH SURFACE OF THE BARREL. USE A SUITABLE CLEANING ROD AND BRONZE BRUSH OF THE CORRECT CALIBER. SOLVENTS CAN BE HARMFUL TO THE SURFACE FINISH OF THE PISTOL. AVOID OVER-LUBRICATION OF COMPONENTS.

CAUTION

DO NOT LUBRICATE THE STRIKER OR ALLOW LUBRICANT TO FLOW INTO THE STRIKER CHANNEL OF THE SLIDE. THIS MAY CAUSE A LIGHT STRIKE TO THE CARTRIDGE RESULTING IN A FAILURE TO FIRE.

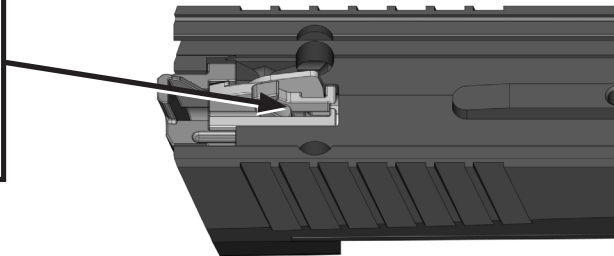



MATERIALS REQUIRED

- Cleaning patches
- Cleaning cloth
- Bore brush of the proper caliber
- Cleaning rod
- CLP (Cleaning, Lubricant, Preservative)
- Lubricant, Low Temperature when applicable
- Cleaning brush

The following instructions are for normal environmental conditions. Clean and lube before or after every day the pistol is fired or at a minimum of every 500 rounds. The compensator (if installed) does not need to be removed for routine maintenance and cleaning.

SLIDE ASSEMBLY

1. Remove all of the old lubricant before reapplying.
2. Clean the slide assembly with a cloth. A soft brush and CLP can be used to clean excessive dirt and carbon buildup. Ensure the extractor, rail slots, and breech face are free of dirt and residue.
3. Apply a light coat of CLP to the frame rail slots of the slide.
4. Lightly oil all external parts.
5. Do not lubricate the striker assembly.

BARREL

1. Soak a patch with CLP and push it through the bore from the chamber end and out past the muzzle.
2. If compensator is installed, push barrel forward in the slide to allow space to run rods and patches through the barrel.
3. Allow the CLP to soak for several minutes to loosen residue and soften carbon deposits.
4. Wipe the exterior of the barrel with a cloth soaked in CLP.
5. Repeat step #1.
6. Use the bore brush and a cleaning rod to scrub heavy deposits from the bore.
7. Repeat step #1.
8. Push dry patches through the bore until they come out clean.
9. Lightly oil bore and chamber if the pistol is to be stored for a period of time.
10. Always remove any lubricant from the bore prior to firing the pistol.



RECOIL SPRING AND GUIDE ASSEMBLY

The P320 recoil spring and guide assembly is not to be disassembled. It is serviced as a single unit.

1. Clean the recoil spring guide assembly with CLP and a soft brush.
2. After cleaning, apply a light coat of CLP.

FRAME/GRIP MODULE ASSEMBLY

1. Wipe the frame and grip module assembly with a soft cloth.
2. Use cotton swabs to clean hard to reach areas. Pay special attention to the frame rails, takedown lever, and slide catch/release lever.
3. Lubricate the frame rails with a light coat of CLP.
4. Apply CLP to accessible functioning parts.
5. Clean the magazine well of any dirt, dust, or residue with a soft cloth.

3.3 PISTOL ASSEMBLY

1. Verify that the barrel is clear of all foreign matter.
2. Insert the barrel into the slide.

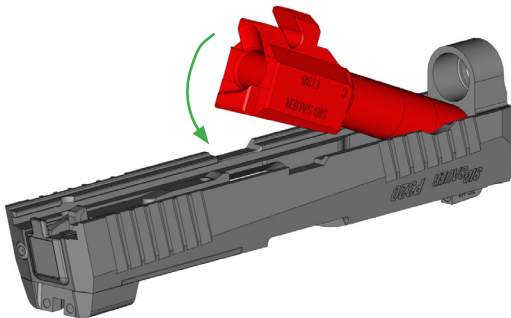

WARNING PARTS UNDER SPRING TENSION



BEFORE PROCEEDING, REFER TO THE MAINTENANCE SECTION OF THE SAFETY WARNINGS MANUAL.



3. For full size pistol, insert recoil spring guide assembly into slide.

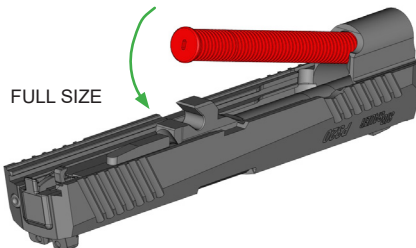

- a. For Carry, Compact, and Sub-Compact pistols, insert recoil spring assembly into slide as shown. The spring guide must be rotated so the flats are vertical.

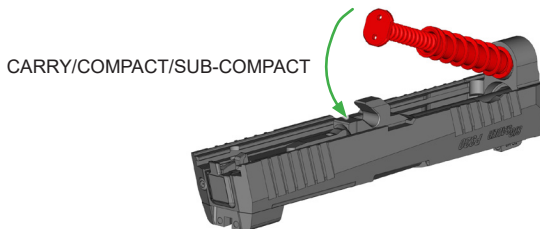

- b. For X5 Legion, insert guide rod into spring then compress spring while inserting the guide rod and spring into slide. Head of spring guide should rest against barrel lug.

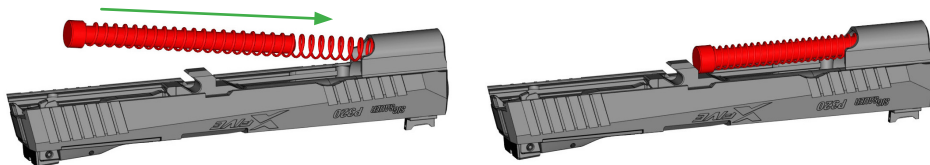

X5 LEGION

4. Ensure the takedown lever is rotated clockwise until it stops.

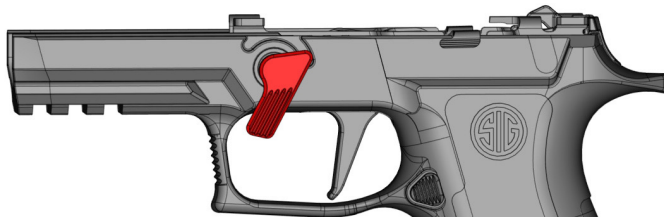



5. Guide the slide onto the frame rails from the front.
6. Retract the slide fully to the rear. Engage the slide catch/release lever to lock the slide in the open position.
7. Rotate the takedown lever counterclockwise until it stops.

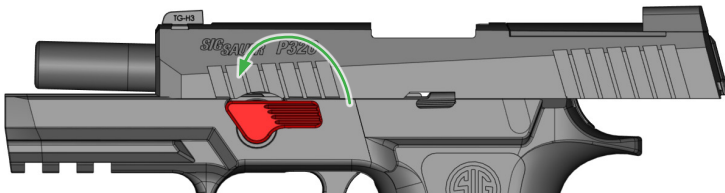

8. Press the slide catch/release lever to release the slide.

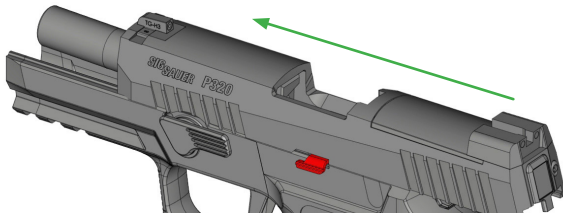

4.0 MAGAZINE MAINTENANCE

4.1 MAGAZINE DISASSEMBLY



WARNING PARTS UNDER SPRING TENSION



BEFORE PROCEEDING, REFER TO THE MAINTENANCE SECTION OF THE SAFETY WARNINGS MANUAL.

1. Using a punch or similar tool, push the tab of the magazine insert forward then down to release and remove the floorplate.

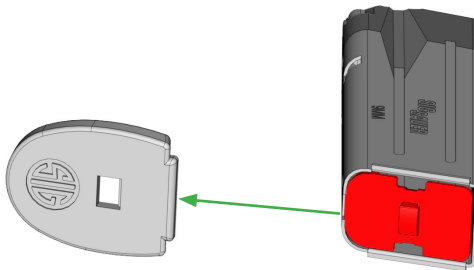



2. Remove the magazine follower and magazine spring from the magazine tube.

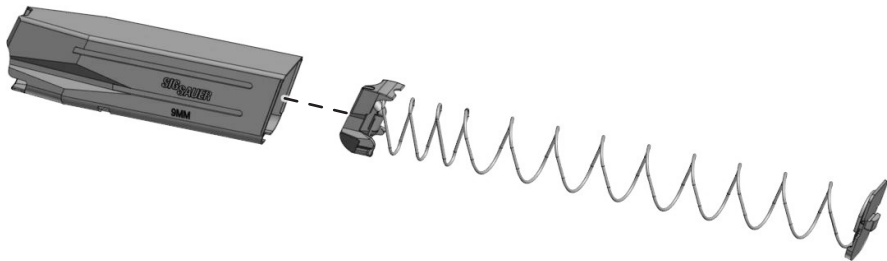

4.2 CLEANING

1. Wipe the magazine tube and follower with a cloth. Clean the magazine tube and follower with a soft brush and CLP.
2. Use a cloth to clean the magazine spring, floorplate, and base plate.
3. Apply a light coat of CLP to the spring and magazine tube.

4.3 MAGAZINE ASSEMBLY

1. Place the magazine follower on the magazine spring and insert it into the bottom of the magazine tube.



WARNING PARTS UNDER SPRING TENSION



BEFORE PROCEEDING, REFER TO THE MAINTENANCE SECTION OF THE SAFETY WARNINGS MANUAL.

2. Compress the magazine spring fully into magazine tube until the magazine insert is flush with the bottom of the magazine tube.

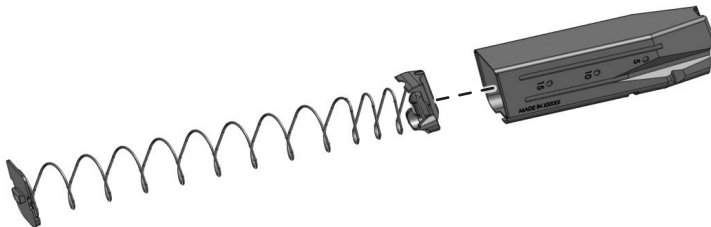



3. Holding the magazine insert in place, slide the magazine floorplate onto the magazine tube lips until the magazine floorplate is locked in place by the magazine insert.

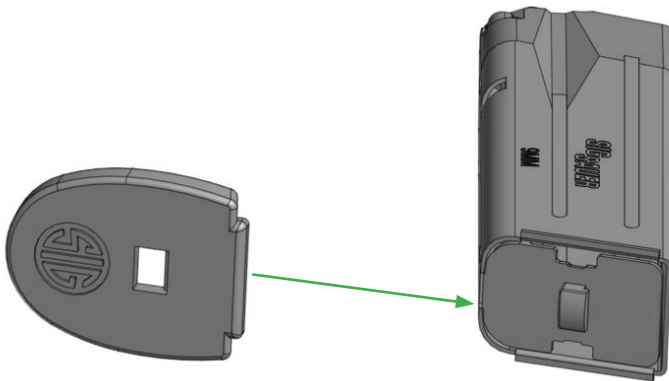

5.0 FUNCTION CHECK

A function check is performed on the assembled pistol to verify its proper function. It should be performed after the completion of repairs and after each cleaning and assembly of the pistol.



WARNING UNLOAD/CLEAR



BEFORE PROCEEDING, REFER TO THE MAINTENANCE SECTION OF THE SAFETY WARNINGS MANUAL.

1. Insert an empty magazine into the magazine well. There should be an audible click and the magazine catch/release should hold the magazine in place.
2. Grasp the slide and pull it completely to the rear. The follower of the magazine should push up the slide catch/release lever, locking the slide to the rear.
3. Press the magazine catch/release. The magazine must fall free of the pistol under its own weight. Press the slide catch/release lever to release the slide to its forward position.

IF THE PISTOL IS NOT EQUIPPED WITH A MAGAZINE DISCONNECT, SKIP TO STEP 6.

4. With the pistol pointed in a safe direction, pull the trigger. Nothing should happen. Release the trigger.
5. Insert an empty magazine. Pull the trigger. The striker should release with an audible click.
6. Grasp the slide and pull it completely to the rear. Press the slide catch/release lever to release the slide.



IF THE PISTOL IS NOT EQUIPPED WITH A MANUAL SAFETY, SKIP TO STEP 11.

7. Push up on the manual safety lever to engage the safety.
8. Press the trigger. The striker should NOT be released. Release the trigger.
9. Press down on the manual safety lever to disengage the safety.
10. Press the trigger to the rear and HOLD. The striker should release and there should be an audible click.
11. With the trigger still pressed to the rear, pull the slide completely to the rear and release.
12. Release the trigger. There should be a light audible click as the striker resets.
13. Press the trigger. The striker should release and there should be an audible click.

CAUTION

NEVER USE A FIREARM OR MAGAZINE THAT SHOWS SIGNS OF DAMAGE OR FAILS A FUNCTION CHECK. VERIFY THE MAGAZINE IS THE CORRECT MODEL AND CALIBER FOR THE PISTOL. IF THE CONDITION OR FUNCTION OF THE PISTOL OR MAGAZINE IS SUSPECT, RETURN THE PISTOL OR MAGAZINE TO SIG SAUER FOR EVALUATION.

6.0 PISTOL ADJUSTMENTS



WARNING UNLOAD/CLEAR



BEFORE PROCEEDING, REFER TO THE MAINTENANCE SECTION OF THE SAFETY WARNINGS MANUAL.

6.1 TORQUE SPECIFICATIONS

NOTE

Torque values will be listed as in-lbf for inch pounds of force and ft-lbf for foot pounds of force. If there is no Nylok® patch present on the fastener, use specified Loctite®.

Fasteners with Nylok patch are reusable. Do not remove Nylok patch if present. Fasteners with Loctite must have old Loctite removed and threads cleaned prior to applying new Loctite.



NOMENCLATURE	PAGE	QTY	in-lbf	nm	THREAD LOCKER OR EQUIVALENT
Sight Plate Screws	58	2	20	2.26	LOCTITE 243
Blanking Plate Screws	62	2	25	2.82	LOCTITE 243
Romeo Mounting Screws	65	2	25	2.82	LOCTITE 243
Barrel Compensator Threads	69	1	N/A	N/A	LOCTITE 246
Compensator Attachment Screws	70	2	20	2.26	LOCTITE 243
Magazine Funnel Screw	75	1	6	.67	LOCTITE 243
AXG Magazine Funnel Screw	75	1	11	1.24	LOCTITE 243
AXG Grip Screw	126	4	12	1.35	LOCTITE 243

6.2 SIGHT PLATE REMOVAL AND INSTALLATION

6.2.1 SIGHT PLATE REMOVAL

1. Disassemble the pistol. See section 3.1 Pistol Disassembly.
2. Push in on the extractor plus pin with a pin punch and pull the rear slide cap down and out of the slide.

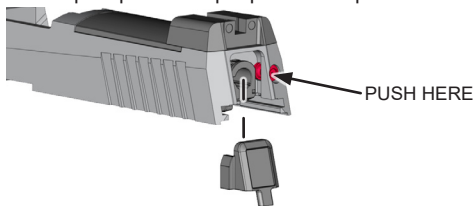

3. Remove the extractor plus pin, extractor spring, extractor pin, and extractor from slide.

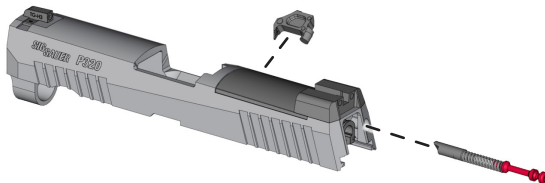



4. Remove the striker assembly from the slide.

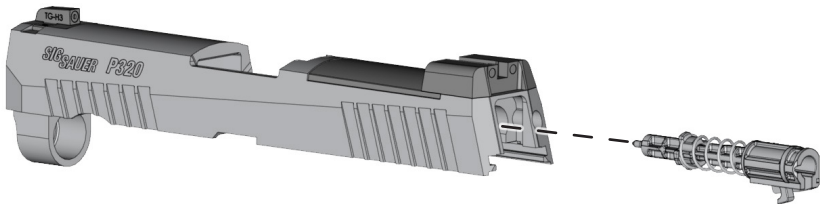

5. Using a 3/32 in. hex drive bit, remove the sight plate screws from the bottom of the slide.

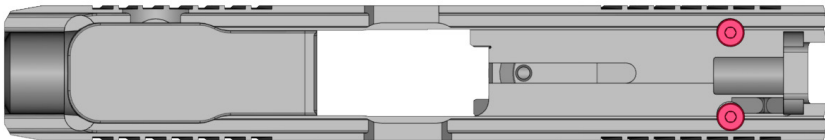

6. Lift the sight and plate from the slide to expose the LCI post (if equipped), then remove the LCI post and spring from the slide.

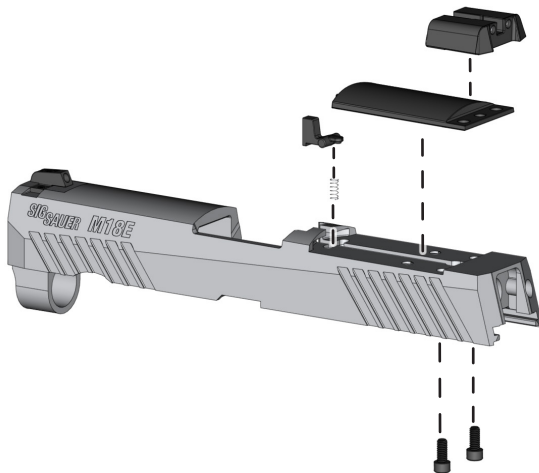



6.2.2 SIGHT PLATE INSTALLATION

NOTE

The sight plate screws are for securing the rear sight and sight plate only.

1. Install LCI post and spring into slide.
2. Install sight plate and sight onto slide and hold LCI post and spring in place.
3. Insert sight plate screws into the bottom of slide and tighten to 20 in-lbf using a 3/32 in. hex drive bit.

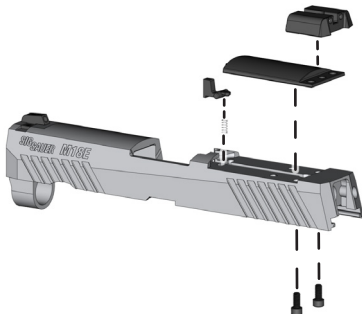

4. Insert the striker assembly into the rear of the slide.

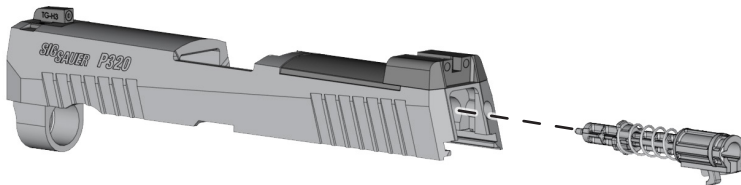

5. Insert the extractor into the right side of the slide.

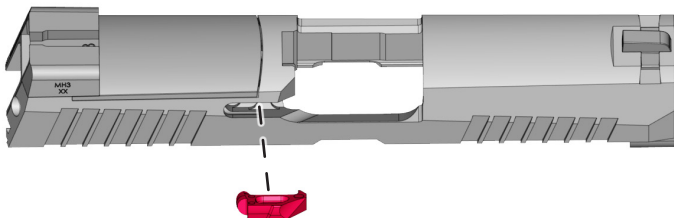



6. Insert the extractor pin, extractor spring, and extractor plus pin into the channel on the right side of the slide. Ensure the flat surface of the extractor pin rests on the post of the extractor.

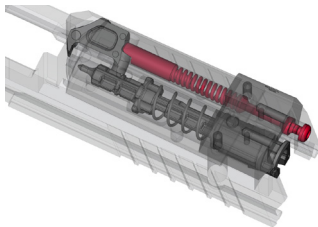

7. Start the rear slide cap up into the slots in the rear of the slide. Press the extractor plus pin inward and push the rear slide cap the remaining way into slide. Release pressure on the extractor plus pin.

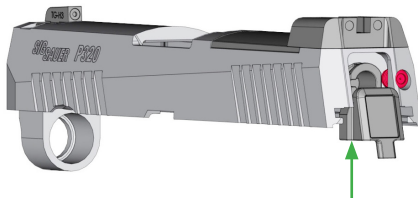

6.3 BLANKING PLATE REMOVAL AND INSTALLATION

6.3.1 BLANKING PLATE REMOVAL

1. Using a T20 drive bit, remove the blanking plate screws from the top of the slide.

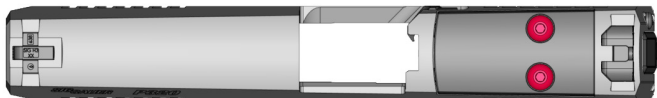

2. Remove the blanking plate.

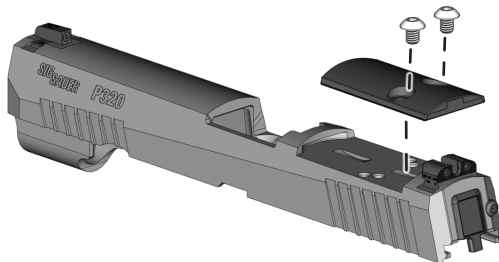



6.3.2 BLANKING PLATE INSTALLATION

NOTE

The blanking plate screws are for securing the blanking plate only.

1. Place the blanking plate into its slot in the slide.
2. Insert blanking plate screws and tighten to 25 in-lbf using a T20 drive bit.

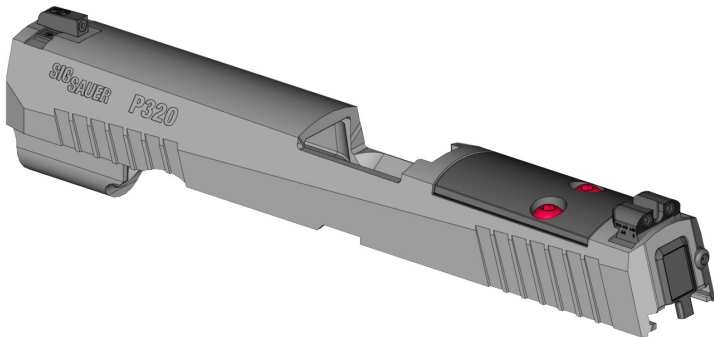

6.4 ROMEO RED DOT OPTIC REMOVAL AND INSTALLATION

6.4.1 ROMEO REMOVAL

1. Using a 1/8 in. hex drive bit, remove the ROMEO mounting screws from the top of the slide.

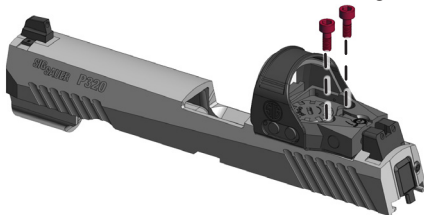

2. Remove the ROMEO from the slide and pull it out of the shroud (if equipped).

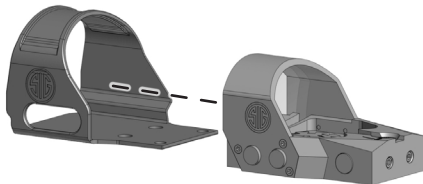



6.4.2 ROMEO INSTALLATION

1. Insert the ROMEO into the shroud (if equipped).

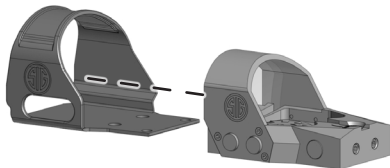

2. Place the ROMEO and shroud assembly on the slide, aligning the screw holes.

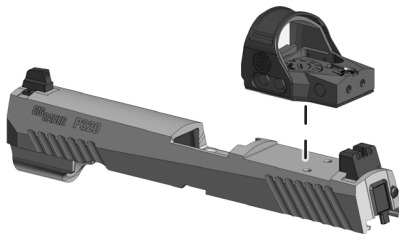

3. Install the ROMEO screws with a 1/8 in. hex drive bit and torque to 25 in-lbf.
4. Refer to the ROMEO manual for zeroing and sight adjustments.

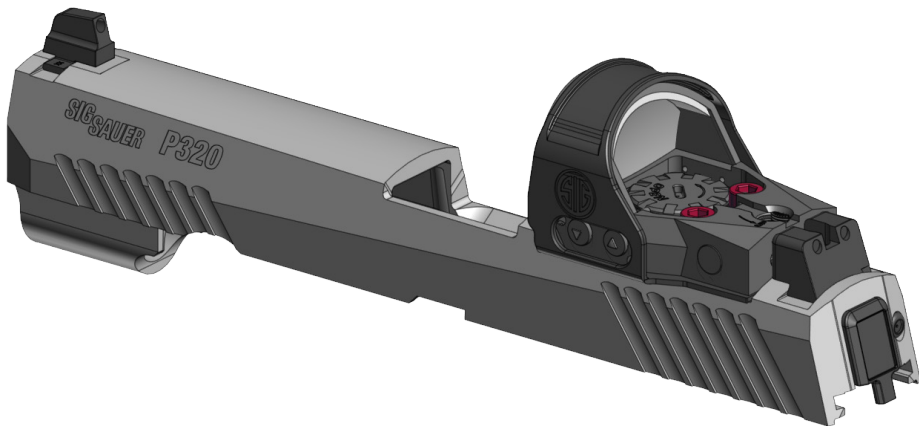



6.5 COMPENSATOR REMOVAL AND INSTALLATION

6.5.1 COMPENSATOR REMOVAL

CAUTION

ENSURE THE COMPENSATOR SCREWS ARE REMOVED PRIOR TO ATTEMPTING TO REMOVE THE COMPENSATOR FROM THE BARREL. FAILURE TO DO SO WILL RESULT IN DAMAGE TO THE FIREARM.

NOTE

REMOVING THE COMPENSATOR IS NOT REQUIRED FOR NORMAL PREVENTIVE MAINTENANCE OF THE PISTOL. COMPENSATOR REMOVAL AND REPLACEMENT SHOULD ONLY BE PERFORMED SHOULD THE COMPENSATOR NEED CLEANING OR BECOME LOOSE DURING SHOOTING.

1. Use a drive bit handle with a T10 drive bit to remove compensator attachment screws.
2. Unscrew the compensator to remove it from the barrel.

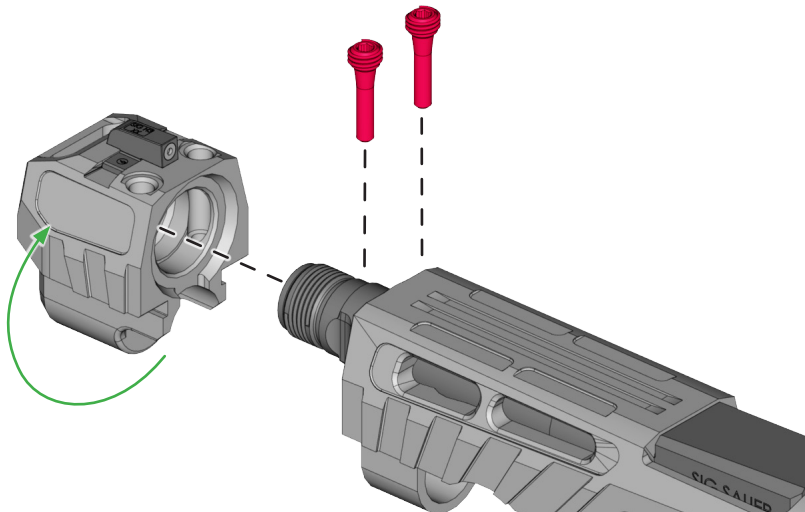



3. Remove the barrel from the slide.

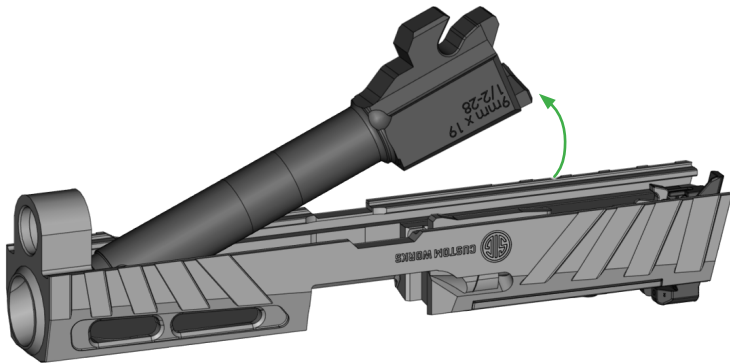

6.5.2 COMPENSATOR INSTALLATION

NOTE

Before installing the compensator, clean and degrease the threads of the barrel and compensator.

1. Insert the barrel into the slide.
2. Apply LOCTITE 246 to the threads of the barrel and compensator.
3. Thread the compensator onto the barrel until it stops. Unscrew the compensator until the vertical slots in the barrel align with the screw holes in the compensator.

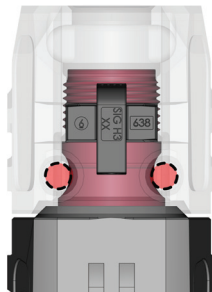
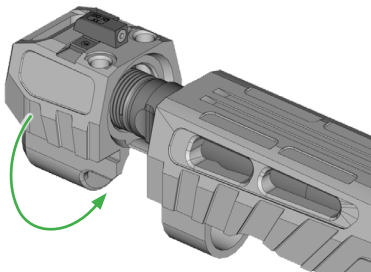



4. Using a T10 drive bit, install the compensator attachment screws into the compensator and torque to 20 in-lbf. Ensure the compensator is secured to the barrel.

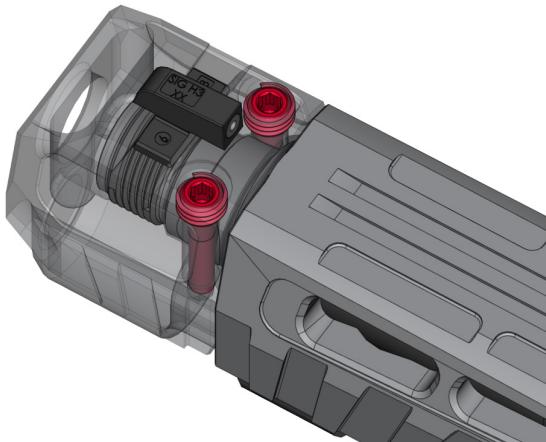

6.6 MAGAZINE CATCH/RELEASE REMOVAL AND INSTALLATION



WARNING UNLOAD/CLEAR



BEFORE PROCEEDING, REFER TO THE MAINTENANCE SECTION OF THE SAFETY WARNINGS MANUAL.

6.6.1 MAGAZINE CATCH/RELEASE REMOVAL

NOTE

This procedure can be performed with or without the slide removed from the pistol.

1. Ensure that the magazine is removed and the pistol is unloaded and cleared. See section 2.8 Unloading and Clearing the Pistol.
2. Press the magazine catch/release until the opposite side protrudes from the grip module. A small hole should be visible in the back of the catch/release.



3. Press the end of a small round pin, such as a paper clip, into the hole of the magazine catch/release. This will release the magazine catch stop.
4. Work the magazine catch stop out of magazine catch/release with the pin using a back-and-forth motion.

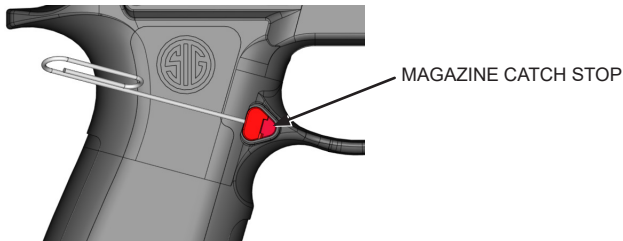

5. Remove the magazine catch stop, magazine catch/release, and the magazine catch spring from the grip module.

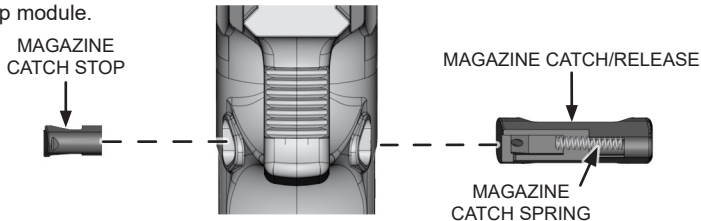

6.6.2 MAGAZINE CATCH/RELEASE INSTALLATION

NOTE

Holding the pistol with the muzzle facing downward will aid in keeping the magazine catch/release and spring in place for ease of installation.

1. Insert the magazine catch/release and the spring into the desired side of the grip module and completely depress the magazine catch/release.
2. Insert the magazine catch stop into the magazine catch/release until it snaps into place. Release the magazine catch/release.

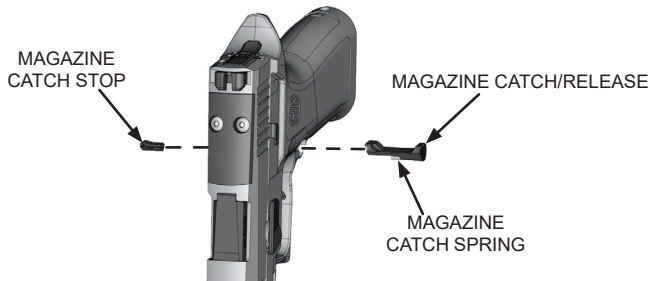



6.7 MAGAZINE FUNNEL REMOVAL AND INSTALLATION

Some P320 pistols come with a detachable magazine funnel. This magazine funnel facilitates faster reloading of the pistol. A magazine funnel requires the use of extended magazines or magazines with extended floorplates in order to ensure the inserted magazine is properly seated in the grip module.

6.7.1 MAGAZINE FUNNEL REMOVAL

1. For standard magazine funnels, use a T10 drive bit to remove the funnel screw from the rear of the grip module and detach the magazine funnel.
2. For AXG magazine wells, use a T10 drive bit to remove the funnel screw from the bottom of the grip module and detach the magazine funnel.

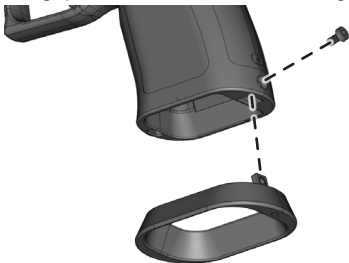

STANDARD MAGAZINE FUNNEL



AXG MAGAZINE FUNNEL

6.7.2 MAGAZINE FUNNEL INSTALLATION

1. Insert tabs of magazine funnel into appropriate slots in bottom of grip module.
2. For standard magazine funnel screw, use a T10 drive bit to thread funnel screw into rear of grip module and tighten to 6 in-lbf.
3. For AXG magazine funnel screw, use a T10 drive bit to thread funnel screw into bottom of grip module and tighten to 11 in-lbf.

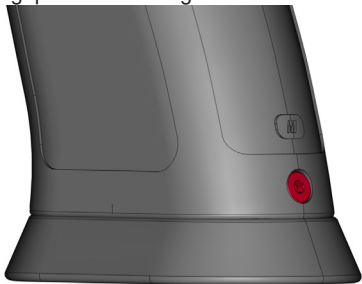

STANDARD MAGAZINE FUNNEL



AXG MAGAZINE FUNNEL



6.8 FIRE CONTROL UNIT (FCU) REMOVAL AND INSTALLATION

6.8.1 FCU REMOVAL

1. Remove the slide assembly. Disassembling the barrel, recoil spring, and recoil spring guide is not necessary. See section 3.1 Pistol Disassembly.
2. Rotate and pull the takedown lever outward simultaneously to remove.
3. Push the FCU forward.

IF THE PISTOL IS NOT EQUIPPED WITH A MAGAZINE DISCONNECT MECHANISM, SKIP TO STEP 5.

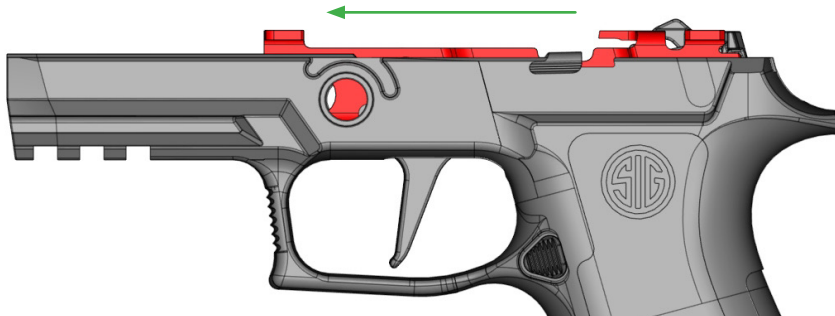

4. To overcome the magazine disconnect for disassembly, access the magazine disconnect mechanism through the magazine well of the grip module. Slightly lift the magazine disconnect while applying pulling on the trigger, allowing it to clear the rectangular cutout in the grip module.

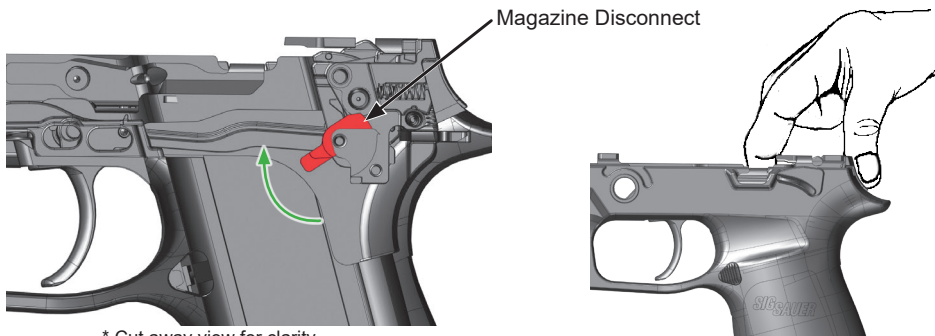

* Cut away view for clarity



5. Pull up on the frame rails, then rotate the FCU up and out from the grip module.

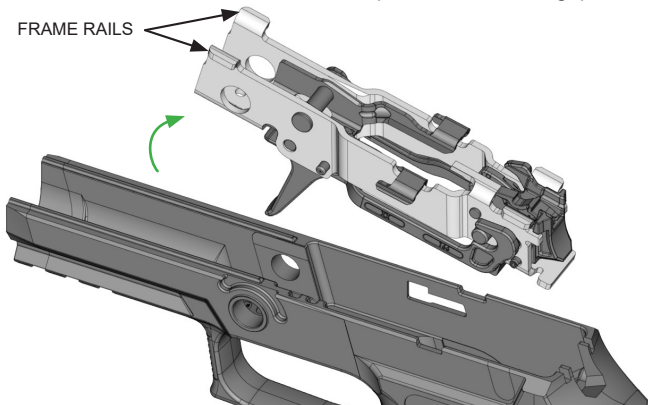

CAUTION

NO FURTHER DISASSEMBLY OF THE FIRE CONTROL UNIT (FCU) IS AUTHORIZED.

6.8.2 FCU INSTALLATION

1. Insert the FCU locking tab into the mating slot inside the rear of the grip module.

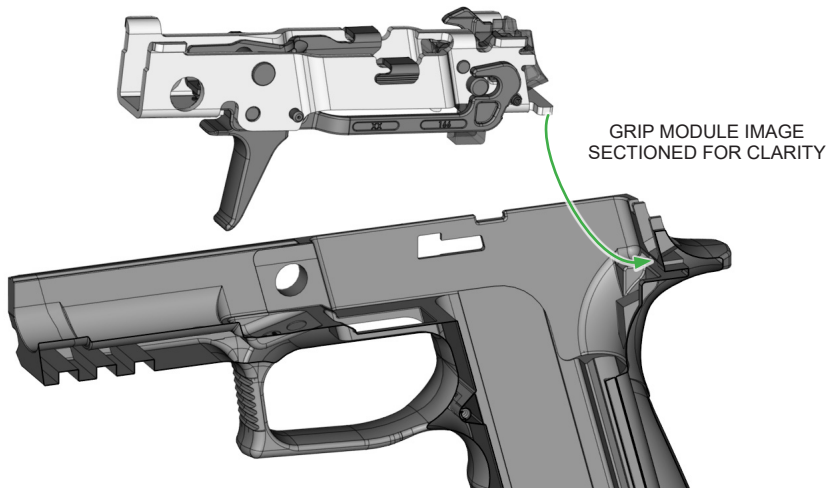



2. Press down on the frame rails and pivot the FCU into position.

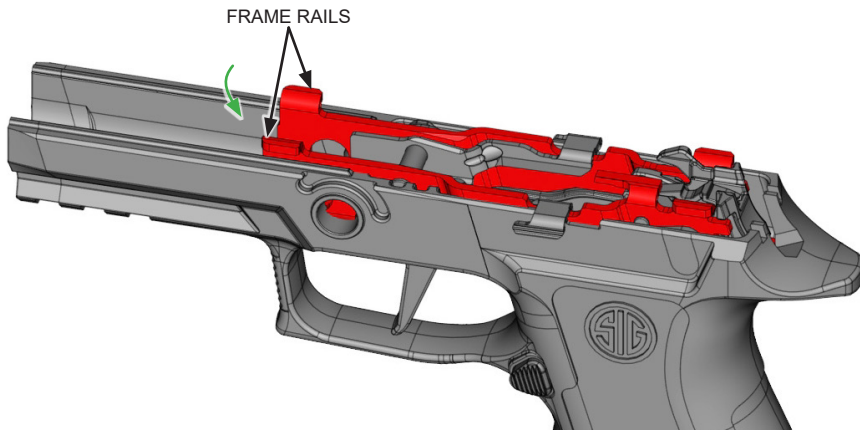

3. Insert the takedown lever (turn and push simultaneously) through the grip module and FCU, locking the fire control unit in place.

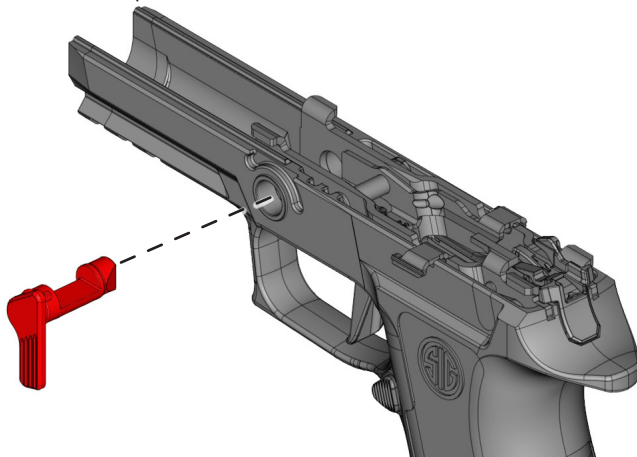

4. Assemble the pistol. See section 3.3 Pistol Assembly.



7.0 SIGHTS



WARNING TRITIUM SIGHTS



BEFORE PROCEEDING, REFER TO THE SIGHTS SECTION OF THE SAFETY WARNINGS MANUAL.

7.1 GENERAL INFORMATION

The SIG SAUER P320 pistol is equipped with drift adjustable fixed sights. The sights consist of a rear sight and a front sight blade, designed and dimensioned to ensure rapid target acquisition even when visibility is poor. Some P320 models are equipped with a fully adjustable rear sight.

CAUTION

SIG SAUER SUGGESTS THAT FIXED-SIGHT CORRECTIONS SHOULD BE PERFORMED ONLY BY A CERTIFIED SIG SAUER ARMORER. FAILURE TO COMPLY COULD CAUSE DAMAGE TO THE PISTOL.

7.2 WINDAGE (LEFT/RIGHT) ADJUSTMENT



WARNING SIGHT ADJUSTMENT



BEFORE PROCEEDING, REFER TO THE SIGHTS SECTION OF THE SAFETY WARNINGS MANUAL.

Change the windage by moving the rear sight either to the left or right in its dovetail. When adjusting sights, remember this rule: Move the rear sight in the desired direction. Moving the rear sight 0.020" in the dovetail changes the point of impact by approximately 3" at 25 yards.

NOTE

SIG SAUER has a Sight Adjustment Tool available that makes it easier to adjust and change fixed sights.

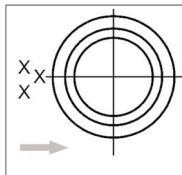

Impact left of point of aim



7.3 ELEVATION (UP/DOWN) ADJUSTMENT

There are different height combinations available for the front and rear sights. The sights are numbered according to their height. Elevation can be adjusted by changing either the rear or front sight. It is easier to change the rear sight first.

There are six rear sight heights available. Each rear sight change will move the impact of the bullet approximately 2" at 25 yards.

There are five front sight heights available. Each front sight change will move the impact of the bullet approximately 1" at 25 yards.

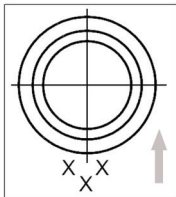

Impact below point of aim

When changing sights, remember this rule: NUMBERS UP, GROUPS UP; NUMBERS DOWN, GROUPS DOWN. This is true for both front & rear sights.

7.4 SIGHT ADJUSTMENT P320 XSERIES PISTOL

Some P320 pistols have a fully adjustable rear sight.

Elevation: Rotated the elevation adjustment screw counterclockwise to raise the rear sight, moving the point of impact up. Rotate the screw clockwise to lower the rear sight, moving the point of impact down.

Windage: Rotate the windage screw counterclockwise to move the rear sight aperture left, moving the point of impact left. Rotate the screw clockwise to move the rear sight aperture right, moving the point of impact right.

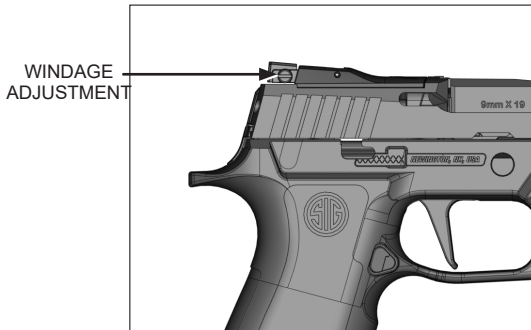
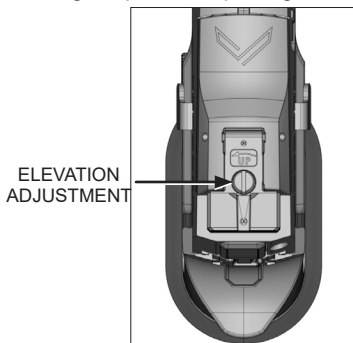



8.0 STORAGE AND TRANSPORTATION



WARNING UNLOAD/CLEAR



BEFORE PROCEEDING, REFER TO THE MAINTENANCE SECTION OF THE SAFETY WARNINGS MANUAL.



WARNING STORAGE

BEFORE PROCEEDING, REFER TO THE STORAGE SECTION OF THE SAFETY WARNINGS MANUAL.

Short Term Storage (90 days or less)

1. Ensure the chamber and magazine do not contain live ammunition.
2. Clean the bore and chamber
3. Apply a generous coat of CLP to the chamber and bore.
4. Apply a light coat of CLP to all other metal surfaces for corrosion protection.

Long Term Storage (90 days or longer)

1. Ensure the firearm is thoroughly cleaned.
2. Apply a medium coat of CLP to the chamber and bore.
3. Apply a light coat of CLP to all other metal surfaces for corrosion protection.
4. Wrap the firearm with a waterproof material.
5. Place the firearm in a corrosion resistant barrier bag.

Environmental Storage Recommendations (Armory)

Provide humidity control to limit the relative humidity to no greater than 40% at 80°F (26.7°C). If personnel will be working in these areas, design to 68°F (20.0°C) dry bulb and 40% RH for indoor design heating conditions, and 75°F (23.9°C) dry bulb and 40% RH for indoor design cooling conditions.



9.0 TROUBLESHOOTING GUIDE



WARNING STOPPAGE



BEFORE PROCEEDING, REFER TO THE TROUBLESHOOTING SECTION OF THE SAFETY WARNINGS MANUAL.

When practical, always stop shooting and investigate the cause of a stoppage in the manner outlined below.

If the firearm develops a stoppage while shooting, or a discharged round sounds or feels unusual, stop shooting immediately. It may be dangerous to continue. Do not try one more shot. Keep the firearm pointed in a safe direction and unload and clear the firearm immediately by removing the magazine, locking the slide to the rear and clearing any expended or live ammunition from the firearm, visually and physically checking the chamber, breech face, and magazine well.

With the firearm unloaded and cleared, perform an additional visual inspection of the firearm and the ammunition. If a bore obstruction exists, refer to section 9.1 Obstructed Bore. If damage to the firearm is found, the stoppage persists, or a malfunction is suspected, take the firearm to a certified SIG SAUER Armorer for service.

9.1 OBSTRUCTED BORE



WARNING OBSTRUCTED BORE



BEFORE PROCEEDING, REFER TO THE TROUBLESHOOTING SECTION OF THE SAFETY WARNINGS MANUAL.

Immediately stop shooting and keep the firearm pointed in a safe direction whenever:

- There is difficulty or unusual resistance in chambering a cartridge;
- A cartridge misfires (does not go off);
- The mechanism fails to extract a fired cartridge case;
- Unburned grains of propellant powder are discovered spilled in the mechanism;
- A shot sounds weak or abnormal.

It is possible that a bullet is lodged part way down the barrel. If a bullet is in the bore, do not attempt to shoot it out by using another cartridge or by blowing it out with a blank or a cartridge from which the bullet has been removed. Bullets can become lodged in the barrel when the cartridge has been improperly loaded without propellant powder, the powder fails to ignite, or the bullet was not properly seated in the cartridge case.

Immediately unload and clear the firearm. Field strip the firearm and look through the bore of the barrel. It is not sufficient to merely look in the chamber; a bullet may be lodged some distance down the barrel where it cannot easily be seen. Attempt to remove the bullet by tapping it out with a cleaning rod. If the bullet can be removed, clean any unburned powder grains from the bore, chamber, and mechanism before resuming shooting. If the bullet cannot be dislodged, take the firearm to a certified SIG SAUER Armorer.



9.2 COOK-OFF



WARNING COOK-OFF



BEFORE PROCEEDING, REFER TO THE TROUBLESHOOTING SECTION OF THE SAFETY WARNINGS MANUAL.

If the pistol stops firing with a live cartridge in the chamber of a hot barrel due to a misfire or stoppage:

1. Keep pistol pointed in a safe direction to ensure neither the user nor any other person would be injured by the possibility of a cartridge “cooking-off”.
2. Immediately remove the magazine and chambered cartridge.
3. If the cartridge cannot be removed within 10 seconds, keep the pistol pointed in a safe direction and wait at least 15 minutes.

9.3 GENERAL TROUBLESHOOTING

Stoppage	Cause	Correction
<i>Failure to Feed</i>		
No cartridge fed into chamber. Cartridge partially still in magazine.	Magazine not properly inserted or is deformed or dirty.	Correctly insert magazine or replace magazine.
	Damaged/broken magazine spring.	Replace magazine.
	Relaxed grip / shooter induced.	Increase grip on pistol.
<i>Failure to Chamber</i>		
Cartridge is free from magazine but not fully seated into chamber.	Dirty chamber.	Clean chamber.
	Damaged ammunition.	Replace ammunition.
	Weak or broken recoil spring guide assembly.	Return to SIG SAUER for repair.
	Relaxed grip / shooter induced.	Adjust or tighten grip on pistol.
<i>Failure to Fire</i>		
Trigger is pressed but no detonation.	Faulty ammunition.	Replace ammunition.
	Slide not fully locked forward.	Pull slide to rear and release.
	Damaged/broken striker assembly.	Return to SIG SAUER for repair.



Stoppage	Cause	Correction
<i>Failure to Fire</i>		
Trigger is pressed but no detonation.	Magazine not fully inserted on models equipped with magazine disconnect mechanism.	Properly insert magazine into magazine well.
<i>Failure to Extract</i>		
Expend case remains in chamber.	Dirty chamber.	Clean chamber/bore.
	Broken extractor or extractor spring.	Return to SIG SAUER for repair.
<i>Failure to Eject</i>		
Expend case remains in ejection port.	Damaged/broken ejector/slide catch/release lever.	Return to SIG SAUER for repair.

9.4 MINIMIZING STOPPAGES

- Most stoppages can be minimized by cleaning and lubricating the pistol. See section 3.2 Cleaning the Pistol.
- Cleaning and lubricating the firearm after each range session will reduce the chances of a stoppage due to dirt and residue buildup.
- Perform maintenance if the firearm is exposed to extreme environmental conditions (rain, snow, freezing temperatures, etc.).
- Periodically inspect the pistol if it is to be stored for extended periods of time without use.
- Most stoppages are directly related to the magazine. Perform maintenance on the magazines as well as the firearm. See section 4.0 Magazine Maintenance.
- A good practice is to mark the magazines so a magazine that is related to a stoppage can be easily identified.



10.0 REPLACEMENT PARTS POLICY



WARNING

BEFORE PROCEEDING, REFER TO THE MAINTENANCE SECTION OF THE SAFETY WARNINGS MANUAL.

Parts Policy

Our Service Department maintains a full complement of replacement parts. Even though most gunsmiths have the knowledge, training, and the ability to make necessary repairs to the firearm, the skill and workmanship of any particular third-party gunsmith is totally beyond our control.

Should the firearm ever require service, it is strongly recommended that it be returned to SIG SAUER Inc. A firearm is a precision instrument and some replacement parts will require individual fitting to ensure correct operation. A wrong part, improper fitting, or incorrect mechanical adjustment may result in an unsafe condition or dangerous malfunction, damage to the firearm, or cause possible serious injury to the shooter or others.

IF ANY PART IS ORDERED WITHOUT RETURNING THE FIREARM TO SIG SAUER, Inc. the customer bears full responsibility for ensuring that the part supplied is correct for their particular firearm and is properly installed and fitted by a qualified gunsmith.

SIG SAUER INC. IS NOT RESPONSIBLE FOR THE FUNCTIONING OF ANY FIREARM IN WHICH REPLACEMENT PARTS ARE INSTALLED BY OTHERS.

THE USE OF AFTERMARKET PARTS IS NOT AUTHORIZED AND WILL VOID THE WARRANTY OF THIS FIREARM. THE REPLACEMENT OF ORIGINAL EQUIPMENT MANUFACTURER (OEM) SIG SAUER PARTS WITH AFTERMARKET PARTS IS UNAUTHORIZED AND IN SOME INSTANCES COULD ALTER THE FUNCTION OF THE FIREARM, CREATING A DANGER TO THE OPERATOR.

Scan the QR code below to visit the Small Parts Shopper page at sigsauer.com.





11.0 FACTORY REPAIR OF THE FIREARM

Contact Customer Service for questions or concerns regarding the performance or serviceability of the firearm. There are three ways to contact Customer Service:

Have the firearm's serial number available before contacting Customer Service.

1. Call (603) 610-3000, choose option 1.
2. Email CustomerService@sigsauer.com.
3. Go to <https://www.sigsauer.com/customer-support> to message Customer Service electronically. Scan the QR code below to visit the Customer Support page at [sigsauer.com](https://www.sigsauer.com).



11.1 RETURNING FIREARMS FOR REPAIR

Do not ship a firearm without an RMA number provided by Customer Service.



WARNING DO NOT SHIP AMMUNITION



BEFORE PROCEEDING, REFER TO THE RETURNING FIREARMS FOR REPAIR SECTION OF THE SAFETY WARNINGS MANUAL.

1. The RMA number allows SIG SAUER to track the status of the return from the time SIG SAUER receives the firearm until it is returned.
2. Package the firearm securely to prevent damage.
3. Do not include any accessories such as scopes or mounts unless directed to do so.
4. Some states and localities, require firearms to be shipped and returned to SIG SAUER using a federally licensed firearms dealer.
5. Federal law prohibits persons who do not possess a Federal Firearms License (FFL) from shipping a firearm via the U.S. Postal Service.
6. Any shipment of firearms outside U.S. borders is subject to the export laws of the United States and to the valid laws of the specific country.
7. SIG SAUER is not responsible for any damage to a firearm during shipping until it is received.
8. Firearms must be insured and prepaid prior to shipment (SIG SAUER does not accept collect shipments) to the address provided by Customer Service.



12.0 STANDARD SLIDE PARTS DIAGRAM

FRONT SIGHT



REAR SIGHT



SLIDE

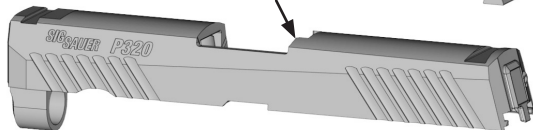

BARREL

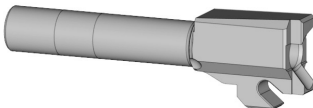

FULL-SIZE RECOIL SPRING
AND GUIDE ASSEMBLY

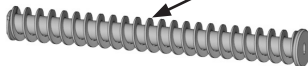

CARRY/COMPACT/SUB-
COMPACT RECOIL SPRING
AND GUIDE ASSEMBLY

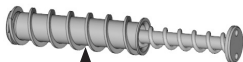

12.1 XSERIES SLIDE PARTS DIAGRAM

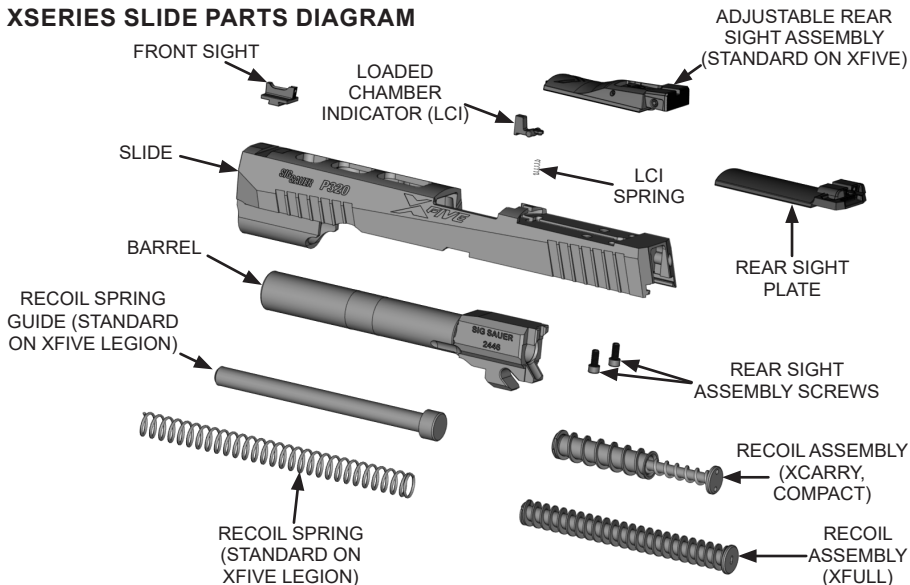



12.2 P320-RXP/XVTAC SLIDE PARTS DIAGRAM

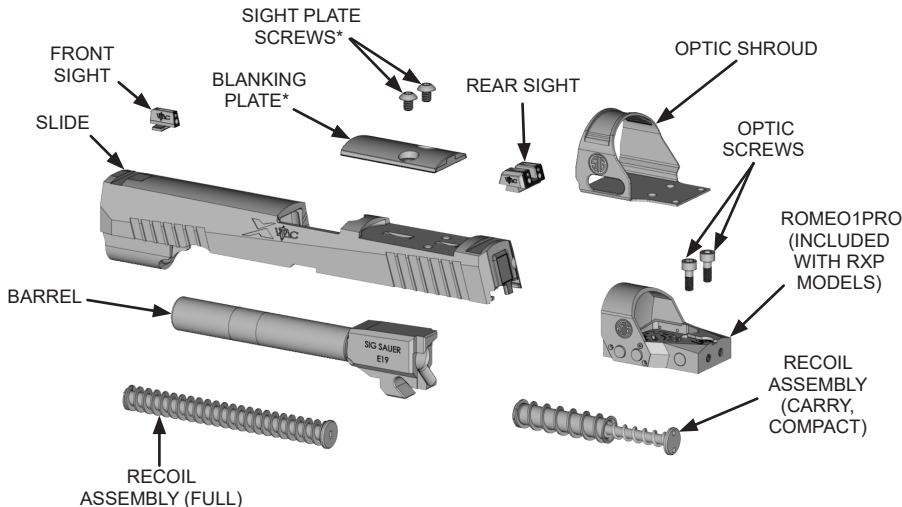

* Blanking plate and screws included with XSERIES RXP. Optional on standard RXP models.

12.3 P320 SPECTRE COMPENSATED SLIDE PARTS DIAGRAM

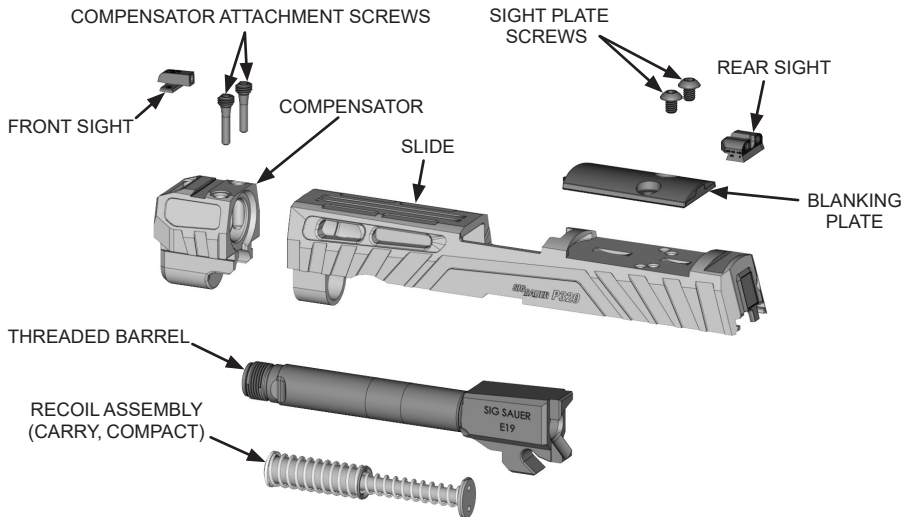



12.4 P320 PRO SLIDE PARTS DIAGRAM

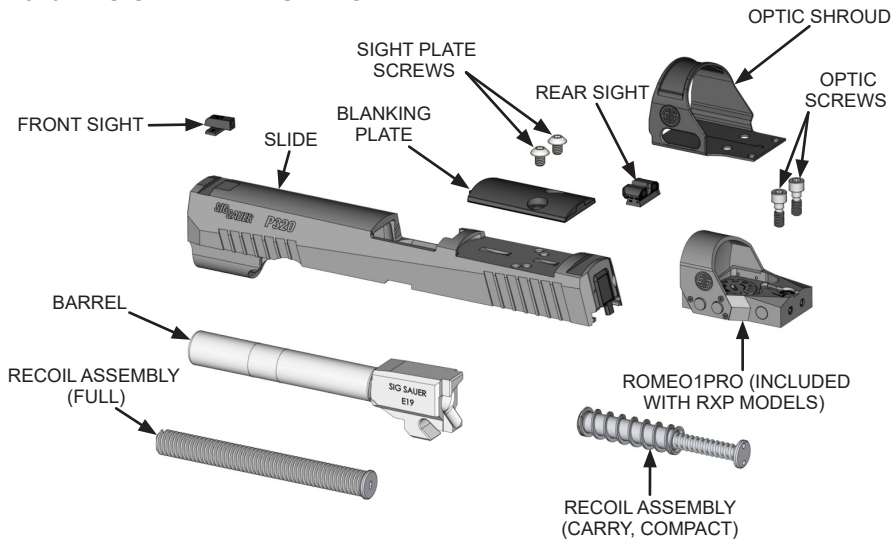

12.5 STANDARD FRAME PARTS DIAGRAM

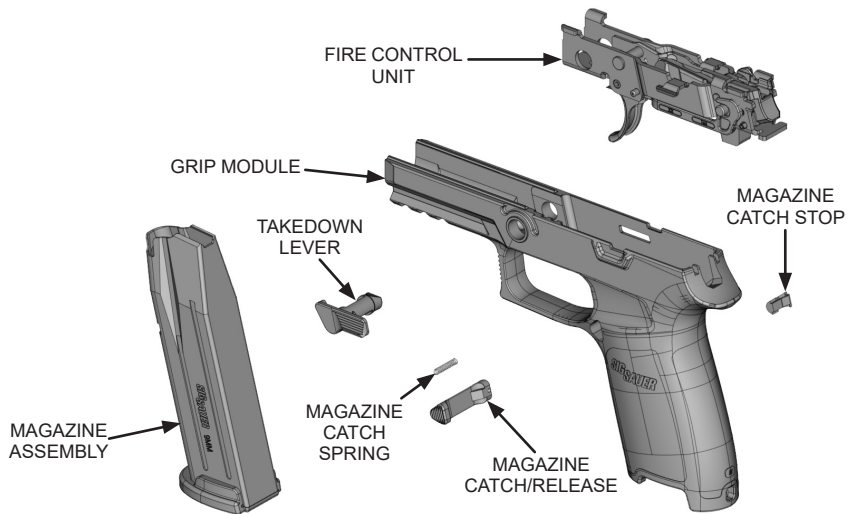



12.6 XSERIES FRAME PARTS DIAGRAM

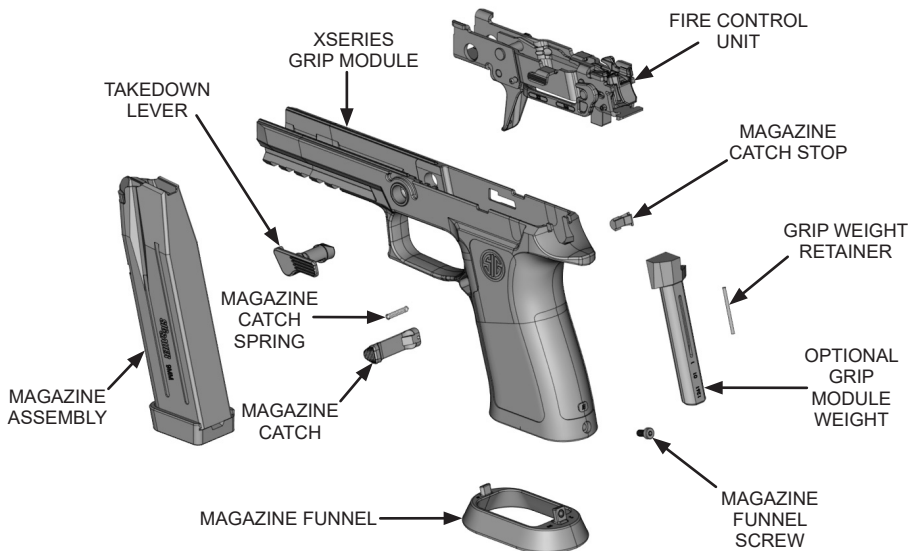

SIG SAUER INFINITE GUARANTEE™

For warranty information on new SIG SAUER firearms, scan the QR code below to visit the SIG SAUER Warranty Information and Registration page. New firearms can also be registered and warranty information can be found on the website.





NOTES:

NOTES:



sigsauer.com

**SIG SAUER, Inc.
72 Pease Boulevard, Newington, NH 03801 USA**

All trademarks, service marks, trade names, trade dress, product names, and logos appearing in this manual are the property of their respective owners. No trademark or service mark appearing in this manual may be used without written consent of the mark's owner.