

SIGSAUER®

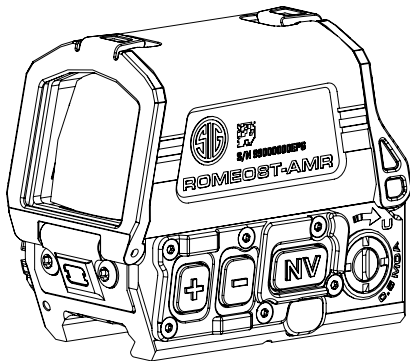

ROMEOST-AMR

MIL-SPEC Reflex Sight

OPERATOR'S MANUAL



**READ THE INSTRUCTIONS AND WARNINGS IN THIS MANUAL CAREFULLY BEFORE
USING THIS OPTIC; DO NOT DISCARD THIS MANUAL.**

CONTENTS

Introduction	3
Quick Start Guide – Setup	4
Operation Guide – Controls	5
Contents.	6
Key Features	7
ROMEO8T-AMR Product Identification	8
Operation	11
Installation.	16
Mounting The Sight	17
Sight Adjustments	18
Objective "Front" Accessories.	19
Ocular "Rear" Accessories	21
Titanium Shroud.	23
Maintenance	25
Troubleshooting	26
Specifications	28
SIG SAUER® Infinite Guarantee™	30

Introduction

The ROMEO8T-AMR is a compact 1x40 enclosed rifle optic intended for high performance and hard use. It allows the user to optimize the reticle uniquely between magnified and non-magnified use cases.

The ROMEO8T-AMR is covered by the SIG SAUER Infinite Guarantee.



Scan the QR code to visit sigsauer.com for additional information about SIG SAUER products, SIG SAUER Academy and the SIG Experience Center, special programs, and support.

QUICK START GUIDE – SETUP		
STEP	TASK	PAGE
1	Install battery, power on, function test	11
2	Mount on firearm	17
3	Select Reticle	13
4	Zero Reticle	18
5	Troubleshooting	26

TORQUE SPECS	DRIVER	TORQUE
Cross Bolt (H on Page 9)	Half Inch Hex	65 in-lbf
Objective Lens Accessory Screws (K on Page 9)	T10	8-10 in-lbf
Mounting Screws (O on Page 9)	T10	8-10 in-lbf

Notes for next page:

¹ Sight is power OFF prior

² AMR™ comes enabled from the factory

³ Sight is powered ON prior

⁴ Reticle will fast blink for 2 seconds

OPERATION GUIDE – CONTROLS			
DISPLAY	ACTION	BUTTON(S)	PAGE
Power Sight On/Off	Long Press	▲ or ▼	12
Power Sight On at Max Brightness	Long Press	[NV]	12
MOTAC™ Illumination Power Down	N/A	2 minutes of Inactivity	12
MOTAC™ Illumination Power Up	N/A	Any sudden movement	12
BRIGHTNESS			
Increase Brightness	Tap	▲	12
Decrease Brightness	Tap	▼	12
Max Brightness	Tap	[NV] (Tap again to return to last setting)	12
EMITTERS			
Enter Reticle Selection Mode	Long Press	▲ + ▼	13
Select Preferred Reticle	Tap	▲ or ▼ to select current reticle	13
FIRMWARE			
AMR Menu ^{1,2}	Long Press	(With Sight Off) ▲ + ▼	14
Enable AMR	Tap	Any Button when reticle is on 2-Blink	14
Disable AMR	Tap	Any Button when reticle is on 1-Blink	14
Factory Reset ^{3,4}	Long Press	▲ + ▼ + [NV]	15

CONTENTS

- ROMEO8T-AMR 1x40mm MIL-SPEC Reflex Sight
- CR123 Battery
- T10 Impact Driver
- ROMEO Lens Pen
- Optic Multi-Tool
- Operator's Manual
- Clear Front Lens-Flip Back (Installed)¹
- Opaque Front Lens-Flip Back¹
- Clear Rear Lens-Flip Back (Installed)¹
- ARD Kill-Flash Front Lens Insert¹
- Titanium Shroud¹

¹ Included in select SKU's

KEY FEATURES

- AMR™ – Optimize reticle features and brightness based on magnified and non-magnified usage.
- 40mm Multi-Coated Mangin Lens – For massive field of view and forgiving sight acquisition.
- Quad Ballistic Circle Dot Reticle 2.0 – Optimized features and brightness for day, night, and extended range.
- 15 Brightness Settings including 3 optimized for passive NV.
- Dedicated NV Override Switch.
- D.A.R.C™ – Optimized optics for ideal reticle brightness and target clarity while using GEN3+ NV Devices.
- CR123 Battery combined with MOTAC™ yields 50,000+ hr runtime.
- Complete suite of integrated flip-backs and ARD Kill-Flash¹.
- 1.41" Absolute Co-Witness Sight Height.
- IPX8 Waterproof and Fog Proof Performance.

¹ Included in select SKU's

ROMEO8T-AMR PRODUCT IDENTIFICATION

- A — 40mm Multi-Coated Mangin Lens
- B — ▲ (Up) Brightness Adjustment
- C — ▼ (Down) Brightness Adjustment
- D — [NV] NV Override Button
- E — Elevation Adjustment
- F — Windage Adjustment
- G — Magnifier Detection
- H — Half-inch Hex Mount (65 in-lbs)
- I — CR123 Battery Cover and Compartment
- J — Battery Cap Lanyard Retainer
- K — T10 Mounting Flip-Back Mounting Screws
- L — Clear front lens flip-back (installed)¹
- M — Clear rear lens tear-away flip-back (installed)¹
- N — Titanium Shroud¹
- O — Shroud Screw¹

¹ Included in select SKU's

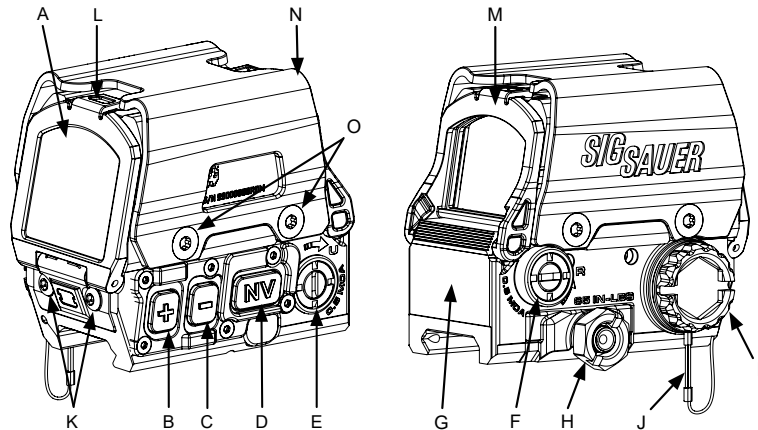

**WARNING UNLOAD/CLEAR**

BEFORE WORKING ON THE ROMEO8T-AMR SIGHT, ALWAYS ENSURE THAT THE FIREARM IS UNLOADED AND CLEARED WITH THE SAFETY ON AND POINTED IN A SAFE DIRECTION. FAILURE TO COMPLY COULD RESULT IN DEATH OR SERIOUS INJURY.

OPERATION**Installing the Battery**

The battery cap is located on the right side of the optic and is threaded into the housing.

1. Rotate the battery cover counterclockwise to remove. The battery cap is lanyard retained.
2. Install a fresh CR123 battery, positive (+) end into the battery compartment.
3. Install the battery cap carefully to avoid cross-threading and torque hand tight until it's firmly secure.

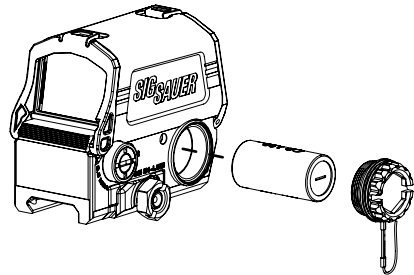

Turning Sight On and Off

- Power On to Previous Brightness Setting – Press and hold [▲] or [▼] until the reticle is displayed.
- Power On to Max Brightness Setting – Press and hold [NV] until the reticle is displayed.
- Power Off – Press and hold [▲] or [▼].

MOTAC™ Technology

This sight features MOTAC™. It will automatically turn off after 2 minutes of inactivity. As soon as the sight detects motion it will automatically power back on to the previous reticle and brightness setting.

Brightness Control

To increase or decrease reticle brightness tap [▲] or [▼]. Reticle will flash when Min or Max brightness setting is reached. There are 15 settings including 3 NV.

Reticle Selection

Press and hold [▲] + [▼] simultaneously until the reticle flashes. Release [▲] + [▼]. The reticle will flash as it scrolls through all possible options. Tap either [▲] or [▼] to lock-in the desired reticle when displayed.

NV Override

While the sight is on, tap [NV] to toggle between Max Brightness and the previous brightness setting.

AMR™ – Automatic Modified Reticle

Tracks the current reticle configuration and brightness level, stores, and applies it based on whether a magnifier is in optical alignment, or not. With AMR, the reticle can be optimized for close and far engagements, without compromise.

Example: End user selects circle dot reticle and sets the brightness to setting 13 for fast, close quarter engagement drills. Then the user flips the magnifier in-line with the red dot and looks through it at a small size steel target 400 meters away. They notice the reticle is too bright and too busy. They change the reticle from circle dot to dot with ballistic holds and reduce the brightness setting from 13 down to 10. The aiming dots present smaller, subtending less of the small steel target and allow for better first and 2nd round impacts on the target. Later, when the magnifier is flipped to the side or removed altogether, the reticle returns to the user's non-magnified preference, which was circle dot at setting 13. If the [▼] was tapped once, the brightness would reduce to setting 12, and this would become the new preferred non-magnified configuration.

NOTE

- To take advantage of AMR, an AMR capable red dot and an AMR capable Magnifier or Magnifier Mount is required.
- Magnifier must be mounted within 3 rail slots behind the red dot to ensure reliable detection.
- AMR comes enabled from the factory. To disable or re-enable AMR, Power Off the optic, then press and hold [▲] and [▼]. Reticle will enter a 1-blink, 2-blink scheme where 1-blink is AMR Disabled and 2-blink is AMR Enabled. Tap any button while on the desired mode to enable or disable AMR.

Factory Reset

Ensure optic is powered on. Press and hold [▲] + [▼] + [NV] simultaneously until reticle fast blinks for 2 seconds.

INSTALLATION



WARNING UNLOAD/CLEAR



BEFORE WORKING ON THE ROMEO8T-AMR SIGHT, ALWAYS ENSURE THAT THE FIREARM IS UNLOADED AND CLEARED WITH THE SAFETY ON AND POINTED IN A SAFE DIRECTION. FAILURE TO COMPLY COULD RESULT IN DEATH OR SERIOUS INJURY.

CAUTION

FAILURE TO FOLLOW INSTALLATION INSTRUCTIONS WILL RESULT IN THE SIGHT COMING LOOSE AND CAUSING DAMAGE TO THE OPTIC.

MOUNTING THE SIGHT

The ROMEO8T-AMR is designed with a 1.41" absolute co-witness and is intended for use on most types of firearms with an M1913 or STANAG rails. With infinite eye relief, the sight can be mounted anywhere on the rail, forward or back. To install the sight on a firearm, set the mount on the rail at the preferred eye relief, and push the sight forward into the rail lugs while torquing the half-inch nut to 65 in-lbf.

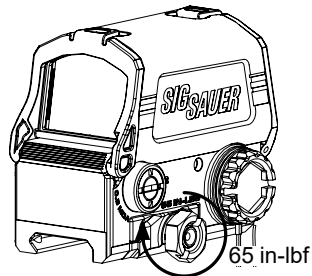

SIGHT ADJUSTMENTS

Elevation Adjustments – Using the provided multi-tool, coin or shell casing, turn the Elevation Adjustment clockwise (CW) to move the Point of Impact (POI) UP. To move the POI Down, rotate counterclockwise.

Windage Adjustments – Using the provided multi-tool, coin or shell casing, turn the Windage Adjustment clockwise to move the POI LEFT. To move the POI RIGHT, rotate counterclockwise.

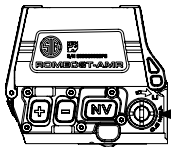

POI	1 Click	MOA	Real World
↑ U	↻	1/2	1/4" @ 50yds
↓ D	↻		

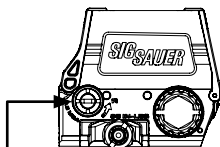

POI	1 Click	MOA	Real World
L ←	↻	1/2	1/4" @ 50yds
→ R	↻		

OBJECTIVE ("FRONT") ACCESSORIES

Select models can include accessories intended for the front of the optic such as a clear objective lens flip-back, opaque flip-back, and ARD Kill-Flash for mitigating downrange signature. For all of these, removal and installation is the same.

Removal

Using the provided T10 drive bit and Optic Multi-Tool to remove the (2) mounting screws, then pull the objective accessory off of the optic.

Stow the screws and objective accessory for later use.

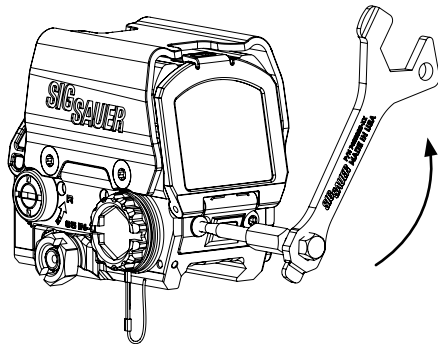

Installation

Press the accessory to the optic main body. Line up the mounting holes and install the (2) mounting screws using the provided T10 driver. Torque to 8-10 in-lbs.

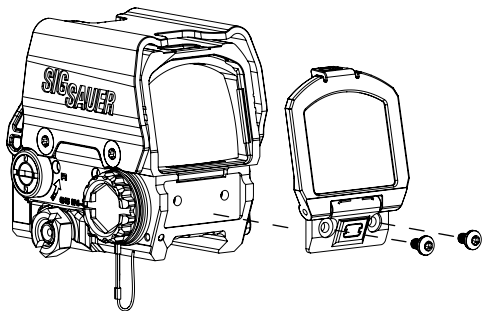

OCULAR (“REAR”) ACCESSORIES

Select models can include an ocular flip-back to help protect the rear window.

Opening the Ocular Flip-Back

Un-clip from the top of the main housing, rotate the flip-back and press down until locked into detent.

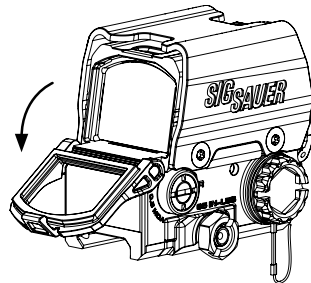

Removing the Ocular Flip-Back

The rear flip-back is designed to be “torn away” in case of an obstruction or other emergency. To remove the rear flip-back, simply unclip the locking tab from the main housing, twist and pull one side away. Installation is the reverse.

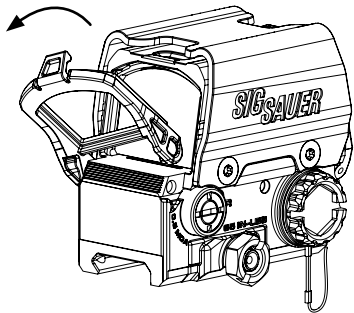

TITANIUM SHROUD

Lightweight, high performance protective shroud comes installed from the factory¹.

Shroud Removal

To remove the shroud, use the provided T10 drive bit with Optic Multi-tool to remove the (4) mounting screws then, pull the shroud off the optic. Stow the screws and shroud for later use.

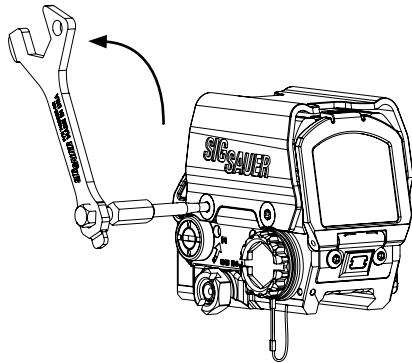

¹ Included on select SKU's

Shroud Installation

CAUTION

AVOID OVER TORQUING THE SCREWS TO PREVENT PERMANENT DAMAGE

To install the shroud, use the provided T10 drive bit to torque the (4) mounting screws to 8-10 in-lbf in a crisscross pattern.

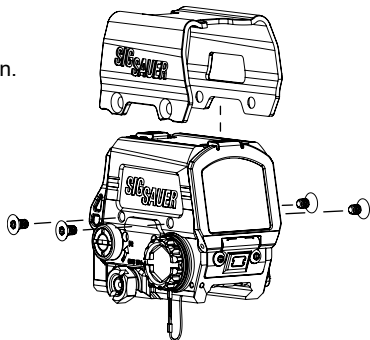

MAINTENANCE



WARNING

UNLOAD/CLEAR



BEFORE WORKING ON THE ROMEO8T-AMR SIGHT, ENSURE THE FIREARM IS UNLOADED AND CLEAR WITH THE SAFETY ON AND POINTED IN A SAFE DIRECTION. FAILURE TO COMPLY COULD RESULT IN SERIOUS INJURY OR DEATH.

CAUTION

ALWAYS BLOW DUST OR DEBRIS FROM THE LENSES PRIOR TO USING ANY CLOTH OR LENS PEN. FAILURE TO DO THIS MAY RESULT IN SCRATCHING OF THE LENSES.

- Cleaning – Keep the front glass lens and rear glass window clear by using a clean, soft lens cloth. To avoid scratches in the surface of the lens coatings, be sure to remove any brass particles, dirt, dust, or carbon buildup from the glass before wiping the surface. Use compressed air to blow away debris and a cotton swab lightly soaked in Isopropyl Alcohol to remove carbon. Install and close provided lens protection accessories during storage and transport.
- Replacing the battery – See page 11 of this manual.

TROUBLESHOOTING

POI Changes between groups when shooting from a single set distance

- Check that the half-inch nut is tightened to 65 in-lbf.
- Check for variations in the ammunition brand, bullet weight, and velocity specs.
- Check/clean the firearm.

Reticle not illuminated

- Ensure the battery is installed properly (+ facing in).
- Make sure the battery cap is fully tightened against the housing.
- Press and hold [NV] button until reticle appears (Page 12). Do this up to (2) times.
- If the reticle is still not present, install a fresh CR123 battery (Page 11), and power the sight on by long pressing [NV] button.



WARNING: CANCER AND REPRODUCTIVE HARM—www.P65warnings.ca.gov

AMR doesn't work

Ensure the red dot is AMR compatible.

- Ensure the Magnifier or Magnifier Mount is AMR compatible.
- Ensure the AMR is enabled or perform a Factory Reset (Page 14-15).

AMR is not working consistently

- Ensure the magnifier is mounted within 3 slots behind the red dot.
- Ensure the facing surfaces of the red dot, magnifier and magnifier mount are unobstructed and free of debris.

Low Battery

- When Powering On or Powering Off and the battery voltage reaches 2.2vdc or lower, the reticle will animate by scrolling through 3 reticle brightness settings, 3 times. This is intended to alert the end user without being disruptive.
- Solution: Replace the CR123 battery with a fresh battery at the next opportunity.

SPECIFICATIONS	
MAGNIFICATION	1X
OBJECTIVE LENS	40 mm
RETICLE	Quad Ballistic Circle Dot 2.0
RETICLE OPTIMIZATION	AMR™
SIGHT HEIGHT	1.41 inch absolute co-witness
ILLUMINATION SETTINGS	15 [12 DAY + 3 NV]
BATTERY	CR123
RUNTIME	50,000 hrs
TOTAL TRAVEL	100 MOA
ADJUSTMENT	0.5 MOA per click
WATERPROOF	IPX8
MIL-STD	810

WITHOUT A SHROUD EQUIPPED		
MEASUREMENTS	IMPERIAL	METRIC
[A] LENGTH	2.9 in	72.5 mm
[B] HEIGHT	2.4 in	60.7 mm
[C] WIDTH	1.9 in	49.5 mm
WEIGHT	9.5 oz	268 g

SHROUD EQUIPPED		
MEASUREMENTS	IMPERIAL	METRIC
[A] LENGTH	2.9 in	72.5 mm
[B] HEIGHT	2.6 in	65 mm
[C] WIDTH	2.0 in	51 mm
WEIGHT	11.3 oz	319 g

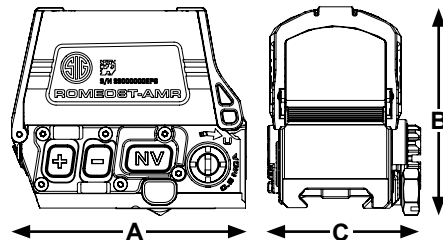



SIG SAUER® INFINITE GUARANTEE™

- Fully Transferable
- No Warranty Card Required
- No Receipt Required
- No Time Limit Applies
- No Charge

SIG SAUER® has a history of quality and reliability that dates back more than 250 years. We understand the importance of true dependability whether it be in the line of duty, at the shooting range or on your next hunt and we continually strive to deliver products that meet and exceed the expectations of even the most demanding customers. That's why SIG SAUER is proud to offer our INFINITE GUARANTEE* on all our firearms, optics, and suppressors.

Our promise: We warrant that your new SIG SAUER firearm, optic, or suppressor was originally manufactured free of defects in material, workmanship, electrical, optical, and mechanical function. We will repair your SIG SAUER product in the event it becomes damaged or is defective in any way, at no charge to you. If we cannot repair your product, we will replace it or, if we cannot replace it, we will provide you with a replacement of equal value. All with no questions asked, forever.

Please note that our Infinite Guarantee excludes coverage for intentional damage, misuse, cosmetic damage that does not affect the performance of the optic, loss, theft, or unauthorized repair or modification. Excludes Tritium components.

Customers seeking warranty coverage must first obtain a Return Merchandise Authorization (RMA) by contacting SIG SAUER Customer Service and return the product unloaded and freight prepaid.

ANY WARRANTIES IMPLIED BY LAW, INCLUDING ANY IMPLIED WARRANTIES OF MERCHANTABILITY OR FITNESS FOR A PARTICULAR PURPOSE, ARE EXPRESSLY LIMITED IN DURATION TO THE DURATION OF THIS WRITTEN WARRANTY PERIOD. REPAIR, ALTERATION, OR REPLACEMENT AS PROVIDED HEREIN IS YOUR EXCLUSIVE REMEDY FOR ANY DEFECTIVE PRODUCT. IN NO EVENT SHALL SIG SAUER OR ANY COMPANY AFFILIATED WITH SIG SAUER BE LIABLE FOR ANY SPECIAL, INCIDENTAL, OR CONSEQUENTIAL DAMAGES OF ANY KIND ARISING OUT OF THE PURCHASE OR USE OF THIS PRODUCT, WHETHER BASED UPON CONTRACT, TORT, STATUTE, OR OTHERWISE. Some states do not allow the limitation of implied warranties, or the exclusion or limitation of incidental or consequential damages, so some or all of the above limitations or exclusions may not apply to you. This warranty gives you specific legal rights, and you may also have other rights which vary from State to State.

This warranty applies to commercial customers only and does not apply to government, non-commercial, or non-US customers. Non-US COMMERCIAL CUSTOMERS MUST PURCHASE PRODUCT THROUGH AN AUTHORIZED SIG SAUER DEALER WITHIN THEIR COUNTRY OF RESIDENCE FOR THIS WARRANTY TO APPLY.



**FOR PRODUCT SERVICE ON THIS MODEL,
PLEASE CALL (603) 610-3000**

12100 SW Tualatin Rd, Tualatin, OR 97062 USA

All trademarks, service marks, trade names, trade dress, product names, and logos appearing in this manual are the property of their respective owners. No trademark or service mark appearing in this manual may be used without written consent of the mark's owner.