

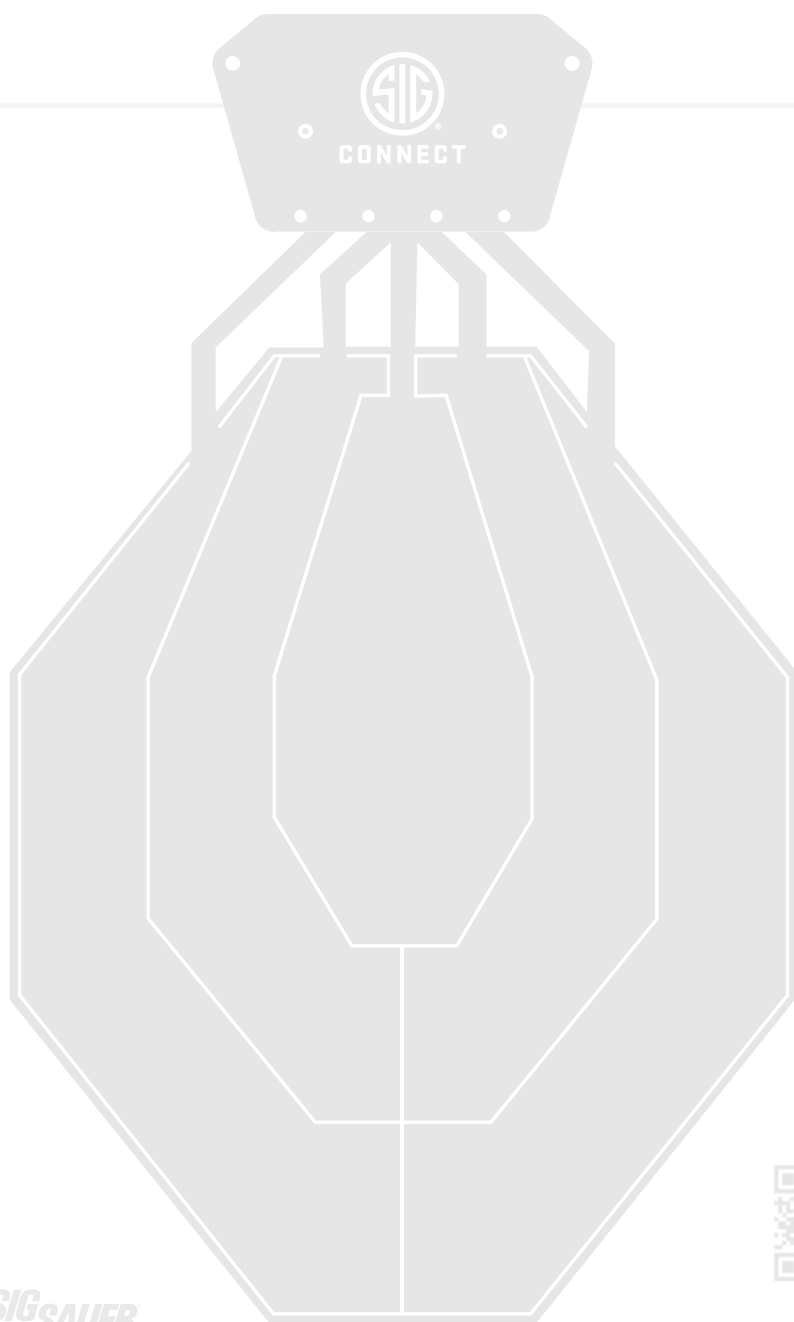

**CONNECT™**



**T300 Smart Target System**



**SIGSAUER**

[www.sigsauer.com](http://www.sigsauer.com)



Powered By:  **TRAINSHOT**

## SIG CONNECT™ T300 Smart Target System

This contains safety, handling, disposal, recycling, and regulatory information for the SIG CONNECT Smart Target System.



### WARNING

**PLEASE READ AND FOLLOW ALL SAFETY INFORMATION AND OPERATING INSTRUCTIONS BEFORE USING THE SIG CONNECT APPLICATION AND SMART TARGET SYSTEM TO AVOID INJURY OR HARM. ALSO READ AND FOLLOW ALL SAFETY INFORMATION AND OPERATING INSTRUCTIONS FOR ANY FIREARMS OR OTHER PRODUCTS YOU INTEND TO USE IN CONJUNCTION WITH SIG CONNECT AND/OR THE SMART TARGET SYSTEM. SIG SAUER DOES NOT TAKE ANY RESPONSIBILITY FOR ANY DAMAGE, INJURY OR DEATH CAUSED BY THE USAGE OF THE SIG CONNECT SMART TARGET SYSTEM. IT IS THE USER'S RESPONSIBILITY FOR PROPER USE OF THE SIG CONNECT SMART TARGET SYSTEM.**



### WARNING PHYSICAL INJURY/DAMAGE



**DO NOT SHOOT THE SMART TARGET CONTROL MODULE. SHOOTING THE FRONT STEEL PLATE WILL VOID YOUR WARRANTY FOR DAMAGE CAUSED BY BULLET IMPACTS. BULLET HITS TO THE CONTROL MODULE CAN CAUSE INJURY OR DAMAGE TO YOUR ENVIRONMENT. THE CONTROL MODULE WITH CONDUCTIVE TARGET MUST BE PLACED IN A SAFE AND APPROVED SHOOTING AREA.**

## GENERAL INFORMATION

The SIG CONNECT Smart Target System requires use of the SIG CONNECT Mobile App in order to fully utilize the system. The Smart Target System is an intelligent, electronic scoring system with the ability to detect which zone of the target was hit. A detected hit is sent in real-time to the SIG CONNECT Mobile App on your smartphone or tablet via Bluetooth connection. The Smart Target Control Module can register up to 5 unique zones on the Conductive Target. SIG CONNECT can track hits, individual reaction times, as well as split times between multiple hits. The SIG CONNECT Smart Target system is a sport and training accessory meant for use with commercially sold firearms and ammunition.

## PACKAGE CONTENTS



1x electronic unit



1x hex wrench



1x buckle



2x wing nuts



1x paracord

DEVICE DESCRIPTION

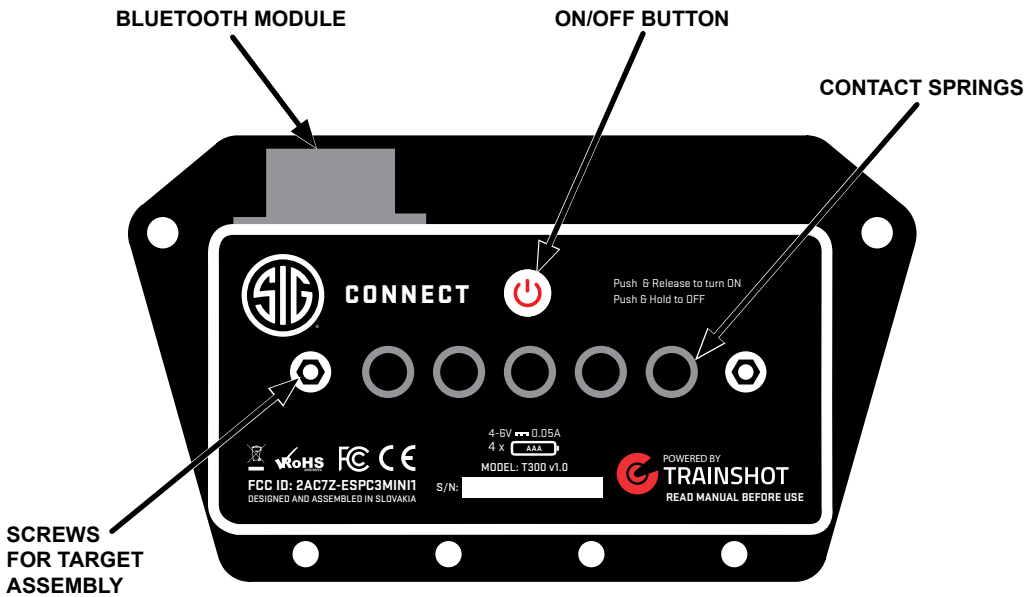
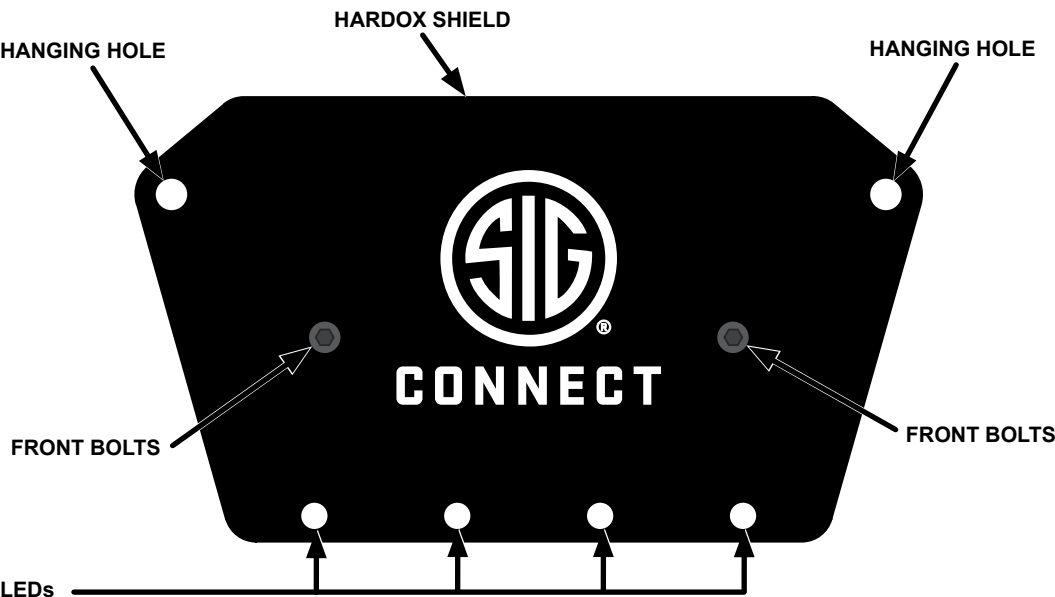



# WARNING

**SIGSAUER**

WARNING: CANCER AND REPRODUCTIVE HARM—[www.P65warnings.ca.gov](http://www.P65warnings.ca.gov)



DISCHARGING FIREARMS IN POORLY VENTILATED AREAS, CLEANING FIREARMS, OR HANDLING AMMUNITION MAY RESULT IN EXPOSURE TO LEAD AND OTHER SUBSTANCES KNOWN TO THE STATE OF CALIFORNIA TO CAUSE BIRTH DEFECTS, REPRODUCTIVE HARM, AND OTHER SERIOUS PHYSICAL INJURY. MAINTAIN ADEQUATE VENTILATION AT ALL TIMES. WASH HANDS THOROUGHLY AFTER EXPOSURE. SHOOTING OR CLEANING FIREARMS MAY EXPOSE YOU TO LEAD.

## SAFETY PRECAUTIONS

- **ALWAYS** follow all instructions and safety warnings provided with firearms and other products used with the Smart Target System
- **ALWAYS** ensure the target is only used in a safe, properly equipped range area
- **ALWAYS** wear hearing protection and wrap-around shatter resistant eye protection.
- **ALWAYS** follow safety precautions for safe gun handling.
- **ALWAYS** treat every firearm as if it were loaded.
- **ALWAYS** keep the firearm on safe until you intend to fire.
- **ALWAYS** keep your finger straight and off the trigger until you are ready to fire.
- **ALWAYS** inspect the target for damage, functionality, stability, etc., before using.
- **ALWAYS** stand at least 10 meters (10 yards) from the target when training.
- **ALWAYS** check for what is near and what is beyond the target.
- **ALWAYS** use genuine SIG CONNECT Conductive Targets.
- **NEVER** shoot the T300 Smart Target Control Module.
- **NEVER** use a Smart Target Control Module that is deformed or damaged in any way.
- **ALWAYS** ensure the T300 is tipped forward or slightly downward facing, not to exceed a 20-degrees.
- **NEVER** attempt to hang and send the system downrange before checking with a range officer. Ideal usage is at your own, outdoor range where the system can be secured in a stationary position.

## SETTING UP SIG CONNECT AND THE SMART TARGET SYSTEM

### ATTACHING A CONDUCTIVE TARGET TO THE CONTROL MODULE

1. Remove the battery insulation tab from the side of the Control Module.
2. Unscrew both wing nuts and remove the steel buckle on the back side of Control Module.
3. Attach Conductive Target to the Control Module through both holes in the top of the target. All springs MUST touch each black line on the FRONT of the target.
4. Install the steel buckle on the bolts and screw both wing nuts hand tight onto the Control Module (The buckle attaches to the BACK of the target).

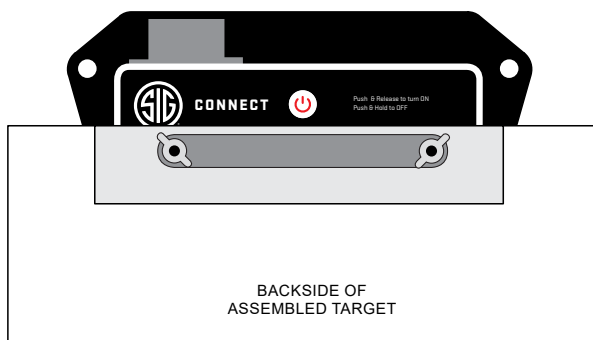

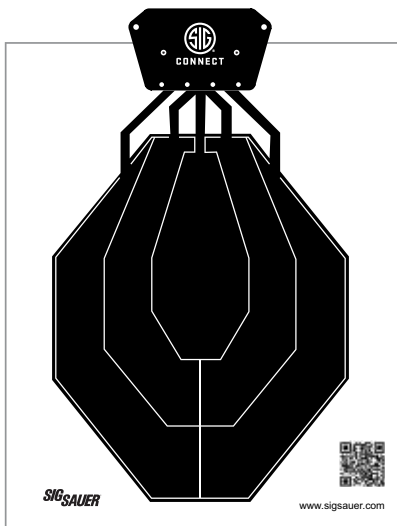

← **ASSEMBLED SIG CONNECT  
SMART TARGET**

5. Download SIG Connect to your mobile device from the Google Play™ Store or Apple® App Store® (Search for SIG Connect) or visit [www.sigsauer.com/connect](http://www.sigsauer.com/connect).
6. Create your SIGID account and log in.
7. Turn on the Control Module by using the provided allen key or other small tool to press and release the recessed power button located on the rear of the unit.
8. Open the SIG CONNECT App on your mobile device and make sure that Bluetooth is on, and all permissions are enabled.
9. Navigate to the Smart Target section and select "Connect T300" and select your device from the list of found devices. Once connected, the button on the screen will turn green and the module LEDs will flash.



## PLACING SMART TARGET SYSTEM ON THE SHOOTING RANGE

The Control Module must be suspended or hang freely using the included paracord (zip ties, wire or other durable connection means may also be used). Do not attach the Control Module directly (with bolts, screws) on any non-movable surfaces such as walls, trees, poles, etc. Do not use the Smart Target System in a wet or rainy environment as this can cause the system to malfunction. The Control Module is NOT waterproof.

### Recommended attachment methods:

1. Suspend or hang the Control Module from the paracord (run from the back and knotted on the face of the module) or cable attached to a stable support or crossbeam.
2. Attach the Conductive Target with at least 2 strong clamps on each side of the target to a stable, free standing wooden frame.
3. Staple or clamp Conductive Targets to a commonly used carboard target surface; multiple strong staples or clamps must be used due to the weight of the Control Module being attached at the top of the Conductive Target.

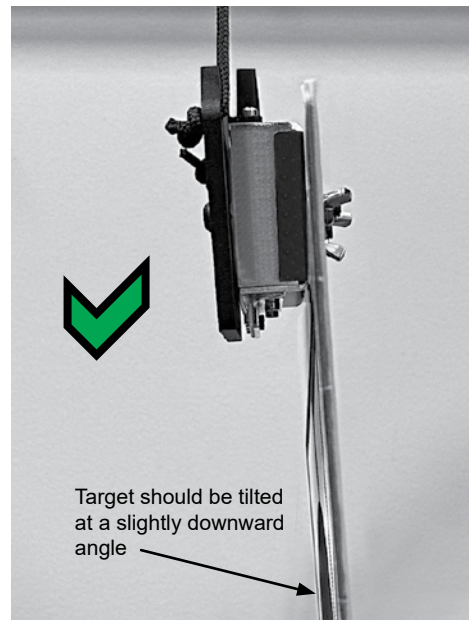
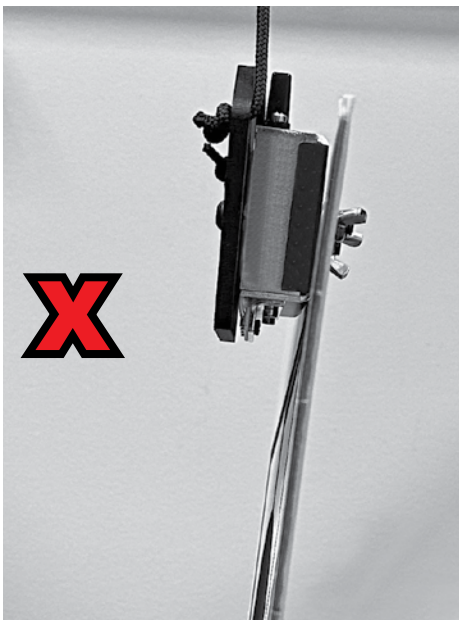
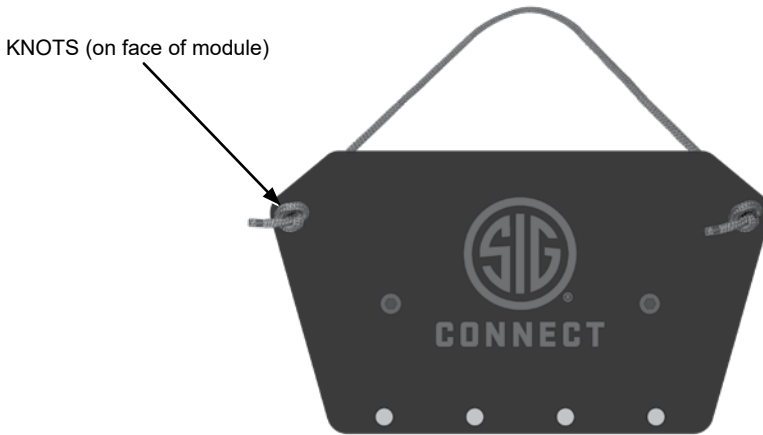

ABOUT THE SIG CONNECT CONDUCTIVE TARGETS

The Conductive Targets are made of cardboard and special conductive layers which detect bullets passing through a targeted zone. Avoid using in a damp or rainy environment.

BULLETS TO USE

The SIG CONNECT Smart Target System can detect only metal bullets. Do not use bullets with coatings, hollow point bullets, flat point bullets or bullets shorter than 4 mm in length (0.15 inch).

Recommended bullet types



Caliber	DETECTION RELIABILITY
9 mm Luger	99.99%
7.62 x 39 mm	99.99%
.45 ACP	99.99%
.22 LR	85%
.223	85%

Bullet types NOT recommended



NOT RECOMMENDED
Plastic Coated Bullets
Teflon Coated Bullets
Painted Bullets
Flat Nose Bullets
Bullets shorter than 4 mm in length
Plastic BB's



## CONDUCTIVE TARGET MALFUNCTION – PERSISTENT SHORT CIRCUIT

On rare occasion it is possible for the two conductive layers of the target to make permanent contact. If you suspect this has occurred causing issues with hit detection, use a small thin object like a pen to push a hole completely through the target. This should remove the short circuit.

## LOW BATTERY / BATTERY REPLACEMENT

The SIG CONNECT Smart Target Control Module will automatically turn off when batteries are too low to sustain proper operation. The provided batteries may have a shorter run time. Please use reputable alkaline batteries for best results.

### To replace the batteries:

1. Unscrew the two bolts located on the front of the Control Module with included hex key.
2. Remove the front shield.
3. Replace all AAA batteries.
4. Put the front shield back and fasten the bolts tightly.

## PRODUCT MAINTENANCE

### Before every use:

1. Ensure that the two hex bolts on the face of the unit and the two wingnuts retaining the target are hand tight and snug.
2. Check if target is wet or bent.

### After every use:

1. Do not leave dead batteries in the Control Module.
2. Check for any type of damage.

### After bullet strike on Control Module:

1. Check for damage on LEDs.
2. Check if all wingnuts and bolts are fastened tightly.
3. Check for damage of Bluetooth module / antenna.

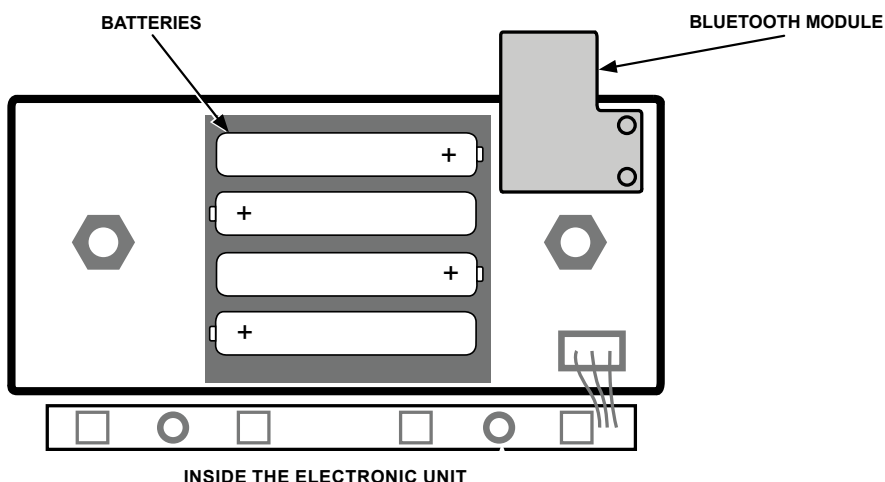

## FAQ

**Q:** Can I use the T300 at any range?

**A:** It is recommended to always check with your range and range officers before using the T300 smart target system. Due to the weight of the system, we recommend NEVER attempting to hang and send the system downrange before checking with a range officer. Ideal usage is at your own, outdoor range where the system can be secured in a stationary position. Always be sure to mount and hang the T300 smart target system at a slightly downward angle for the safest angle of engagement for the user.

**Q:** Can I shoot the T300 metal module?

**A:** You should NEVER shoot the T300 metal module because of the damage it can cause to the unit and the environment where it is placed. Shooting the T300 metal module will void the warranty. SIG SAUER, Inc. is not liable for any damage caused by unauthorized use of or shooting of the T300 module.

**Q:** What is the maximum range of the T300 Control Module using Bluetooth?

**A:** The range varies from 10 to 100 meters (32 - 320 feet) depending on environment, mobile device used and its orientation.

**Q:** The Control Module turns off a few seconds after powering on.

**A:** Batteries may be depleted. Replace batteries. See Battery replacement instructions above.

**Q:** Where can I ask technical questions?

**A:** Check the FAQ section of SIG CONNECT App or email [sigconnect@sigsauger.com](mailto:sigconnect@sigsauger.com)

## TRADEMARKS

SIG CONNECT™, T300, and the SIG CONNECT logo are trademarks of SIG SAUER, Inc.

Trainshot and the Trainshot logo are trademarks of Trainshot Ltd.

Android™ and Google Play™ are trademarks of Google LLC. The Android robot is reproduced or modified from work created and shared by Google and used according to terms described in the Creative Commons 3.0 Attribution License.

Apple® and App Store® are registered trademarks of Apple Inc.

The Bluetooth® word mark and logos are registered trademarks owned by Bluetooth SIG, Inc. and any use of such marks by SIG SAUER, Inc is under license.

Other trademarks and trade names are those of their respective owners.

## T300 SMART TARGET CONTROL MODULE LIMITED WARRANTY

SIG SAUER warrants that the enclosed T300 product was originally manufactured free of defects in material, workmanship, and mechanical function. For ninety (90) days from date of purchase, SIG SAUER agrees to correct any defect in the product for the original purchaser by repair, adjustment, or replacement, at SIG SAUER's option, with the same or comparable quality components (or by replacing the product at SIG SAUER's option); provided however that a Return Merchandise Authorization (RMA) is first obtained by contacting SIG SAUER Customer Service, and that the product is returned freight prepaid to SIG SAUER at 18 Industrial Drive, Exeter, NH, 03833.

Proof of purchase will be required with any request for warranty repair. This limited warranty is null and void if the product has been misused, damaged (by accident or otherwise), struck by live ammunition, damaged through failure to provide reasonable and necessary maintenance as described in the manual accompanying the product, or if unauthorized repair or any alteration, including of a cosmetic nature, has been performed on the product. This limited warranty does not apply to normal wear and tear of any parts.

Subject to the foregoing, this limited warranty confers the right to have the covered product or its parts repaired, adjusted, or replaced exclusively upon the original purchaser, which right is not transferable to any other person.

ANY WARRANTIES IMPLIED BY LAW, INCLUDING ANY IMPLIED WARRANTIES OF MERCHANTABILITY OR FITNESS FOR A PARTICULAR PURPOSE, ARE EXPRESSLY DISCLAIMED. REPAIR, ALTERATION, OR REPLACEMENT AS PROVIDED HEREIN IS YOUR EXCLUSIVE REMEDY FOR ANY DEFECTIVE PRODUCT. IN NO EVENT SHALL SIG SAUER OR ANY COMPANY AFFILIATED WITH SIG SAUER BE LIABLE FOR ANY SPECIAL, INCIDENTAL, OR CONSEQUENTIAL DAMAGES OF ANY KIND ARISING OUT OF THE PURCHASE OR USE OF THIS PRODUCT, WHETHER BASED UPON CONTRACT, TORT, STATUTE, OR OTHERWISE. Some states do not allow the exclusion or limitation of implied warranties, or the exclusion or

10

limitation of incidental or consequential damages, so some or all of the above limitations or exclusions may not apply to you. This warranty gives you specific legal rights, and you may also have other rights which vary from State to State.

This warranty applies to U.S. commercial customers only, and does not apply to government, military, law enforcement, or non-US customers. Non-US customers should contact their local dealer or distributor for applicable warranty coverage.

## **WEEE**

This symbol on the product or on its packaging indicates that this product must not be disposed of with your other household waste. Instead, it is your responsibility to dispose of your waste equipment by handing it over to a designated collection point for the recycling of waste electrical and electronic equipment. The separate collection and recycling of your waste equipment at the time of disposal will help to conserve natural resources and ensure that it is recycled in a manner that protects human health and the environment. For more information about where you can drop off your waste equipment for recycling, please contact your local city office, your household waste disposal service, or the shop where you purchased the product.

## **BLUETOOTH**

SIG CONNECT T300 Module is connected to a smartphone via Bluetooth. The operating range of most devices is 30 meters (90 feet). The operating range of Bluetooth depends on the device and the method / orientation of holding the device.

## **FCC**

Contains: FCC ID: 2AB6YHM-1011

This device complies with Part 15 of the FCC Rules Sub-Part B and C and also with Canada ICES-003 and RSS-Gen. Operation is subject to the following two conditions: (1) this device may not cause harmful interference, and (2) this device must accept any interference received, including interference that may cause undesired operation. This equipment has been tested and found to comply with the limits for a Class B and C digital service, pursuant to Part 15 of the FCC Rules. These limits are designed to provide reasonable protection against harmful interference in a residential installation. This equipment generates, uses, and can radiate radio frequency energy and, if not installed and used in accordance with the instructions, may cause harmful interference to radio communications. However, there is no guarantee that interference will not occur in a particular installation. If this equipment does cause harmful interference to radio or television reception, which can be determined by turning the equipment off and on, the user is encouraged to try to correct the interference by one or more of the following measures:

- Reorient or relocate the receiving antenna.
- Increase the separation between the equipment and receiver.
- Connect the equipment into an outlet on a circuit different from that to which the receiver is connected.
- Consult the dealer or an experienced radio/TV technician for help.

**Frequency range:** 2402.00 - 2480.00 MHz

**Channel number:** 40

**Channel spacing:** 2MHz

**RF output power EIRP:**

2402.00 MHz - 1.54 dBm

2440.00 MHz - 1.26 dBm

2480.0 - 1.32 dBm

## **MANUFACTURER**

Trainshot s.r.o. Keltska 69,  
Bratislava  
Slovak Republic



**[sigsauer.com](https://sigsauer.com)**

**SIG SAUER, Inc.  
72 Pease Boulevard, Newington, NH 03801 USA**

All trademarks, service marks, trade names, trade dress, product names and logos appearing in this manual are the property of their respective owners. No trademark or service mark appearing in this manual may be used without written consent of the mark's owner.